

32-110 Removing and installing rear shock absorber

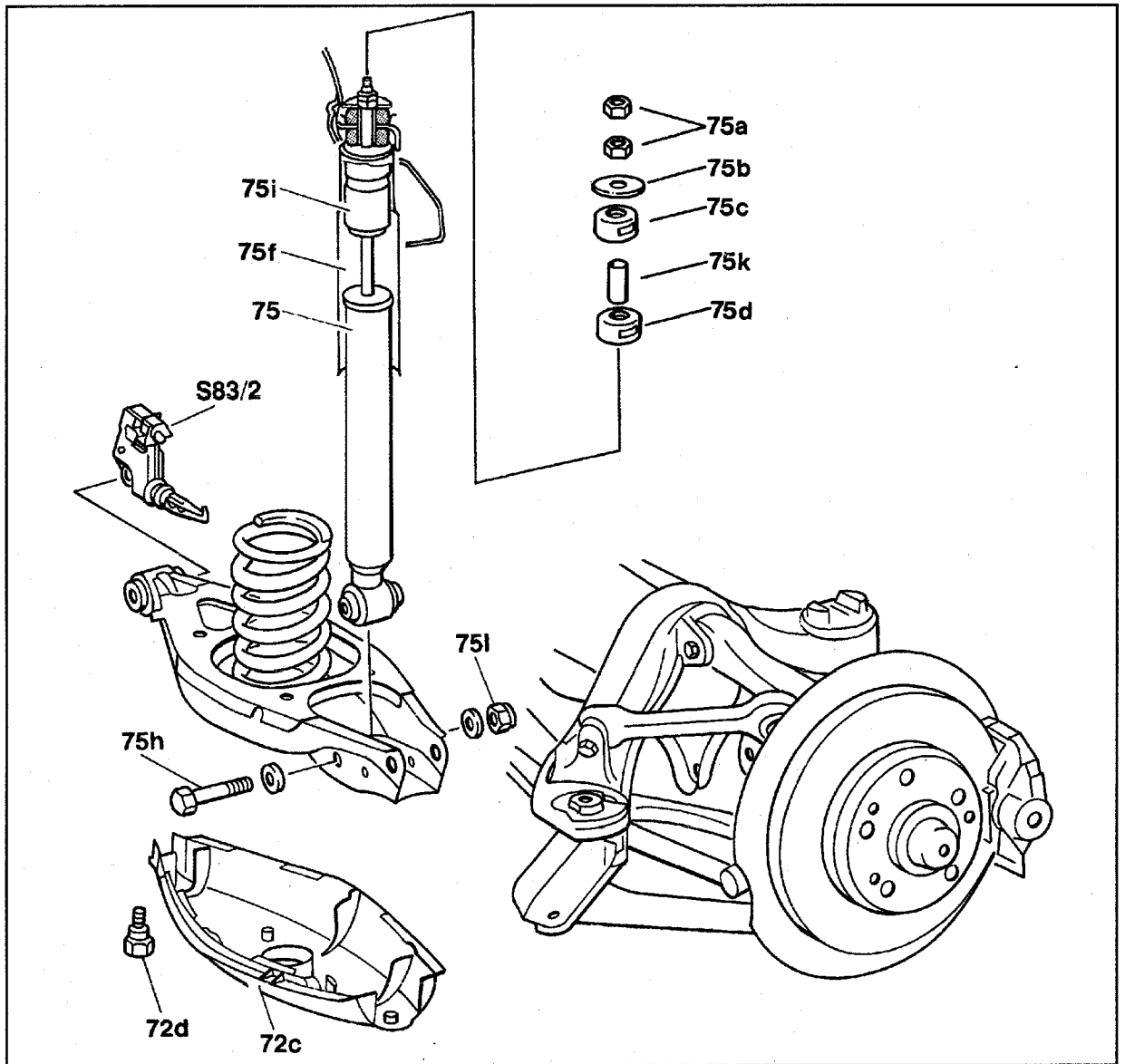

P32-5241-59A

Trunk paneling

remove, install (68-480)



The vehicle must be standing on the wheels or the spring link supported. When the hex. nuts (75a) are loosened the piston rod should not turn.

32.0701-110/1

Hex. nuts (75a) for top mount

unscrew, screw on.

Remove washer (75b) and rubber mount (75c), reinstall.

When installing the bottom hex. nut (75a) tighten to 15-18 Nm, then counter with top hex. nut (75a) by tightening to 30 Nm.

Use socket wrench 202 589 00 09 00 (items 2 and 4).

Ensure that rubber mount (75c) and washer (75b) are seated properly.

Model 124.06 (convertible)

Rear axle switches for rollover bar (S83/2 and S83/3)

remove, install (observe items 8 and 16).

All models

Vehicle

hoist, set down.

Bolts (72d)

unscrew, screw in. Remove spring link cover (72c), install.

Self-locking hex. nuts (75l)

unscrew, replace, 55 Nm, remove hex. head bolt and washer (75h), install.

Shock absorber (75)

remove, install, where applicable remove protective sleeve (75f), rubber mount (75d), spacer sleeve (75k) and stop buffer (75i), reinstall (item 12).

Special tools

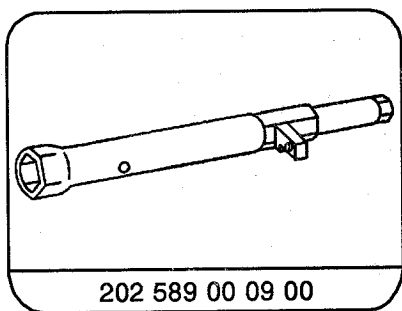

Note

The rear shock absorbers simultaneously serve as the rebound stop for the rear wheels. For this reason only loosen the shock absorber mounts when the vehicle is standing on the wheels, the spring link is supported or the spring compressor is installed. When repairing the shock absorbers can be replaced separately regardless of the brand. It is only necessary to ensure that the color code coincides, e.g. one red longitudinal stripe or two red longitudinal stripes.



When removing the shock absorber with the vehicle lifted and load removed from the half axle ensure that the shock absorber tube does not turn when loosening the upper mount. Since the rebound stop is in contact with the operating piston in the shock absorber in this state, the mount for the operating piston could loosen together with the piston rod. The gas pressure would cause the piston rod to extend suddenly and the oil in the shock to squirt out (**accident hazard**).

Removal

All models except model 124.06 (convertible)

- 1 Remove trunk paneling.
- 2 Unscrew hex. nuts (75a) for upper mount, remove washer (75b) and rubber ring (75c).

Note

If the shock absorber tube (version up to 11/86) turns when screwing out the hex. nut, hold with hand in wheelhouse. On shock absorber version as of 12/86 hold piston rod with 7 mm open end wrench while screwing off nut. To loosen counter-nut use flat open end wrench (17 mm), grind down to 5 mm thickness, if necessary.

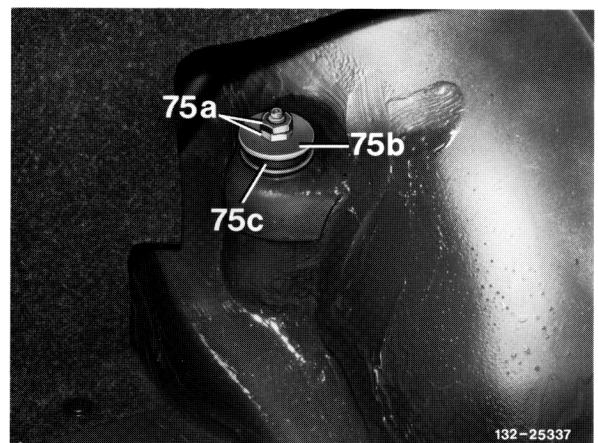

Model 124.06 (convertible)

- 3 Remove paneling in soft top compartment.
- 4 Unscrew hex. nuts (75a) in assembly opening, remove washer (75b) and rubber ring (75c).

Use socket wrench 202 589 00 09 00 and hold piston rod.

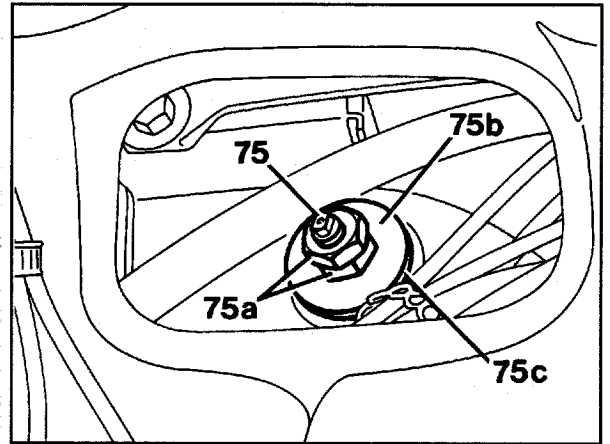

P32-5535-13

All models except model 124.06 (convertible)

- 5 Lift vehicle at rear axle (40-9008).
- 6 Unscrew hex. head bolts for spring link cover and remove cover.
- 7 Loosen hex. nut for bottom mount on spring link (arrow) and remove hex. head bolt.

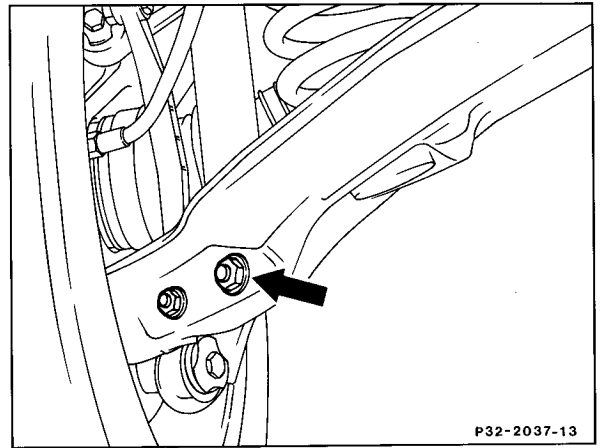

P32-2037-13

Model 124.06 (convertible)

- 8 Remove rear axle switches for rollover bar (S83/2 and S83/3) (91-860).
- 9 Unscrew hex. head bolts for spring link cover and remove cover.
- 10 Loosen hex. nut for bottom mount on spring link and remove hex. head bolt.

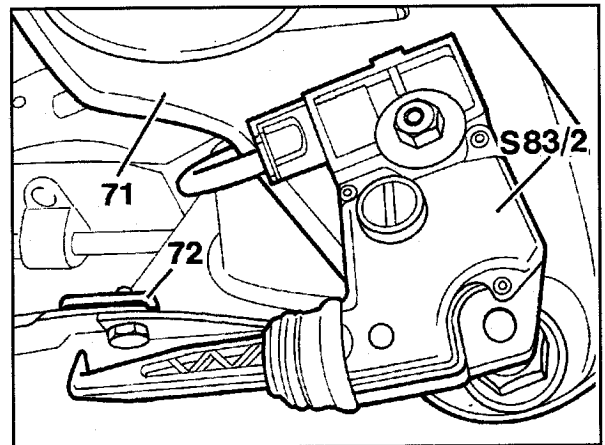

P32-2034-13

All models

- 11 Press shock absorber downward out of mounting hole in frame floor, remove shock absorber from spring link and remove downward.

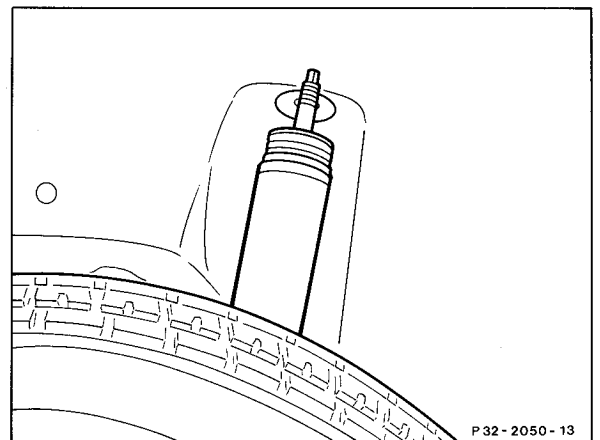

P32-2050-13

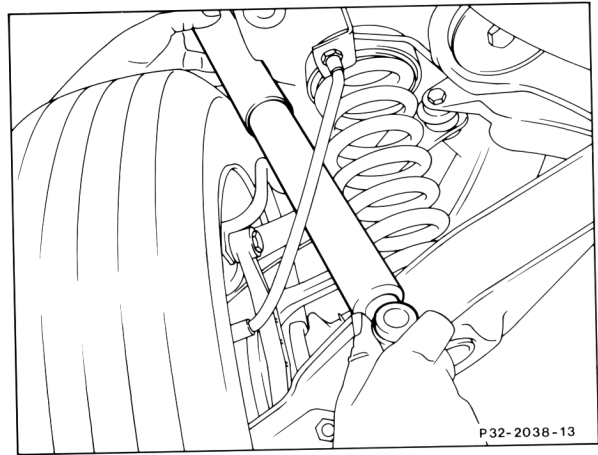

Installation

12 Check suspension parts.

Version up to 11/86

- 75 Shock absorber
- 75a Hex. nuts
- 75b Washer
- 75c Top rubber mount
- 75d Bottom rubber mount
- 75h Hex. head bolt with washers and self-locking nut

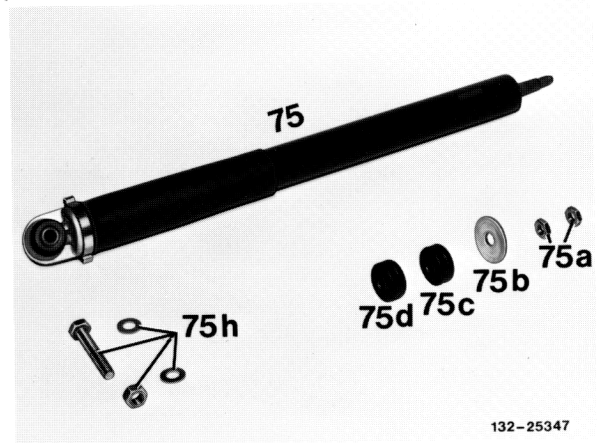

Version as of 12/86

- 75 Shock absorber
- 75a Hex. nuts
- 75b Washer
- 75c Top rubber mount
- 75d Bottom rubber mount
- 75f Rubber protective sleeve
- 75i Stop buffer
- 75k Spacer sleeve

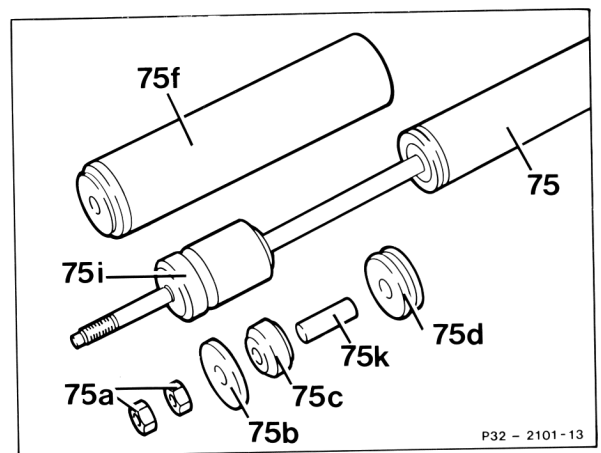

13 Position rubber mount (75d) on shock absorber.

14 Insert shock absorber and install bottom mount. Tightening torque for self-locking hex. nut 55 Nm.

Installation note

Replace self-locking hex. nut.

- 72 Spring link
- 75 Shock absorber
- 75h Hex. head bolt with washers and self-locking nut

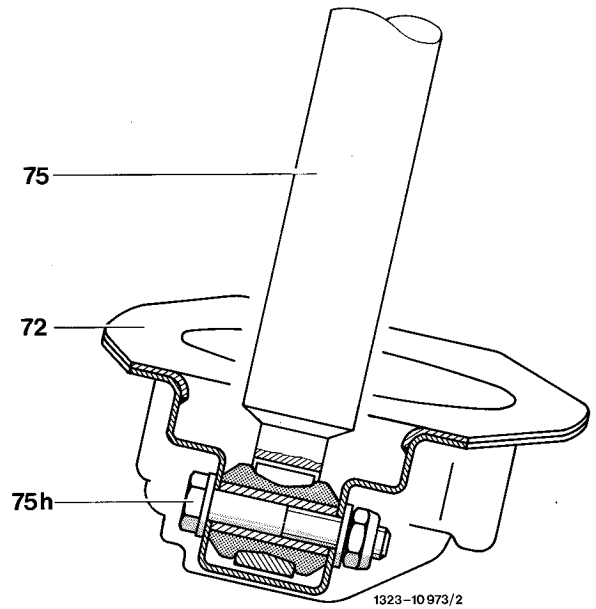

15 Fasten spring link cover (arrows).

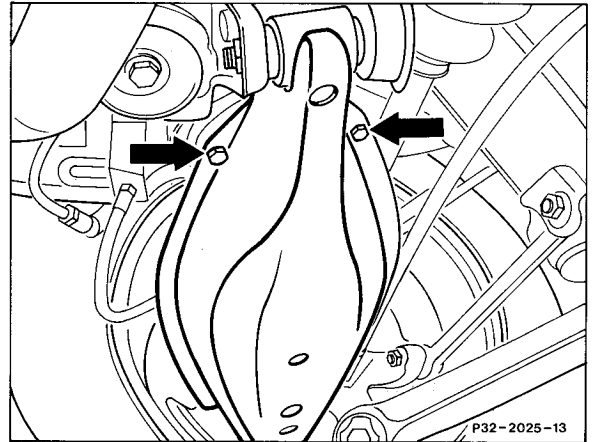

Model 124.06 (convertible)

16 Install rear axle switches for rollover bar (S83/2 and S83/3) (91-860). Replace self-locking hex. nut.

All models

17 Lower vehicle.

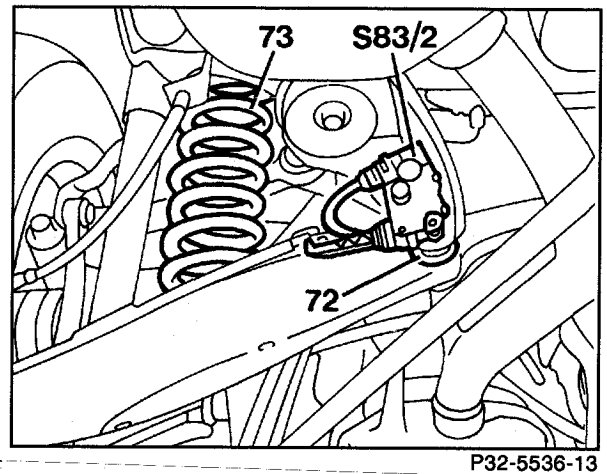

18. Assemble top mount, ensuring that round side of bottom rubber mount (75d) points toward frame floor. Tighten bottom hex. nuts to 15-18 Nm then counter with top nut. Tightening torque 30 Nm.

Ensure that rubber mount (75c) and washer (75b) are seated properly.

- Version up to 11/86
- 75 Shock absorber
 - 75a Hex. nuts
 - 75b Washer
 - 75c Top rubber mount
 - 75d Bottom rubber mount
 - 76 Frame floor

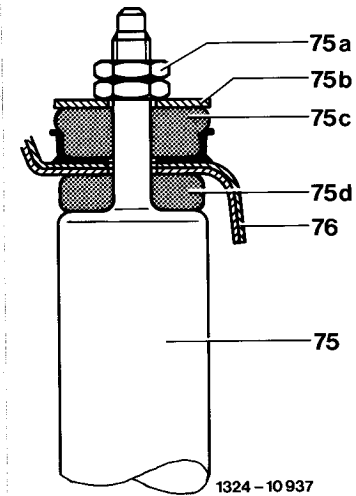

1324 - 10937

- Version as of 12/86
- 75 Shock absorber
 - 75a Hex. nuts
 - 75b Washer
 - 75c Top rubber mount
 - 75d Bottom rubber mount
 - 75f Rubber protective sleeve
 - 75i Stop buffer
 - 75k Spacer sleeve

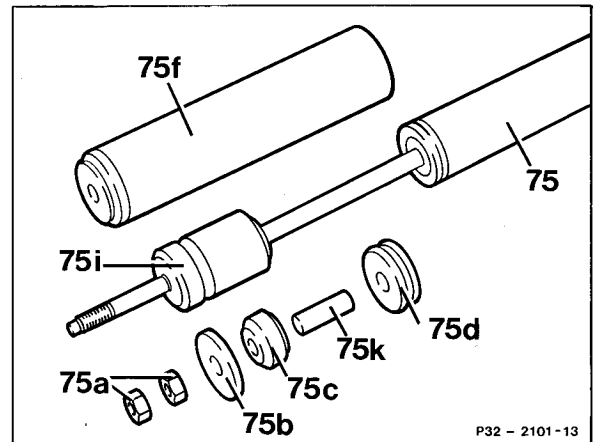

P32 - 2101 - 13

Repair note

Use socket wrench 202 589 00 09 00 and hold piston rod.

Model 124.06 (convertible): Assembly opening in soft top box

029 Socket wrench

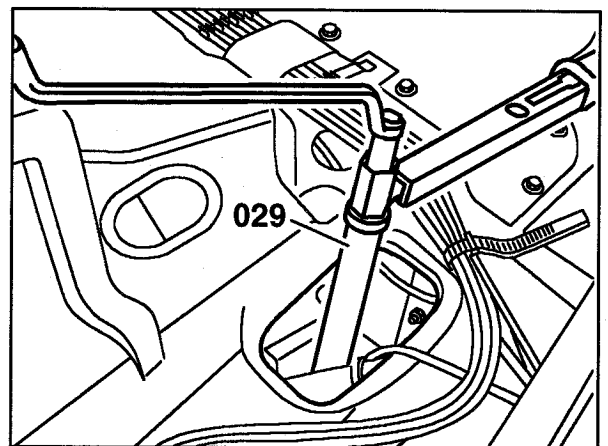

P32.25-0231-13

19 Install trunk paneling (on model 124.06, convertible, paneling in soft top box).

Version up to 11/86

- 71 Rear axle bracket
- 72 Spring link
- 73 Rear spring
- 74 Rubber mount, rear spring
- 75 Shock absorber
- 76 Dome on frame floor
- 77 Torsion bar
- 78 Connecting rod for torsion bar
- 95 Stop buffer

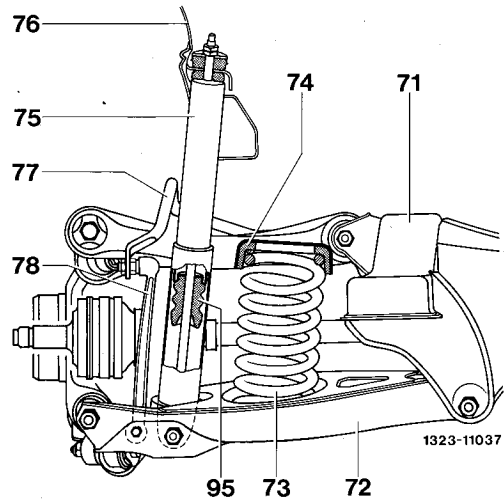

Version as of 12/86

- 71 Rear axle bracket
- 72 Spring link
- 73 Rear spring
- 74 Rubber mount, rear spring
- 75 Shock absorber
- 75i Stop buffer
- 76 Dome on frame floor
- 77 Torsion bar
- 78 Connecting rod for torsion bar

