



H5	AR03.30-P-5000HA	Installing, removing retaining lock for crankshaft/starter ring gear	27.7.94
-----------	------------------	---	----------------

ENGINE 111, 605, 606 in MODEL 124

ENGINE 606.961 in MODEL 140

ENGINE 111.977 in MODEL 163

ENGINE 111 in MODEL 170, 208

ENGINE 111, 604, 605 in MODEL 202

ENGINE 111, 602.982, 604, 605, 606.912 /962 in MODEL 210

ENGINE 602.983 in MODEL 461

ENGINE 606.964 in MODEL 463



Retaining lock at oil pan

- 1 Bolts of oil sump M6×85
- 2 End cover
- 4 Bolts M6×90
- 3  Retaining lock

 The end cover (2) on engine 602.983 is bolted on.

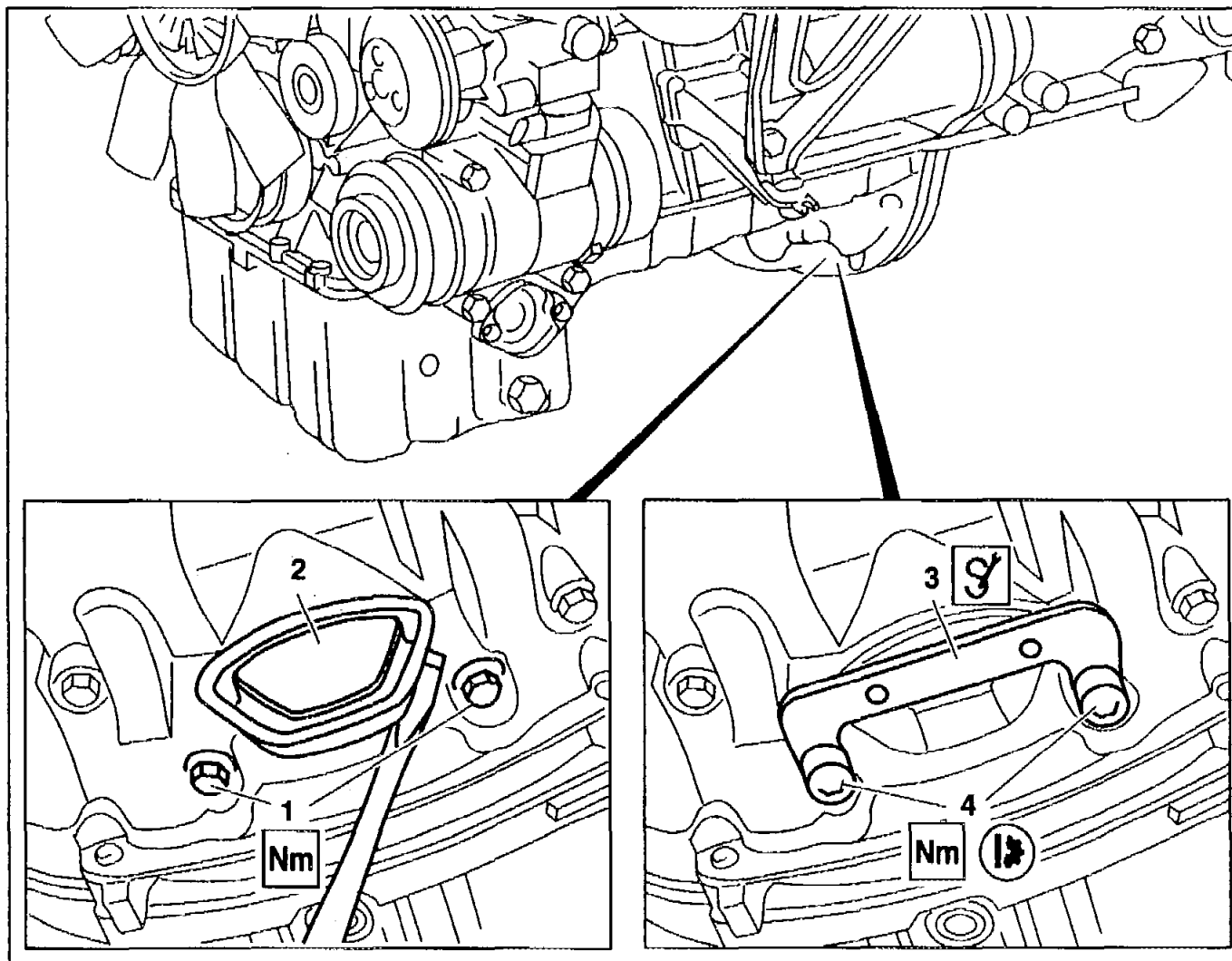

Retaining lock at starter opening

- 5  Retaining lock

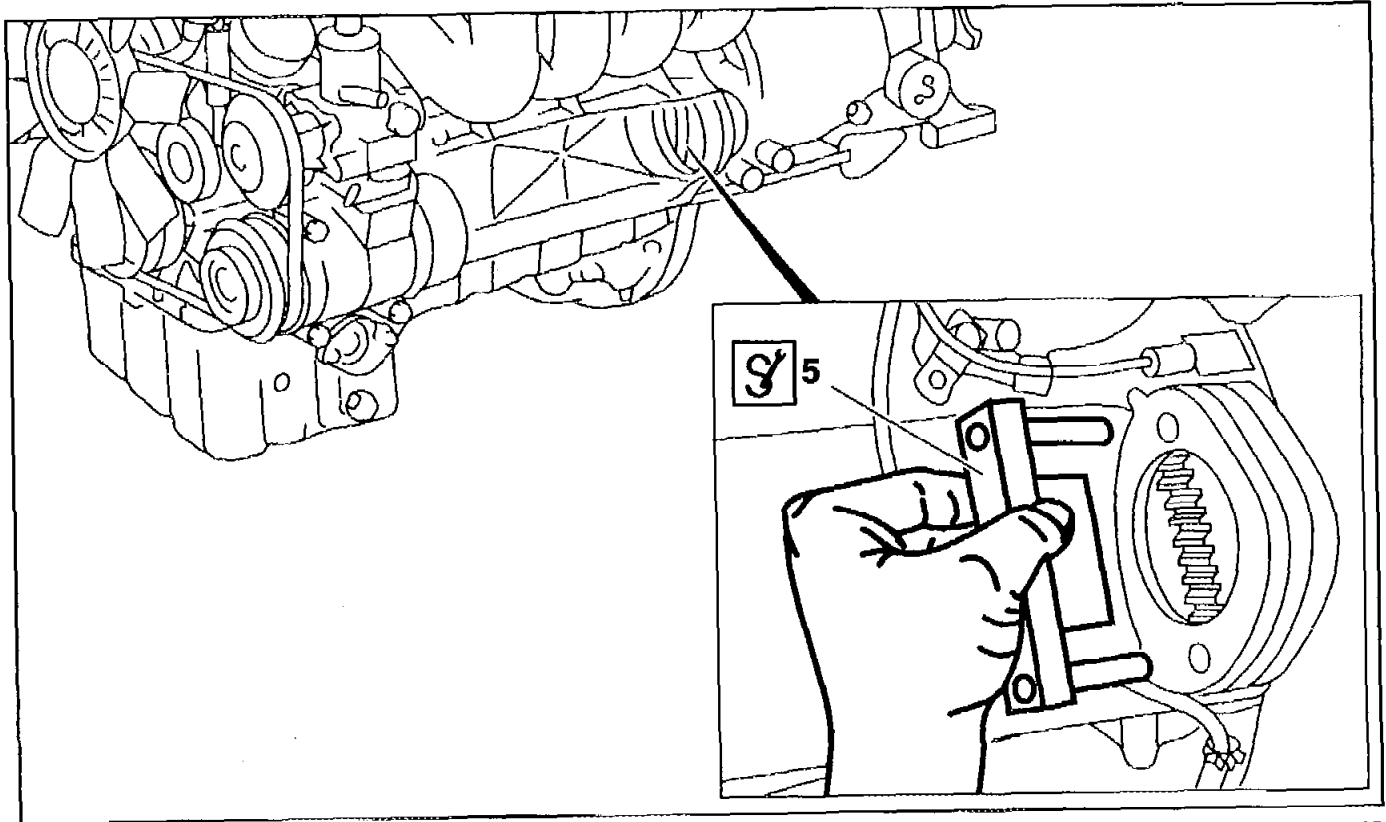



Retaining lock at transmission bell housing with oil sump removed and transmission attached

6  Retaining lock

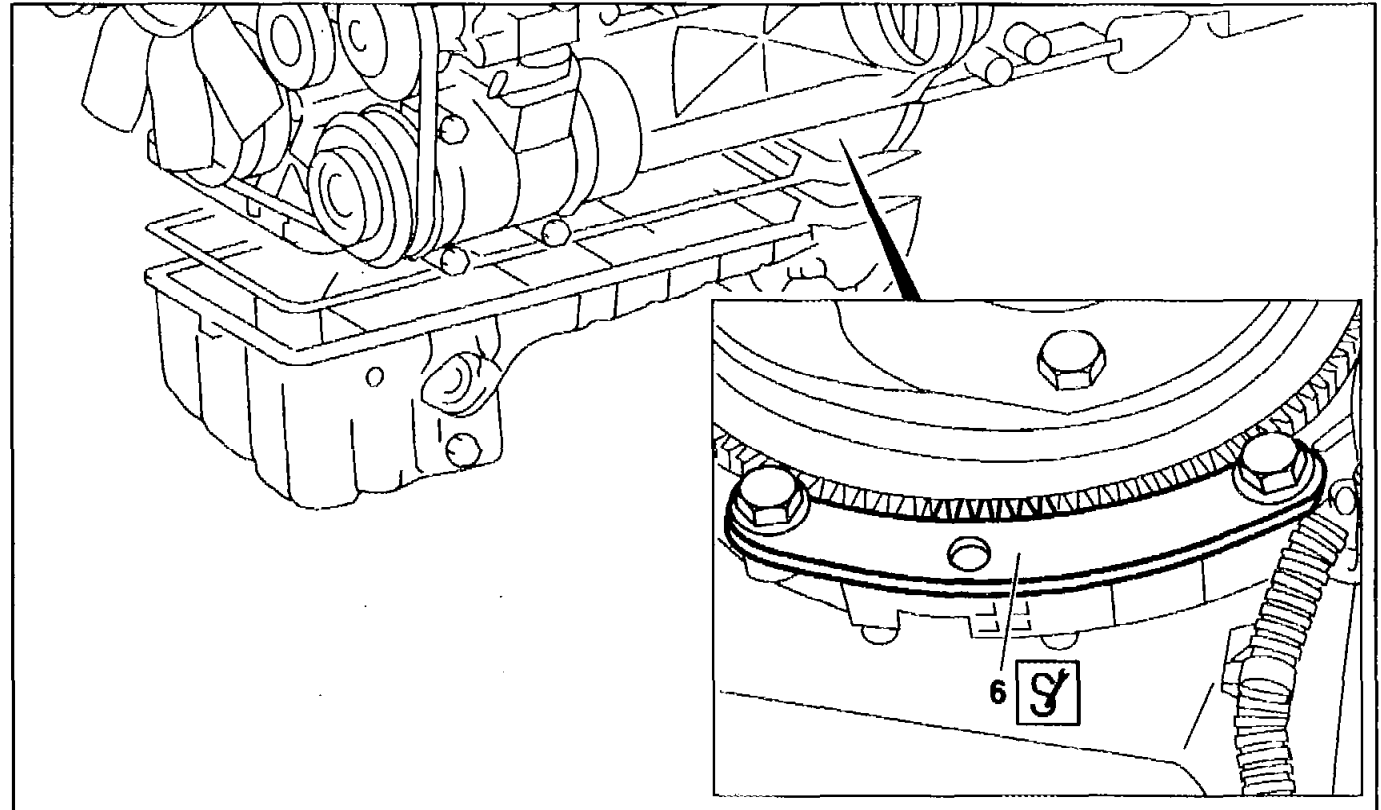

P03.30-0226-05

Fig. item, etc.	Work instructions		
	Bottom noise encapsulation	Remove, model 124 with engine 605, 606 Model 140.1 Model 202 with engine 604, 605, 606 Model 210 with engine 602.982,604, 605, 606	WH Band2-9490 RA94-5305 AR94.30-P-5300A AR94.30-P-5300AB

3	Retaining lock	<p>Allow to engage in ring gear, bolt to oil sump.</p> <p>Ⓜ Use M6×90 bolt (4) otherwise the threads in the rear end cover will be damaged.</p> <p>Rotate engine at crankshaft, if necessary.</p> <p>Pay attention to tightening torque.</p> <p>Ⓜ</p> <p>Nm Engine 602.982/983</p> <p>Nm Engine 111, 604, 605, 606</p>	<p>601 589 02 40 00</p> <p>BA01.45-N-1001-01A</p> <p>BA01.45-P-1001-01A</p>
5	Retaining lock	<p>Model 140.1</p> <p>Insert into starter opening and allow to engage in ring gear, with starter removed.</p> <p>Rotate engine at crankshaft, if necessary.</p> <p>Ⓜ</p>	<p>RA94-5305</p> <p>602 589 00 40 00</p>
6	Retaining lock	<p>Allow to engage in ring gear, bolt on to transmission bell housing, with oil sump removed.</p> <p>Rotate engine at crankshaft, if necessary.</p> <p>Ⓜ</p> <p>Nm Engine 602.982/983</p> <p>Nm Engine 111, 604, 605, 606</p>	<p>102 589 01 40 00</p> <p>BA01.45-N-1002-01A</p> <p>BA01.45-P-1002-01A</p>

**Nm** Oil pan

Number	Designation			Engine 604, 605, 606	Engine 111
BA01.45-P-1001-01A	Bolt of oil pan to crankcase	M6	Nm	10	10
		M8	Nm	25	25
		M10	Nm	-	-
BA01.45-P-1002-01A	Bolt of transmission bell to oil pan		Nm	40	40

Nm Oil pan

Number	Designation			Engine 602.982
BA01.45-N-1001-01A	Bolt of oil pan to crankcase	M6	Nm	10
		M8	Nm	25
		M10	Nm	-
BA01.45-N-1002-01A	Bolt of transmission bell to oil pan		Nm	40



Nm Oil pan

Number	Designation	Engine 601, 602 except 602.982, 603 except 603.913/963		
BA01.45-P-1001-01A	Bolt of oil pan to crankcase	M6	Nm	10
		M8	Nm	25
		M10	Nm	40
BA01.45-P-1002-01A	Bolt of transmission bell to oil pan	Nm		-

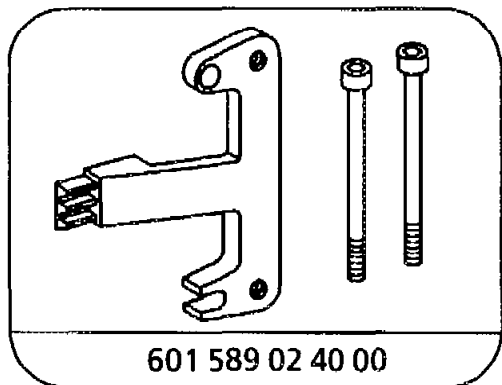

Retaining lock

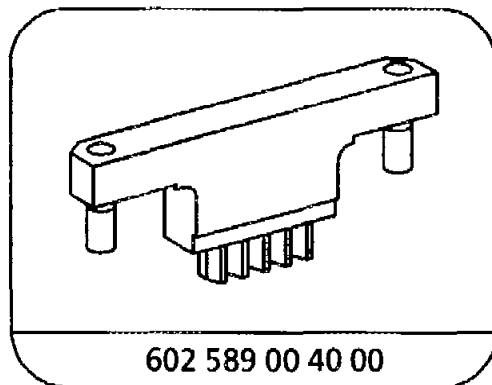

Retaining lock

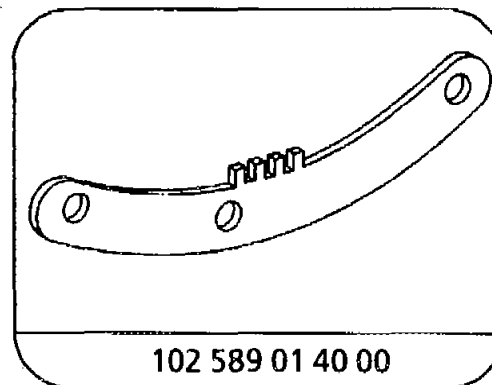

Retaining lock