

B3



AR03.20-P-3063HA

Replacing rear crankshaft radial seal

2.4.93

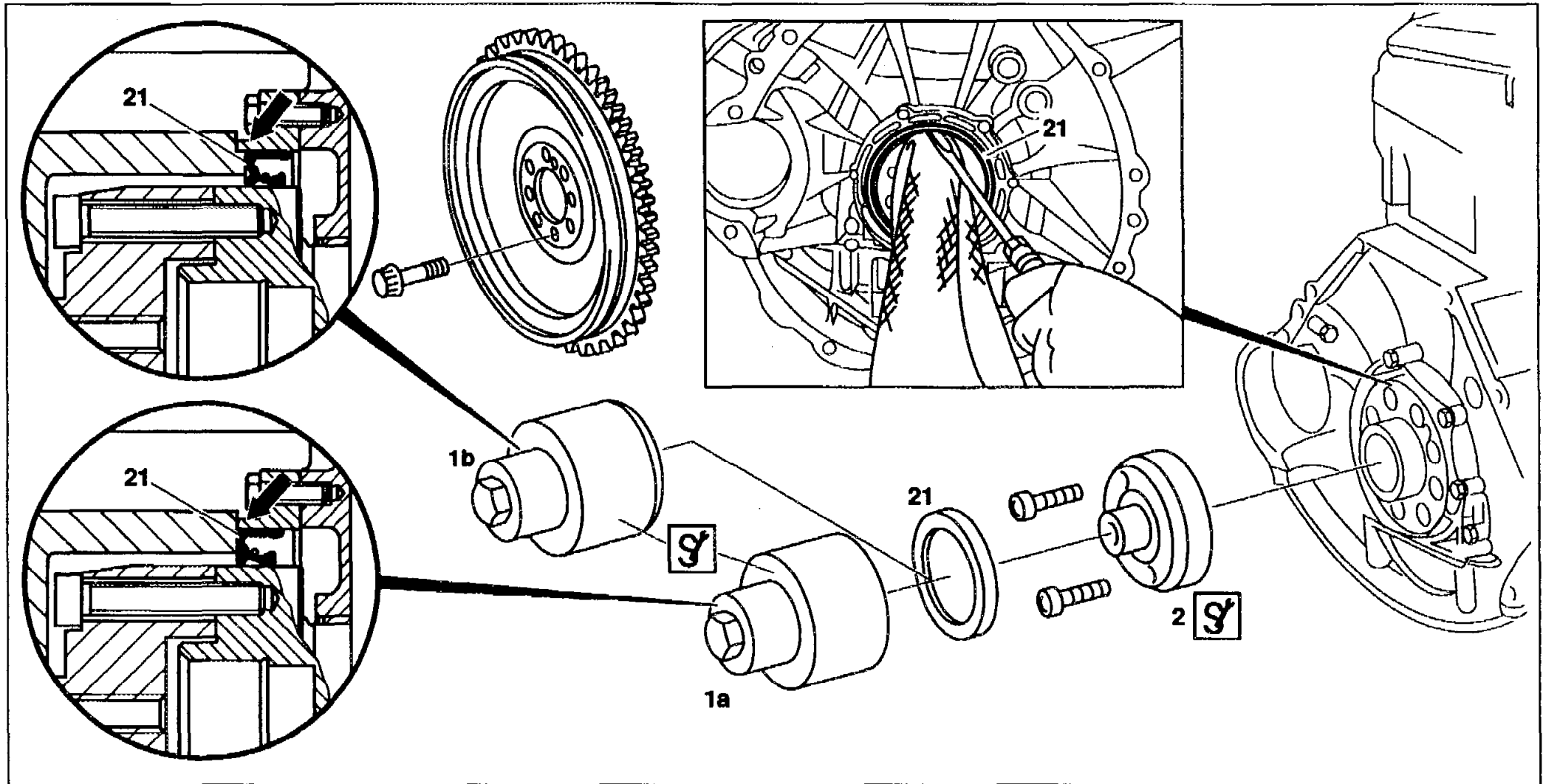
ENGINE 111, 602.982 /983, 604, 605, 606





- 1a  Insertion tool (standard size)
- 1b  Insertion tool (repair size, radial seal is pressed in a further 2 mm)

- 2  Inner part of insertion tool
- 21 Radial seal

Modification notes

1.6.95	Technical modification: Interference-fit seal replaced by vulcanized seal in end cover.	Operation 5	AR03.20-3063HA
--------	---	-------------	----------------

 	Removal, installation		
1.1	Remove manual transmission		AR26.10-P-0020A
1.2	Remove automatic transmission	Model 140, 202, 210	AR27.10-P-0500A
		Model 461 Model 463	AR27.10-P-0500G AR27.10-P-0500BD
2.1	Remove clutch	Manual transmission	AR25.10-P-0050A
3	Remove flywheel, two-mass flywheel or driven plate	Engine 111 Engine 602.982/983, 604, 605, 606	AR03.30-P-8001A AR03.30-P-8001HA P5
4	Check for oil leaks	If leaks exist at end cover ↓ Remove end cover If the cause of the oil leak cannot be clearly determined ↓ Check rear of engine for external oil leak, determine	AR01.40-P-8913HA AR01.40-P-8913-01HA F15



<p>5</p> <p> BT</p>	<p>Use a screwdriver to prise out radial seal (21)</p> <p>End cover with vulcanized radial seal</p>	<p> Do not damage crankshaft and mounting bore for the radial seal; use a clean rag as a base</p> <p> Installation: for repairs if vulcanized radial seal fitted: press new radial seal (21) into new cover at rear, install.</p> <p> Installation: install rear crankshaft radial seal</p>	<p>BT01.40-P-0001-01A M17</p> <p>AR03.20-P-3063-01A H15</p>
<p>6</p>	<p>Installation in the reverse order</p>	<p> Before installing the transmission, check for oil leaks ↓</p> <p>Check rear of engine for external oil leak, determine</p>	<p>AR01.40-P-8913-01HA F15</p>

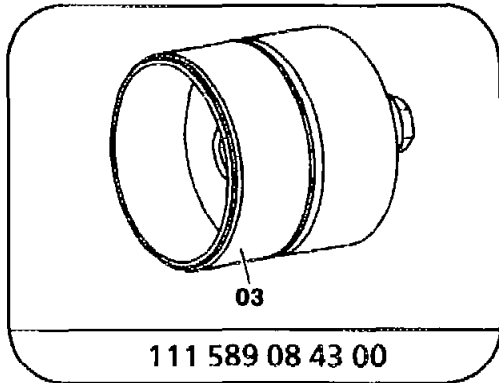

Insertion tool

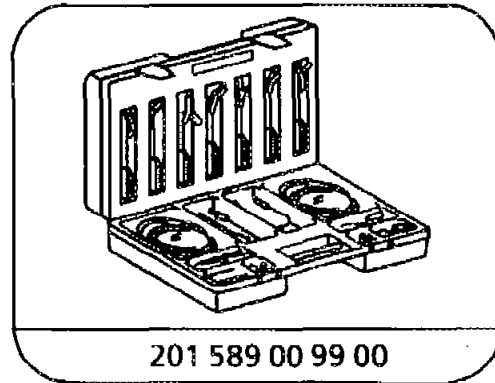

Electrical connection set