



<b>A1</b>	AR03.00-P-1101HA	<b>Checking, correcting setting of bracket of TDC sensor</b>	<b>2.4.93</b>
-----------	------------------	--	---------------

**ENGINE 605, 606 in MODEL 124**

**ENGINE 606.961 in MODEL 140**

**ENGINE 604, 605 in MODEL 202**

**ENGINE 604, 605, 606.912 /962 in MODEL 210**

**ENGINE 606.964 in MODEL 463**

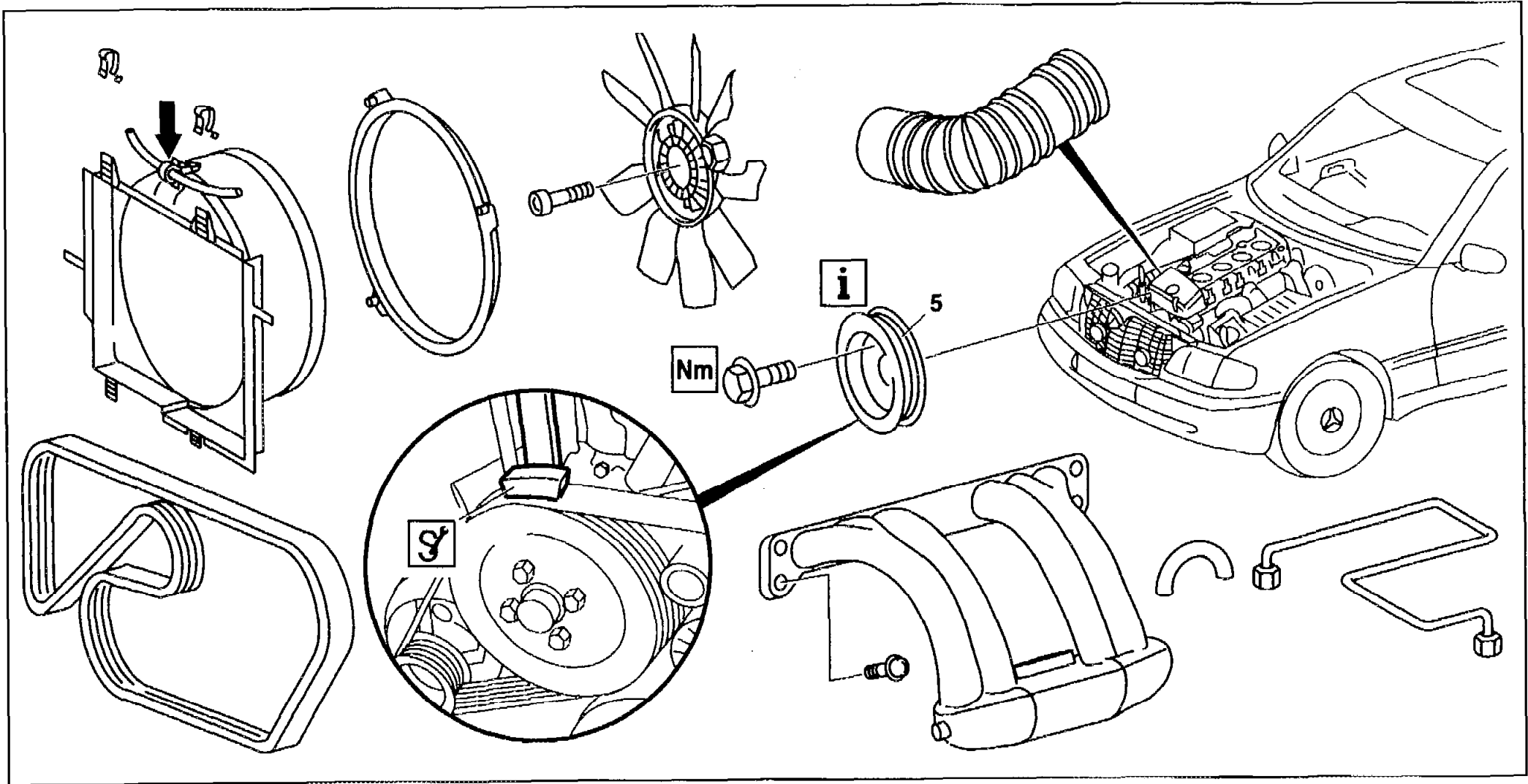



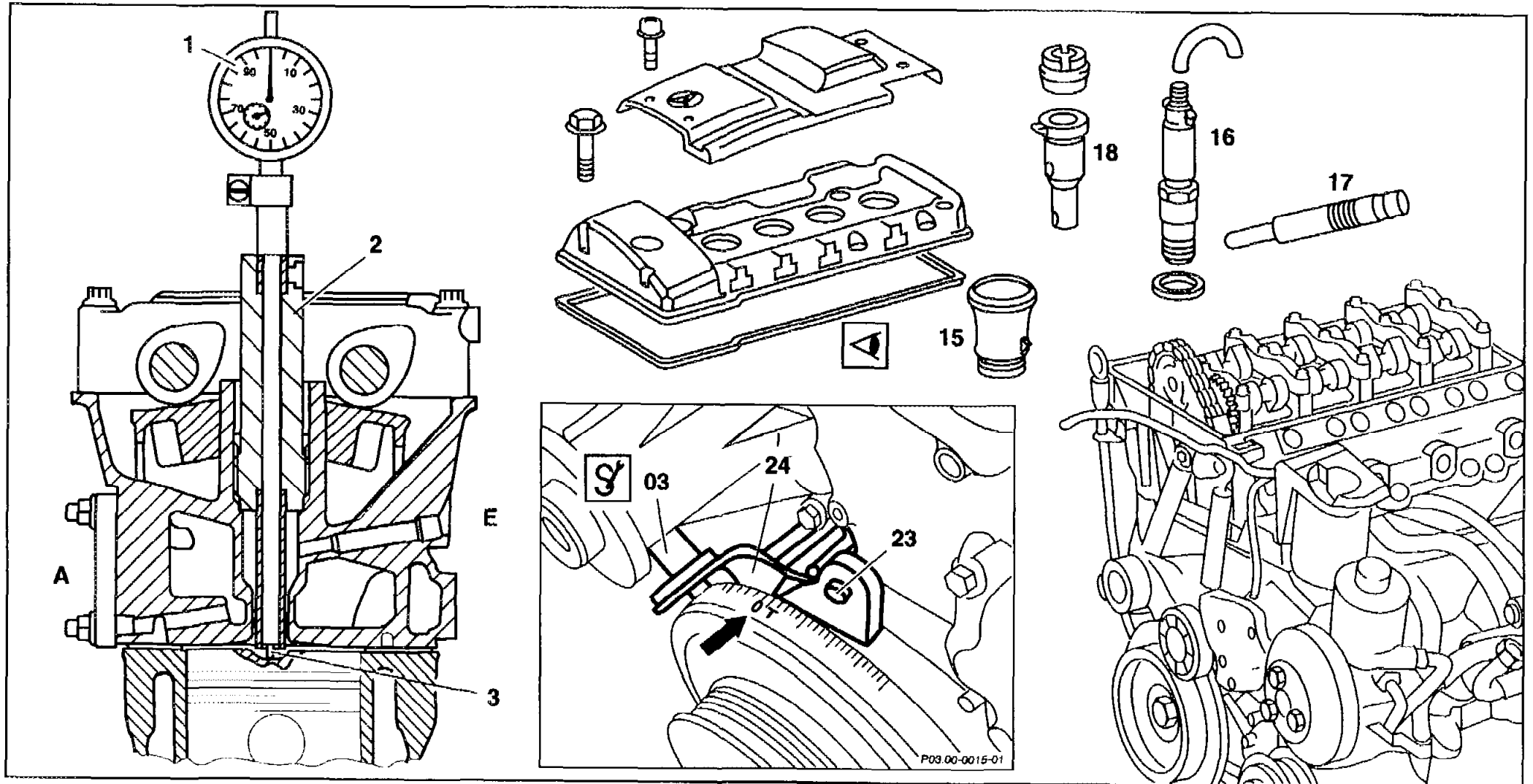

P03.00-0208-09



Shown on model 202



03	 Fixing pin	16	Injection nozzle, cylinder 1
1	Dial gauge	17	Glow plug, cylinder 1
2	Dial gauge holder	18	Prechamber, cylinder 1
3	Tracer pin	23	M6×13 hexagon socket bolt
5	Coolant pump belt pulley	24	Bracket of TDC sensor
15	Shaft cover bush, cylinder 1		

Fig. item, etc.	Work instructions		
 5	Belt pulley of coolant pump	In order to slacken the bolts, fit on the poly V-belt at the belt pulley of coolant pump and attach counter-holder 	603 589 00 40 00
			BA20.10-P-1001-01A
15	Bush of shaft cover, cylinder 1	If necessary, crank engine at crankshaft to remove.  Installation: replace O-rings.	
16	Remove injection nozzle at cylinder 1		AR07.03-P-6830H
17	Remove glow plug at cylinder 1		AR15.20-P-4111H
18	Remove prechamber at cylinder 1		AR01.30-P-5402HA
24	Check position of bracket of TDC sensor, correct		AR03.00-P-1101-03HA <b>G14</b>
			001 589 53 21 00



		 	601 589 07 21 00 603 589 01 21 00
--	--	--	--------------------------------------

**Bracket of TDC sensor**

Number	Designation	Engine 604	Engine 605, 606
BE03.00-P-1001-01A	Piston stroke at 20° ATDC (setting position of bracket of TDC sensor)	mm 3.35	3.23

** Coolant pump, coolant thermostat**

Number	Designation	Engine 604, 605, 606
BA20.10-P-1001-01A	Belt pulley to coolant pump	Nm 10

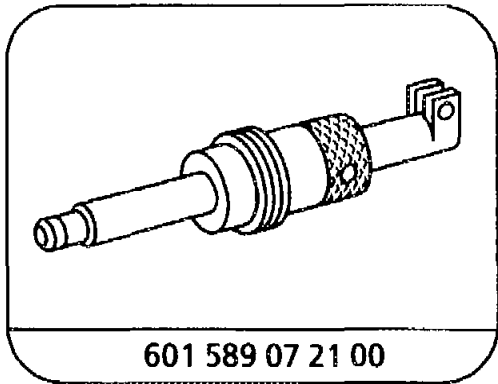

Dial gauge holder

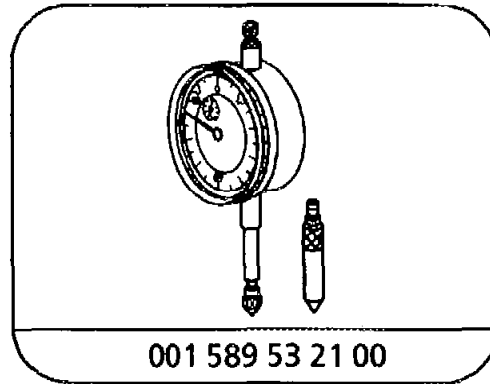

Dial gauge

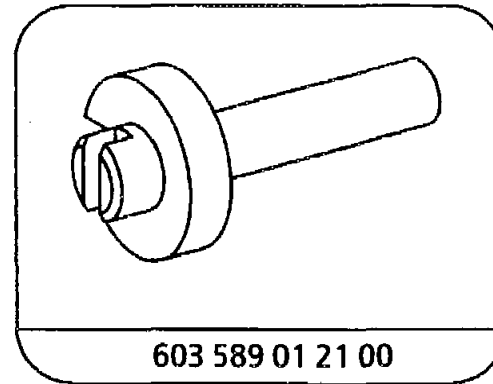

Fixing pin

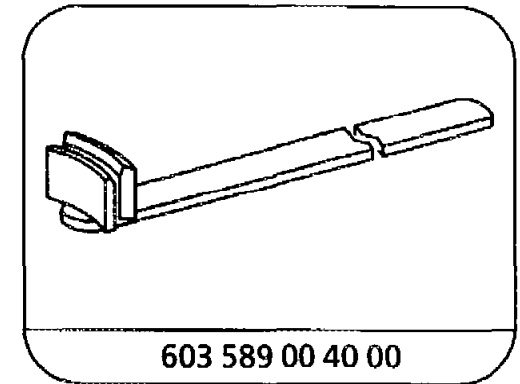

Counter-holder