

## ENGINE 601, 602, 603 (except, 602.982)

1 Valve clearance compensation element

2  Rubber suction cup

3 Oil gallery in cylinder head



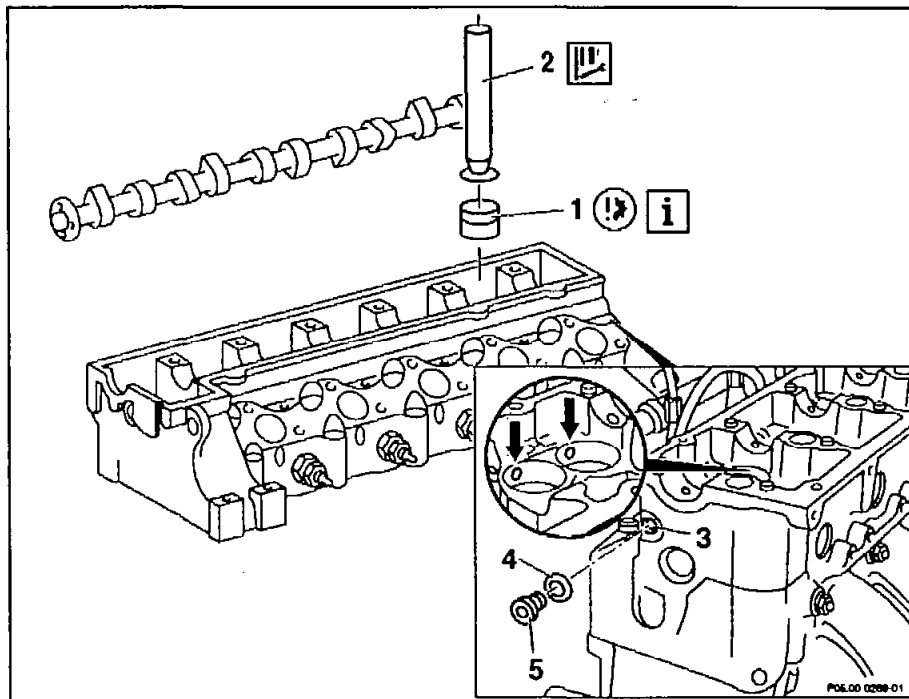

4 Seal

5 Screw plug

Arrows Oil feed drillings to compensation elements

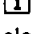

P05.00-0268-06

 	Removing, installing		
1	Remove camshaft		05-220
2	Pull out compensation element (1)	  Installation: re-install compensation elements (1) which are not replaced, at the same point. Oil compensation element (1).	WH58.30-Z-1008-02A
3	Remove screw plug (5) and blow compressed air into oil gallery (3)	 At the same time, inspect clearance of outlet drillings (arrows) at the seat of the valve tappet.  Installation: replace seal (4).	
4	Install in the reverse order		

## Commercially available tools (see Workshop Equipment Manual)

Number	Designation	Make (e.g.)	Order number
WH58.30-Z-1008-02A	Rubber suction cup $\varnothing$ 30 mm	Hazet Güldenwerther Bahnhofstraße 25-28 D-42857 Remscheid	735-2