

01-020 Illuminating cylinder

Preceding work:
 Nozzle holders removed (01.1-230)
 Prechambers removed (01-417).
 Engine 602.982 injection nozzles removed (AR07.13-8410C).

Operation no. of operation texts and work units or standard texts
 and flat rates
 01-1321

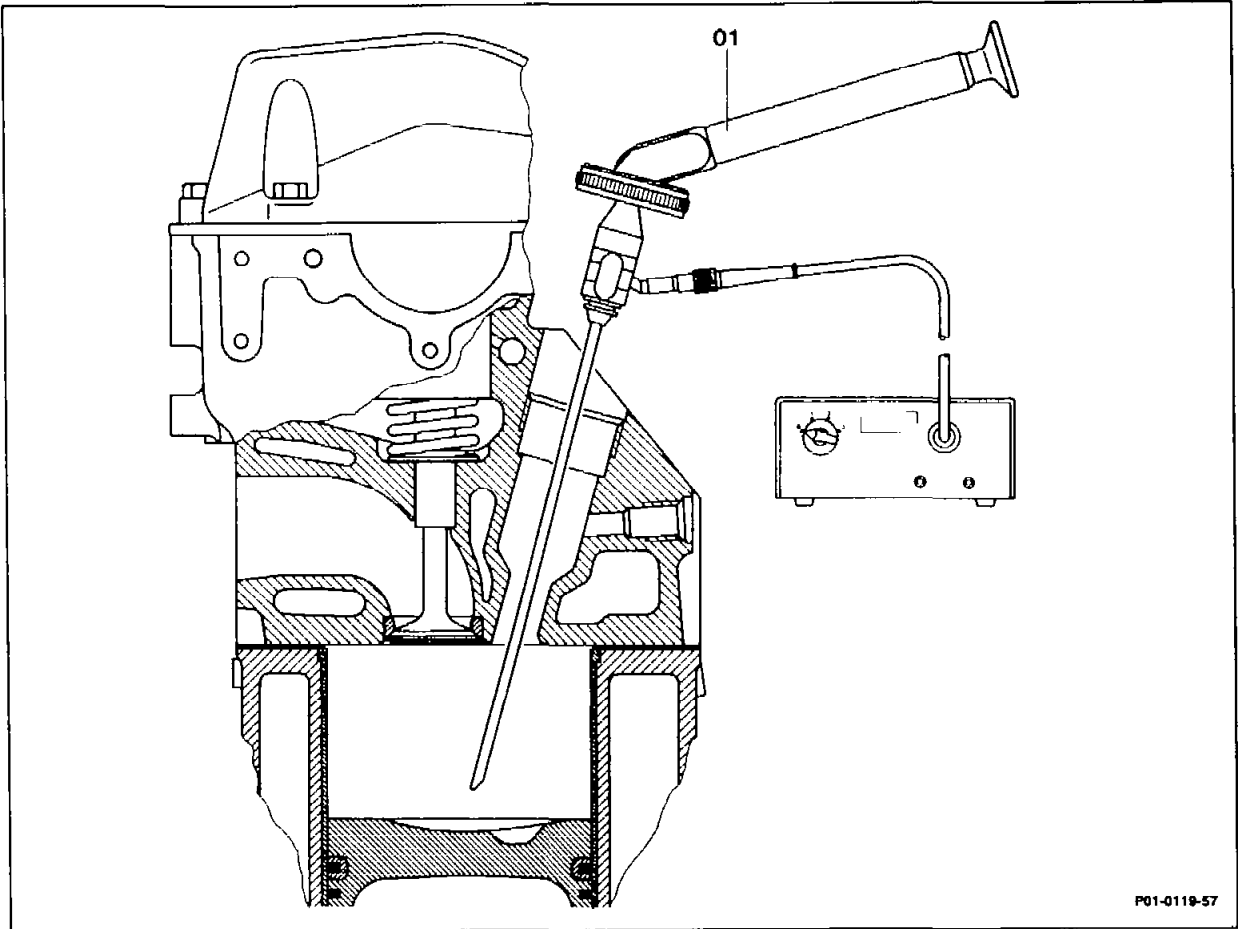

Piston	in cylinder to be tested, move to bottom dead center.
Cylinder	inspect with cylinder inspection lamp and check visually for signs of damage; insert probe (01) of inspection tool through the prechamber bore or nozzle holder shaft into the cylinder.

Note

When inspecting differentiate between "Optical stripes" and "Scoring". **"Optical stripes"** can result from the ring gap. If honing marks are still visible, the engine is okay. **"Scoring marks"** honing marks no longer visible, repair engine.

Commercially available tool

Cylinder illumination unit

e.g. Karl Storz GmbH,
78532 Tuttlingen
Motoskop TW (cold light)
with lens probes
103 26 CW (570 mm) and
103 26 CT (210 mm)
