

09

AR20.40-P-6800HA

Removing, installing fan shroud**2.4.93*****ENGINE 111, 605, 606 in MODEL 124******ENGINE 606 in MODEL 140******ENGINE 111 in MODEL 170******ENGINE 111, 604, 605 in MODEL 202******ENGINE 111 in MODEL 208******ENGINE 111, 602.982, 604, 605, 606 in MODEL 210******ENGINE 111 in MODEL 163***



- A** Engine 111 except 111.944/975, 604, 605 in model 124, 202
Engine 111, 602.982, 604, 605.962 in model 210
Engine 111 in model 163, 208
- B** Engine 606 in model 124
- C** Engine 111.943/946/973 in model 170 except AC
Engine 111.944/975 in model 202
Engine 605.91, 606 in model 210

- 1 Viscous fan coupling
- 7 Fan shroud
- 7a Fan shroud ring
- 8 Coolant hose
- 9 Locking clip (engine 606)
- 15 Flat springs
- 18 Radiator
- 110 Charge air pipe

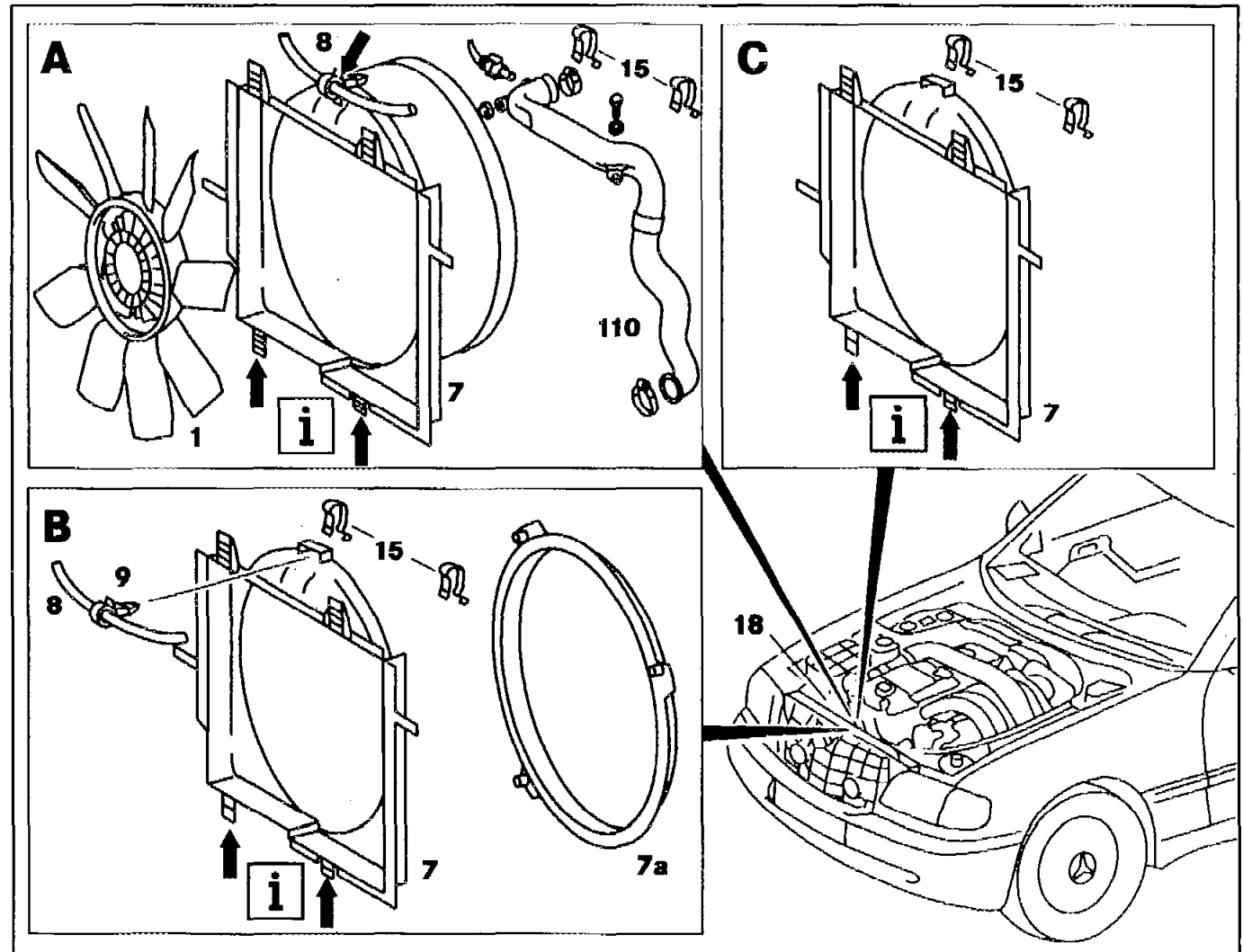

P20.40-0222-06

	Removal, installation		
1.1	Remove charge air pipe (110)	Engine 605.960 in model 202, engine 602.982, 605.962 in model 210	AR09.41-P-1311H



2.1	Release fan shroud ring (7a) from the locking studs by turning at the fan shroud, remove	Engine 606 in model 124, 140 ⓘ Installation: when installing, ensure that fan shroud ring is properly located in the locking studs of the fan shroud.	
3	Remove viscous fan coupling (1)	Engine 604 and 605 in model 124, 202 Engine 111 in model 163, 170, 208 Engine 111, 604, 605, 606 in model 210 ↓ Engine 111 Engine 604 Engine 605, 606 in model 124 Engine 606.961 in model 140 Engine 605 in model 202 Engine 602.982, 605, 606.912 in model 210	AR20.40-P-5660A AR20.40-P-5660HA F9 AR20.40-P-5660HB J9
4.1	Detach coolant expansion reservoir	Model 170	
5	Remove fan shroud (7), take out upwards	ⓘ on engine 604/605 in models 124, 202 together with viscous fan coupling	



		<p>i Model 163: remove screws of flat springs and take off flat springs.</p> <p>Ⓜ Installation: insert retaining lugs (arrows) of the fan shroud into the mounts at the radiator.</p> <p>Align fan shroud to the fan.</p>	
6	Install in the reverse order		