

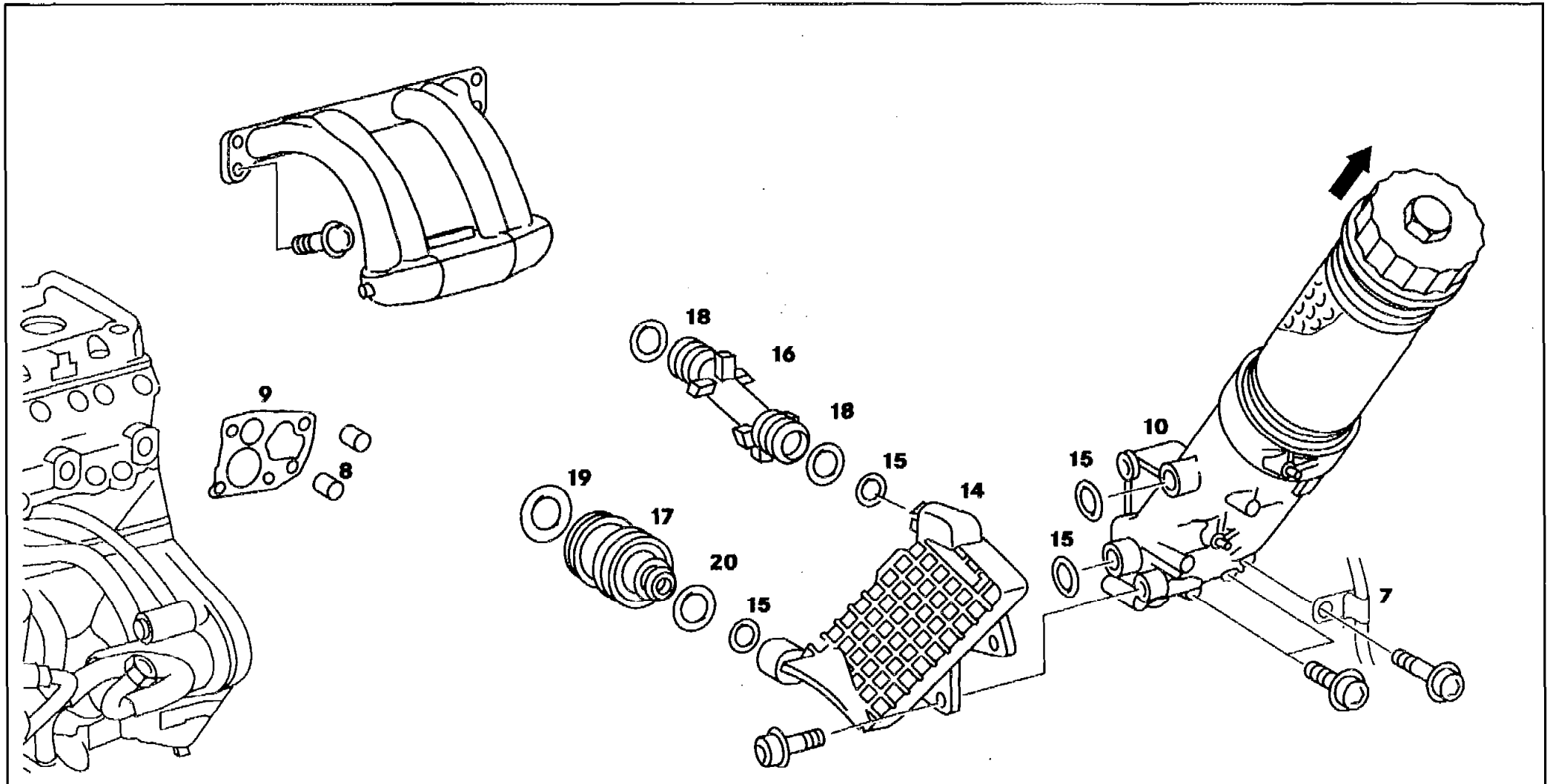







B4	AR18.30-P-3481B	Removing, installing oil-to-water heat exchanger at oil filter	1.6.95
----	-----------------	--	--------

**ENGINE 605**  
*in MODEL 202*



 	Removal, installation		
 <b>Danger!</b>	<b>Risk of injury</b> to skin and eyes from scalding from hot coolant which splashes out. <b>Risk of poisoning</b> from swallowing coolant.	Do not open the cooling system unless the coolant temperature is below 90 °C. Open cap slowly and allow the pressure to release. Do not pour coolant into containers for drinks. Wear protective gloves, protective clothes, and eye protection.	AS20.00-Z-0001-01A <b>J17</b>
1	Drain coolant		AR20.00-P-1142HA
2	Remove intake manifold		AR09.20-P-1310H
3	Drain engine oil from oil filter		AP18.00-P-0101-06EB <b>F16</b>
4	Unbolt bracket for intake manifold support at oil filter		
5	Unbolt oil filter housing (10) and lift out	 <b>Installation:</b> pay attention to dowel sleeves (8). Clean gasket residues of sealing surface. Replace gasket (9). Pay attention to bracket (7).	
6	Unbolt oil-to-water heat exchanger (14) at oil filter	 <b>Installation:</b> replace O-rings (15)	
7	Pull connection fittings (16, 17) out of crankcase	 <b>Installation:</b> replace O-rings (18, 19, 20). Coat with coolant before installing. Do not use engine oil.	
8	Install in the reverse order		