

07.1-9290 Removing and installing, replacing injection pressure lines

Operation no. of operation texts and work units or standard texts
and flat rates:
07-9290

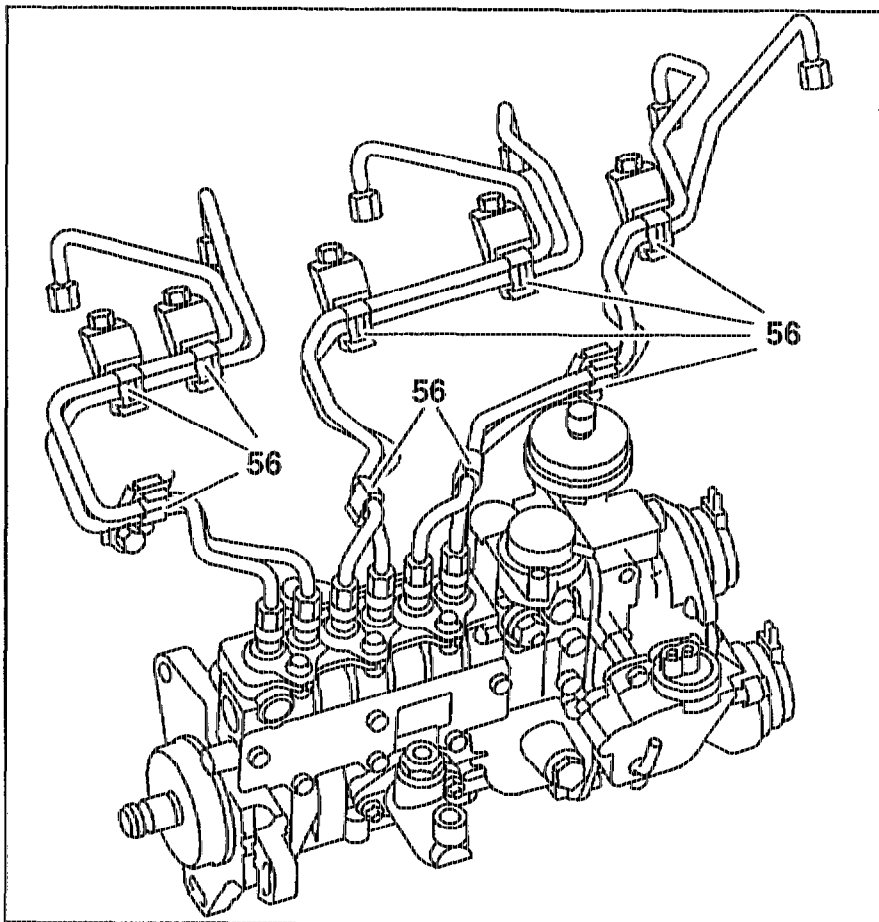

P07-6506-37

Shown on engine 606.910

Connecting rods at accelerator control linkage	detach, attach.
Control pressure cable for automatic transmission	detach, attach.
Bolts of accelerator control bracket	unscrew, screw in. To do this, compress plastic clip on bracket of accelerator lever and pull out together with Bowden cable, press in. Place accelerator control to the side.
Cylinder head cover trim panel	take off, fit on.
	Note
	When installing, ensure that the leak oil hose is correctly routed from cylinder 1 to return flow hose.
Crankcase ventilation	detach, fit on.

Removing and installing injection pressure lines complete

Intake manifold or variable resonance intake manifold
Bolts at bracket of injection lines
Union nuts at injection pump and nozzle

remove, install (14–1310, 14–1961).
unscrew, screw in.
unscrew, screw on. Seal all connections.
Special tool 000 589 77 03 00
Tightening torque 10–20 Nm as reference value.

Note
To avoid pipe fractures, all the retaining clips (56) must be positioned as shown in the overview illustration.

When removing an injection pipe, it is necessary to replace the complete retaining clips of the relevant pipe.
check with engine running.

Leaktightness of all connection points

Removing and installing injection pressure line of individual cylinders

Engine 605.911

Air cleaner cross pipe

remove, install (09–8031).

Note
To remove the injection line of cylinder 5, the intake manifold must be taken out first of all. (14–1310).

Engine 606.910

Variable resonance intake manifold

remove, install (14–1961).

All models

Union nuts on injection pump and nozzle of corresponding injection line

unscrew, screw on. Seal all connections.
Special tool 000 589 77 03 00
Tightening torque 10–20 Nm as reference value.

Retaining clips (56) nozzle of the corresponding injection line

unclip, clip in place.

Note
To avoid pipe fractures, all the retaining clips (56) must be positioned as shown in the overview illustration.

When removing an injection pipe, it is necessary to replace the complete retaining clips of the relevant pipe.

Leaktightness of all connection points

check with engine running.

Special tool

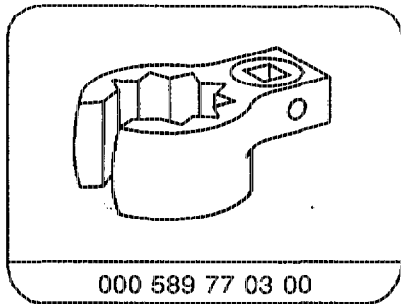

Note

Conversion to self-tapping screws for attaching cylinder head cover trim panel to cylinder head cover.

Production breakpoint: as of December 1993

Model	Engine	Engine end no. manual transmission	Engine end no. automatic transmission
124.104/107/126/129/ 186	605.911	011162	003654
124.131/191	606.910	003268	005094