

07.1-8050 Servicing injection timing device

Preceding work:
Removing and installing injection timing device (07.1-8014).

Operation no. of operation texts and work units or standard texts
and flat rates:
07-8050

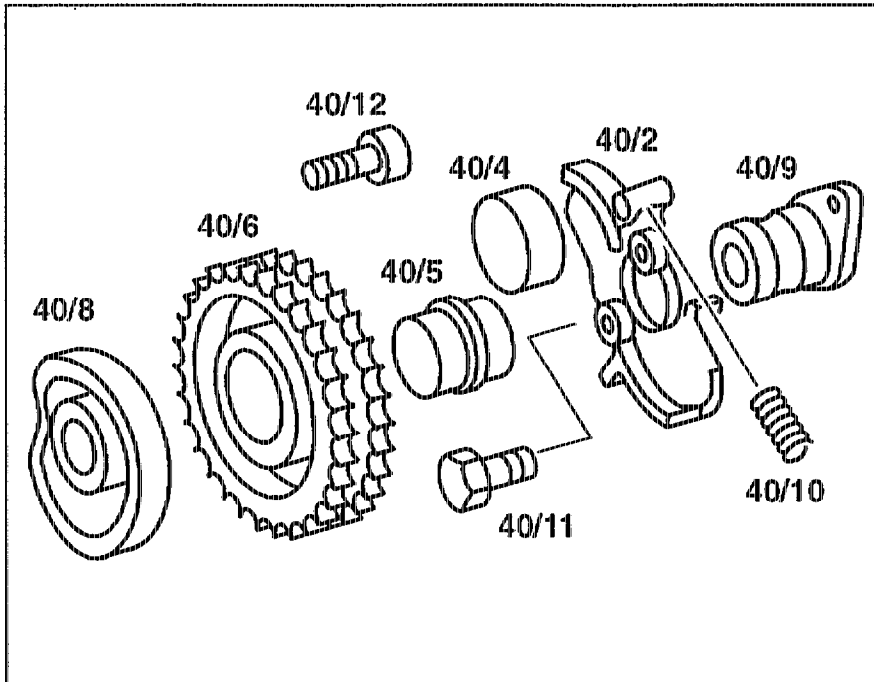

P07-6107-35

Drive hub (40/9) together with segment flange (40/2)	remove from sprocket (40/6), fit on. Take off compression springs (40/10) and governor weights (40/4), insert. Check parts for signs of wear, replace if necessary.
Drive hub (40/9) and segment flange (40/2)	separate, fit together. To do this, unscrew bolts (40/11), screw in. Tightening torque 25 Nm.
Bush (40/5)	remove, check for signs of wear, replace if necessary, install.
Cam disk (40/8) at sprocket (40/6)	pull off, fit on. To do this, unscrew bolts (40/12). Examine cam disk for signs of wear, replace if necessary. Tightening torque 15 Nm.

Note

Segment flange of injection timing device modified from forging to sintered part. New injection timing device is installed with washer.

Production breakpoint: as of June 1994

Model	Engine	Engine end no. manual transmission	Engine end no. automatic transmission
124.104/107/126/129/ 186	605.911	020485	007642
124.131/191	606.910	005998	011023