



B11

AR01.45-P-7500C

Removing, installing oil sump

17.2.95

**ENGINE 606.961 in MODEL 140**

**ENGINE 605, 606.912 /962 in MODEL 210**

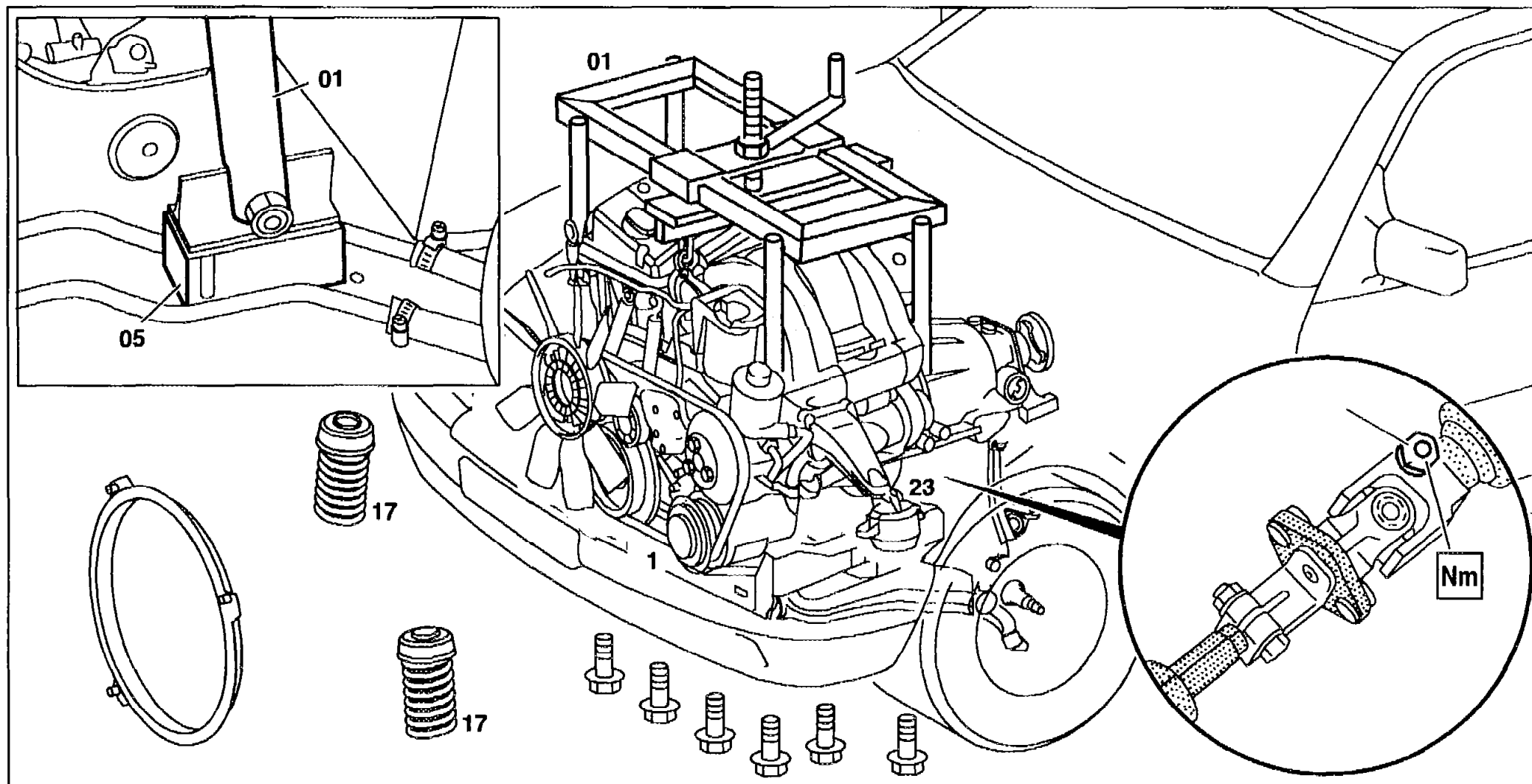

P01.45-0244-09

Shown on model 140 with engine 606.961 ↑

Shown on model 210 with engine 604 ↓

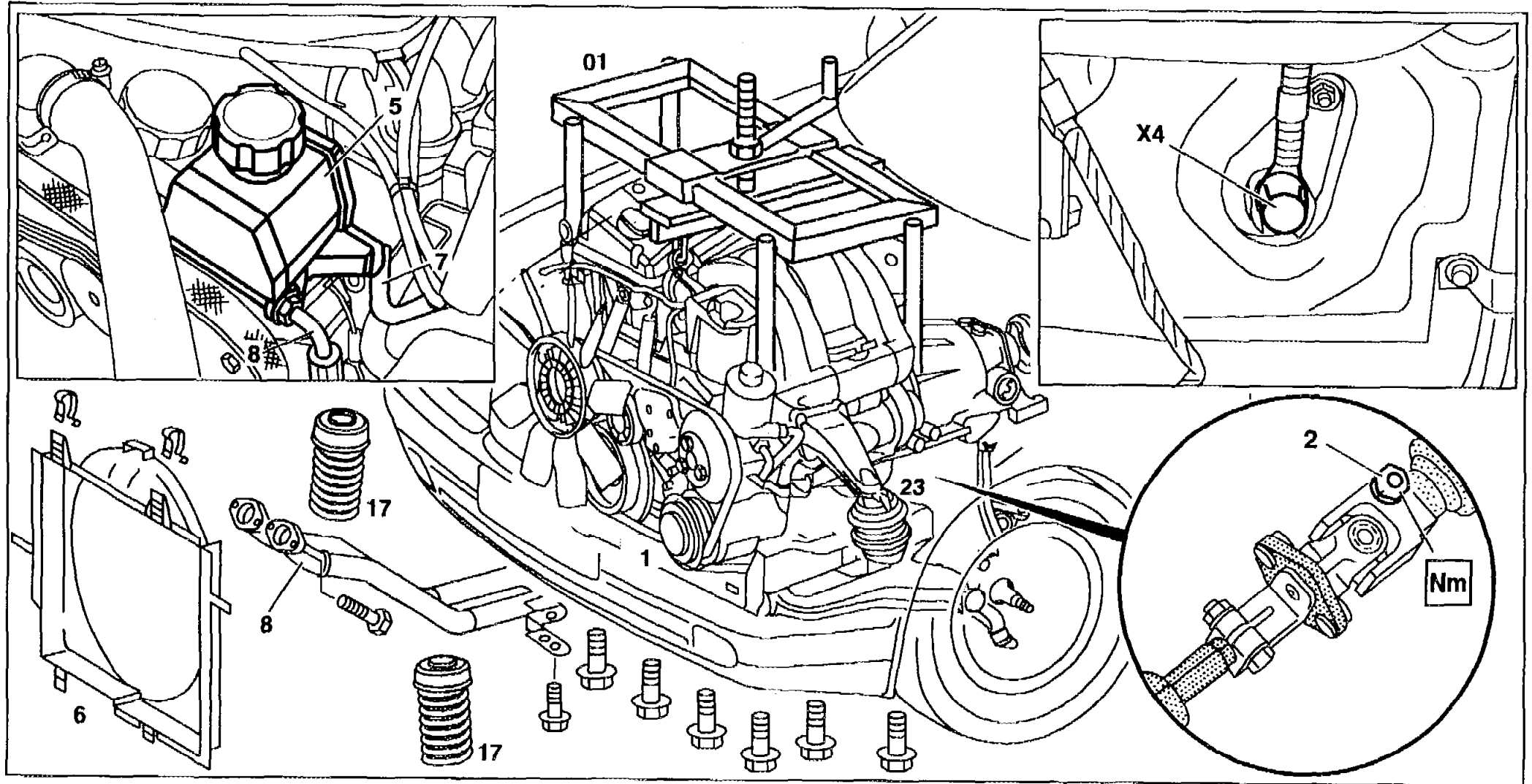

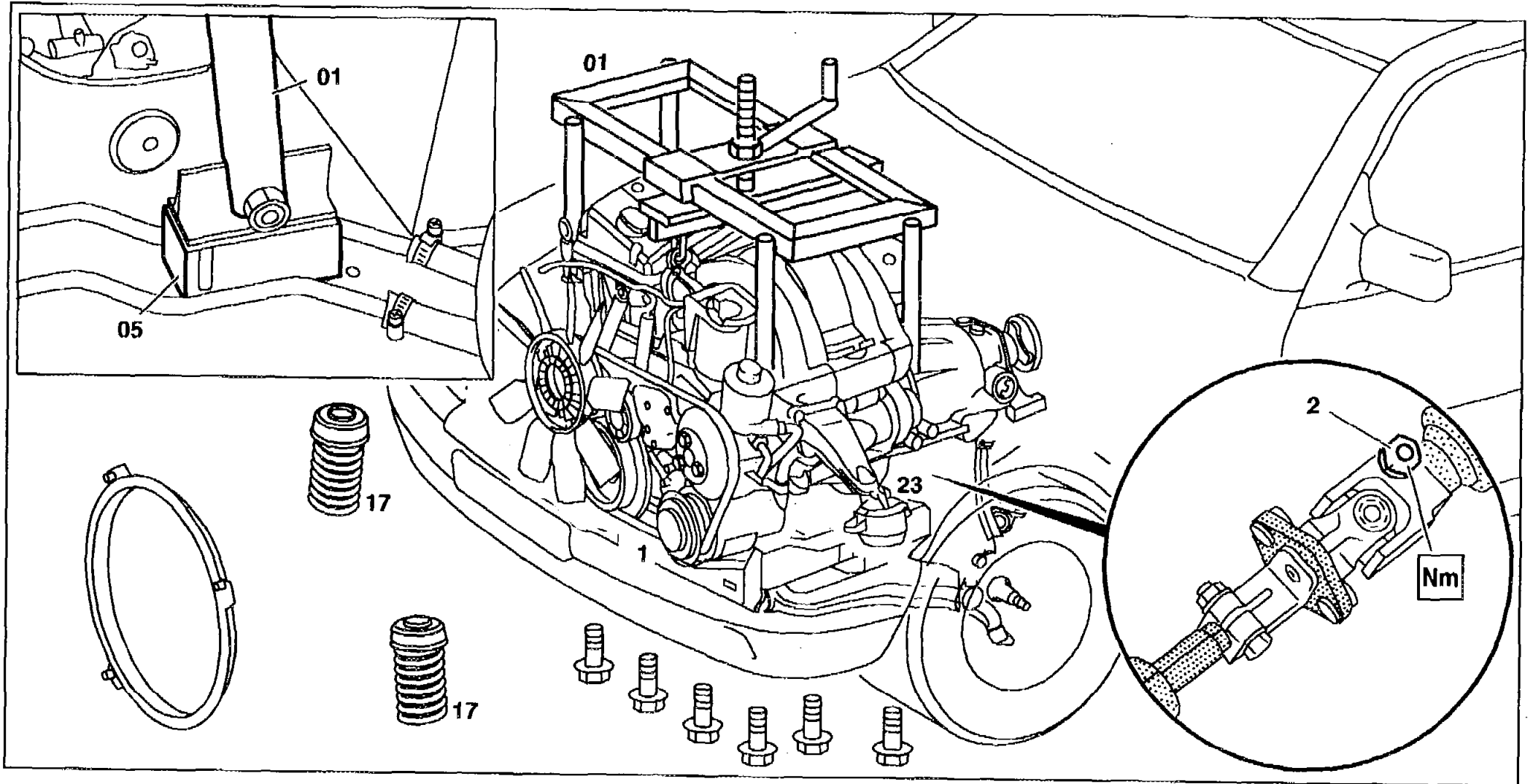



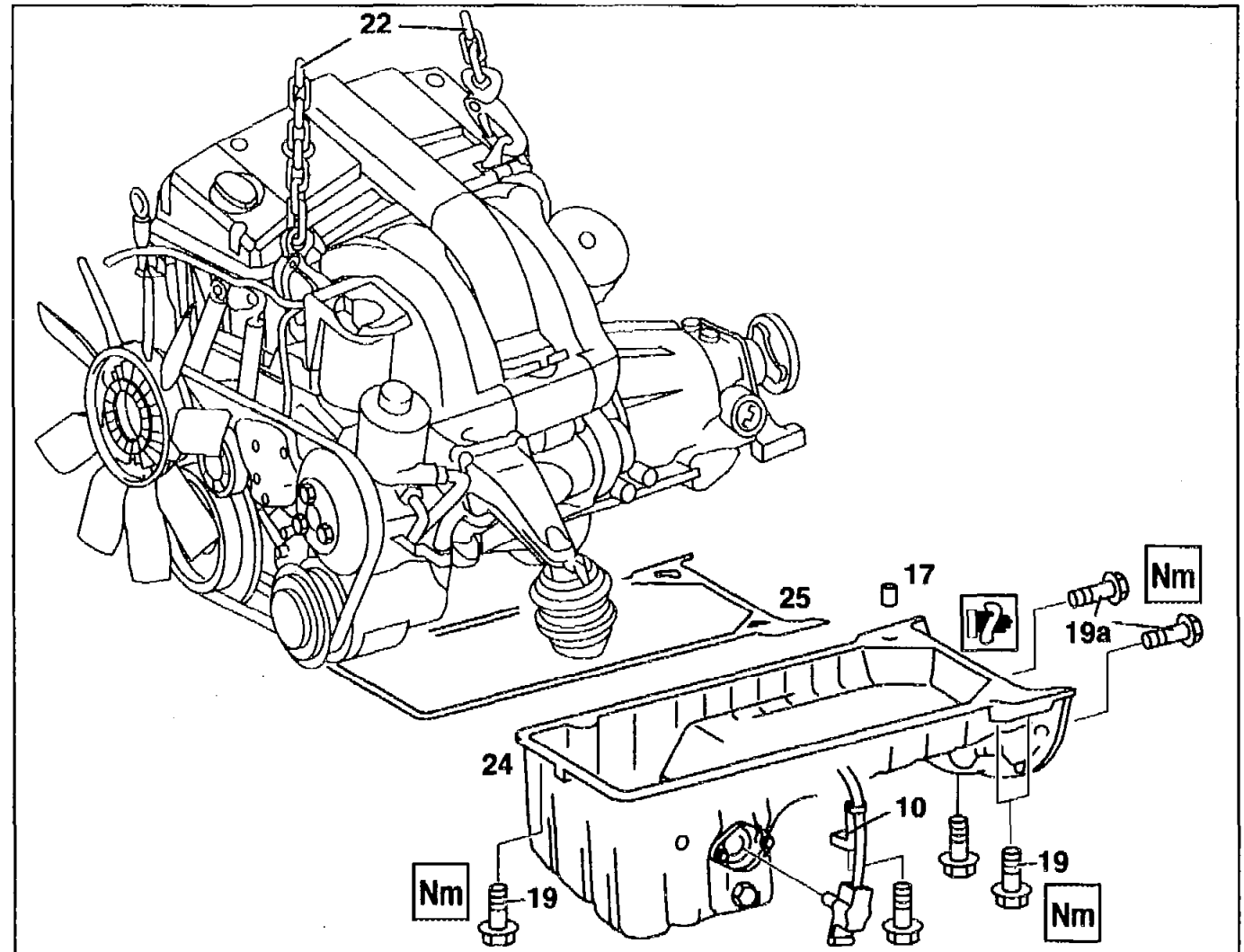













Shown on model 210 with engine 606.962 ↑



P01.45-0211-06

	<b>Removing, installing</b>		
1	Unbolt ground cable of battery		AR54.10-P-0003A

2	Remove bottom parts of noise encapsulation	Model 210	AR94.30-P-5300AB
3.1	Unbolt right charge air line at front suspension support (1)	Engine 606.962 in model 210	
4.1  AP	Extract engine oil Extract engine oil		WH58.30-Z-1007-16A AP18.00-P-0101-02Z <b>C17</b>
5.1	Remove top charge air pipe	Model 210 with engine 605.962	AR09.41-P-1311H
6.1	Release fan shroud ring	 Model 140: Place over fan	AR20.40-P-6800HA
6.2	Take off fan shroud (6)	 Model 210: Place over fan	AR20.40-P-6800HA
6.3	Remove fan shroud (6)	Engine 606.962	AR20.40-P-6800HA
7.1	Extract oil from power steering pump (5)	Model 210	
8.1	Disconnect steering oil pressure hose (8) and steering oil return flow hose (7)	Engine 605, 606.912/962 in model 210  To enable front suspension support (1) to be lowered	
9.1	Unbolt electric cable at front left of intake manifold	Engine 605, 606.912 in model 210	
10.1	Unbolt electric cable (X4)	 Model 210: At outside of frame floor at front left	
11	Remove front springs (17)		AR32.20-P-0200B

<p>12</p>	<p>Unbolt front engine mounts (23) at front suspension support (1)</p>	<p> Model 140</p> <p> Model 210</p>	<p>BA22.10-P-1008-01D</p> <p>BA22.10-P-1001-01D</p>
<p>13</p> <p> WF</p>	<p>Fit on engine supporting frame (01) and raise engine</p>	<p>Model 140 with engine 606.692</p> <p> Detach lines to windshield washer reservoir from fixture at side member and unbolt fixture to enable right front support to be positioned against side member. Fit spacer (05) over threaded bolt of fixture ↓</p> <p>Spacer for engine supporting arm</p> <p>Model 210</p> <p> </p>	<p>AR01.10-P-7500-03A    <b>N16</b></p> <p>WF58.50-P-0145-01A    <b>H18</b></p> <p>AR01.10-P-7500-03B    <b>O16</b></p> <p>140 589 01 61 00</p> <p>210 589 00 61 00</p>
<p>14</p>	<p>Support front suspension carrier (1) with inspection pit or assembly lift</p>	<p>Model 140</p> <p> Model 140</p> <p>Model 210</p> <p> Model 210</p>	<p>AR33.10-P-0100-03A    <b>A17</b></p> <p>140 589 00 62 00</p> <p>AR33.10-P-0100-03B    <b>B17</b></p> <p>210 589 00 62 00</p>
<p>15</p>	<p>Detach steering shaft from steering joint (2)</p>	<p> Model 140</p> <p> Model 210</p>	<p>BA46.10-P-1003-01A</p> <p>BA46.10-P-1001-01B</p>

16	Unbolt front suspension carrier (1) and lower	Model 140  Model 210	AR33.10-P-0100A  AR33.10-P-0100B
17	Unplug connector of oil level sensor		
18.1	Drain ATF	Engine 606.962	
19.1	Unbolt left ATF line at transmission	Engine 606.962	
20	Unscrew bolts of oil pan (19, 19a)	<p><b>i</b> Installation: Pay attention to fixture (10) for electric cable of oil level sensor and attachment of ground strap (W11/1) at transmission bell. If automatic transmission fitted (code 420a, 425a) pay attention to bracket for ATF lines (13) and transmission wiring harness (15, 16).</p> <p><b>i</b> Pay attention to different lengths and diameters of bolts ↓</p> <p>Bolt diagram of oil pan</p> <p><b>Ⓢ</b> Align oil pan (24) to rear contact surface on transmission. If the oil pan is not aligned to the transmission, this can result in noise and vibration problems.</p> <p><b>S</b></p>	<p>AR01.45-P-7500-06HA      <b>J16</b></p> <p>001 589 76 09 00</p>

		Nm Nm	BA01.45-P-1001-01A BA01.45-P-1002-01A
21	Remove oil pan (24) together with oil pan gasket (25)	<p><b>i</b> Take out oil pan forward in direction of travel; rotate crankshaft slightly, if necessary, for this step. If automatic transmission fitted; press the ATF lines slightly to the side. Clean contact surfaces of oil pan. Replace oil pan gasket (25).</p> <p><b>i</b> <b>Installation:</b> fix oil pan gasket (25) onto crankcase with sealant, if necessary. Model 210: pay attention to dowel sleeve (17)! If the oil pan is replaced, attach oil level sensor with self-tapping screws.</p>	BR00.45-Z-1014-01A
22	Install in the reverse order		
23.1	Inspect oil level of power steering pump, adjust to correct level	Model 210	AP46.00-P-4611BB
24.1	Inspect ATF level in automatic transmission, adjust to correct level	Engine 606.962	AR27.00-P-0101A
25.1	Inspect engine oil level, adjust to correct level		



<p><b>⚠ Danger!</b></p> <p>25</p>	<p><b>Risk of accident as a result of vehicle starting off when engine running. Risk of injury as a result of bruises and burns if you insert your hands into engine when it is being started or when it is running.</b></p> <p>Run engine and inspect for leaks</p>	<p>Secure vehicle to prevent it starting off. Wear closed and close-fitting work clothes. Do not grasp hot or rotating parts.</p>	<p>AS00.00-Z-0005-01A <b>J17</b></p>
<p>26</p>	<p>Read fault memory, erase.</p>	<p>Stored faults which may be caused by disconnecting cables or by simulation when carrying out removal and installation or test work, have to be processed and erased in the fault memories after completing the work.</p> <p>Diagnosis Manual Volume 1.1: Index 0: Connecting and using test equipment.</p>	

**Nm Oil pan**

Number	Designation	Engine 604, 605, 606	
BA01.45-P-1001-01A	Bolt of oil pan to crankcase	M6 Nm	10
		M8 Nm	25
		M10 Nm	-
BA01.45-P-1002-01A	Bolt of transmission bell to oil pan	Nm	40

**Nm** Engine suspension, engine mounts, engine supports

Number	Designation		Engine 604, 605, 606 in model 210	Engine 606.961 in model 140
BA22.10-P-1001-01D	Bolt of front engine mount to front axle carrier	Nm	35	-
BA22.10-P-1008-01D	Bolt of engine mount to frame crossmember	Nm	-	25

**Nm** Steering shaft

Number	Designation			Model 140 as of vehicle ident end no. A-166 260
BA46.10-P-1003-01A	Bolt of steering joint	M8	Nm	20

**Nm** Steering shaft

Number	Designation		Model 210
BA46.10-P-1001-01B	Bolt of steering joint		Nm 20

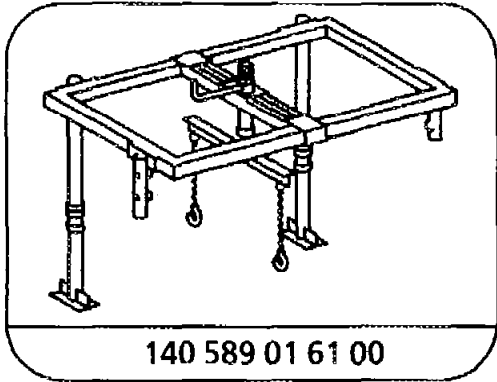

140 589 01 61 00

Engine supporting frame

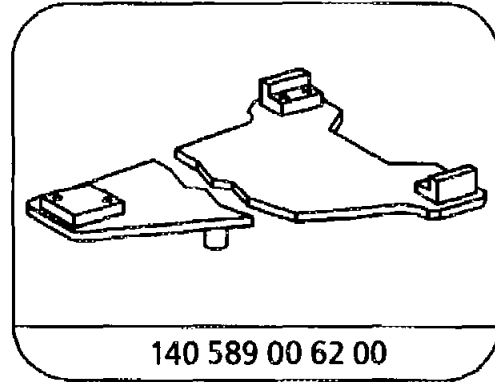

140 589 00 62 00

Adapter

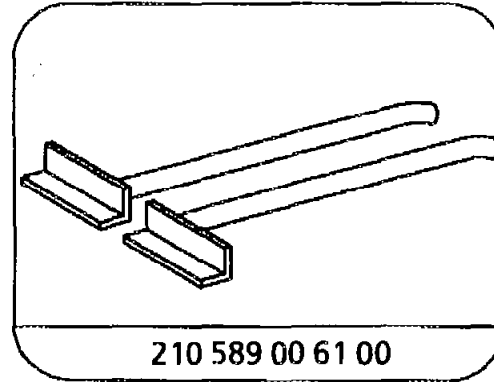

210 589 00 61 00

Supports for engine supporting frame  
(2 in total)

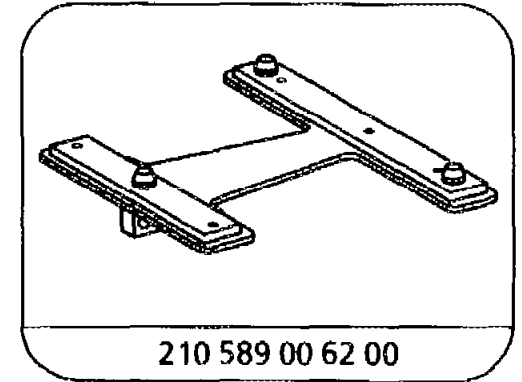

210 589 00 62 00

Adapter

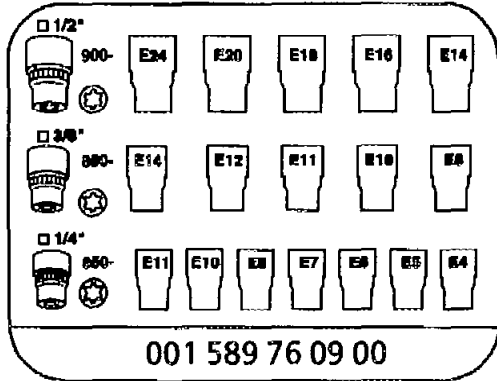

001 589 76 09 00

External torx set

**Commercially available tools (see Workshop Equipment Manual)**

Number	Designation	Make (e.g.)	Order number
WH58.30-Z-1007-16A	Engine oil extractor	Deutsche Tecalet Am Metallwerk 11 33659 Bielefeld	1.386950.2

**Repair products**

Number	Designation	Order number
BR00.45-Z-1014-01A	Omnifit FD 3041 sealant (50 ml)	002 989 47 20 10