

G4

AP15.10-P-1580EA

Replacing spark plugs

3.5.95

ENGINE 119.97 /98

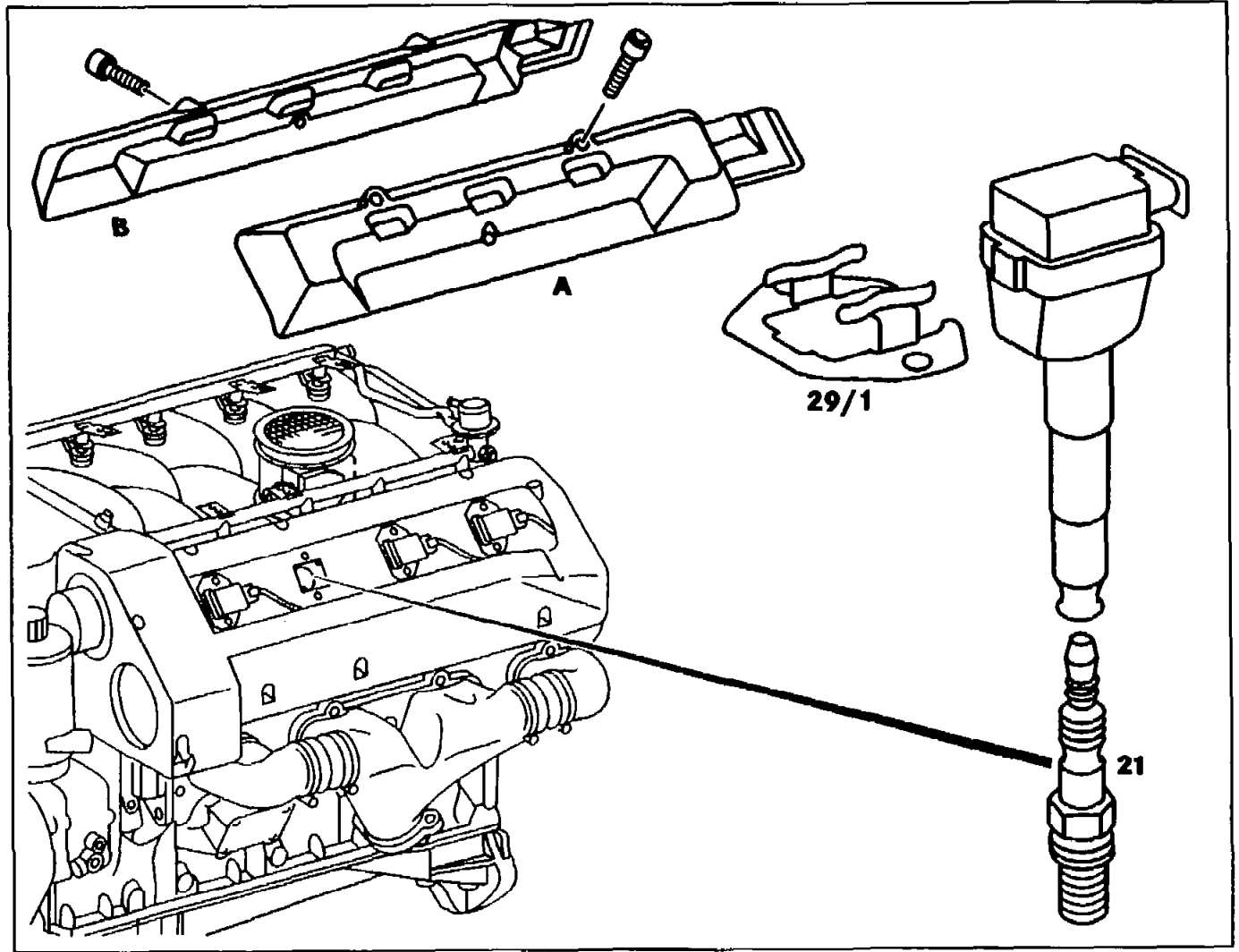









Fig. item, etc.	Work instructions		
 Danger!	Hazard from touching parts conducting high voltages	Do not touch parts conveying high voltages. Persons who are provided with electronic implants (e.g. heart pacemakers) must not carry out any work on the ignition system.	AS15.10-Z-0001-01A
	Instructions for avoiding damage to the ignition system	Engine 104, 111, 112, 113, 119, 120 with ME-SFI fuel injection and ignition system	AH15.10-P-0002-01D A17
		Engine 103, 104, 119 with CFI fuel injection system	AH15.10-P-0002-01E B17
		Engine 104, 119, 120 with LH-SFI fuel injection system	AH15.10-P-0002-01F C17
	Spark plug connector	When plugging in, ensure ignition cables are correctly routed	
A, B	Covers		
21	Spark plugs	use only approved spark plugs with flat seat and seal  Check electrode gap, specification = 0.8 mm  	BA15.10-P-1001-01A 119 589 02 09 00
29/1	Attachment element	Pay attention to installation position	

**Nm** Spark plugs

Number	Designation	Engine 104, 110, 111, 112, 113, 115, 117, 119, 120
BA15.10-P-1001-01A	Spark plugs	Nm 28

