



P7	AR47.20-P-5820D	Removing and installing check valve for fuel pump	3.8.94
-----------	-----------------	--	---------------

ENGINE 104.942 up to 31.7.94,

111.940 /960 up to 30.9.94

in MODEL 124.### #I

ENGINE 104.992, 111.940 /960 up to 31.1.95 in MODEL 124.### #B

ENGINE 104.98 in MODEL 124

ENGINE 104.943 /991 up to 30.9.94 in MODEL 129

ENGINE 104.944 /994 up to 31.8.94 in MODEL 140

ENGINE 104.941, 111.92 /941 /944 /945 /961 /974 /975 up to 31.10.94 in MODEL 202

Shown on model 124 sedan

- 52 Fuel delivery hose
- 53 Fuel suction hose
- 54a Cap nut
- 62 Copper sealing ring
- 62a Copper sealing ring
- 63 Check valve

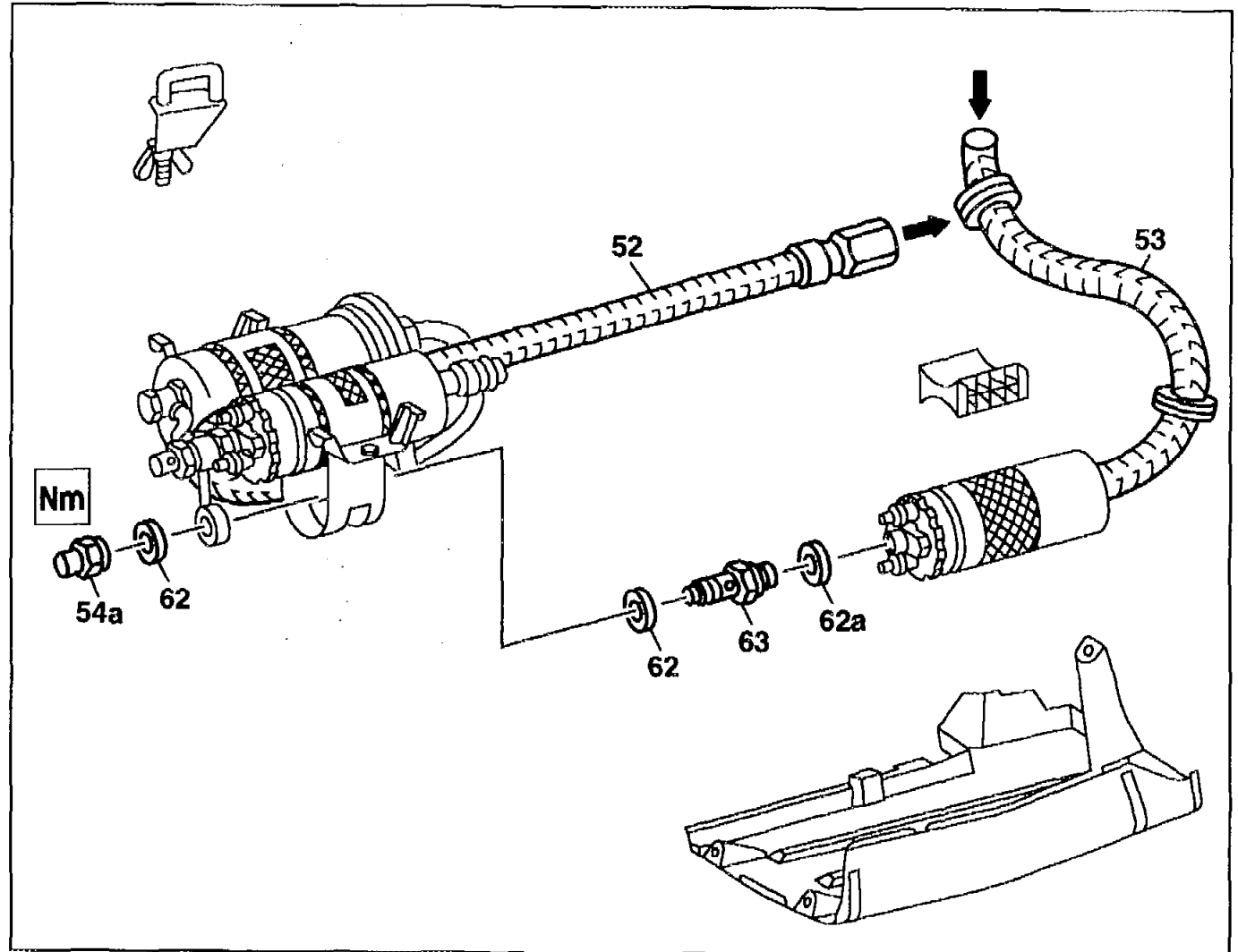

P47.20-0232-06

Fig. item, etc.	Work instructions		
-----------------	-------------------	--	--



Danger!	Risk of explosion from ignition. Risk of poisoning from inhaling and swallowing fuel. Risk of injury as a result of fuel coming into contact with skin and eyes.	No fire, naked flame or smoking. Pour fuels only into suitable and appropriately marked containers. Wear protective clothing when handling fuel.	AS47.00-Z-0001-01A D17
53, 52 	Fuel suction hose, fuel delivery hose Model 124 T-model	pinch off Do not pinch off fuel suction hose at elbow	000 589 40 37 00
54a, 63	Cap nut, check valve	Replace copper sealing rings (62, 62a) 	BA47.20-P-1002-01A BA47.20-P-1003-01A BA47.20-P-1004-01B BA47.20-P-1005-01B

Fuel pump

Number	Designation	Engines 104, 119, 120
BA47.20-P-1002-01A	Cap nut of fuel pipe to fuel pump	Nm 27
BA47.20-P-1003-01A	Check valve to fuel pump	Nm 27

**Nm** Fuel pump

Number	Designation	Engines
		111
BA47.20-P-1004-01B	Cap nut of fuel pipe to fuel pump	Nm 27
BA47.20-P-1005-01B	Check valve to fuel pump	Nm 27

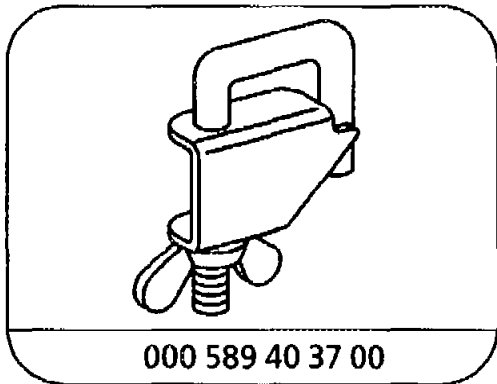

Clamp