

## 18-2100 Removing and installing oil pump

Preceding work:  
Oil sump removed (01-3100)

Operation no. of operation texts and work units or standard texts  
and flat rates:  
18-6020-6025

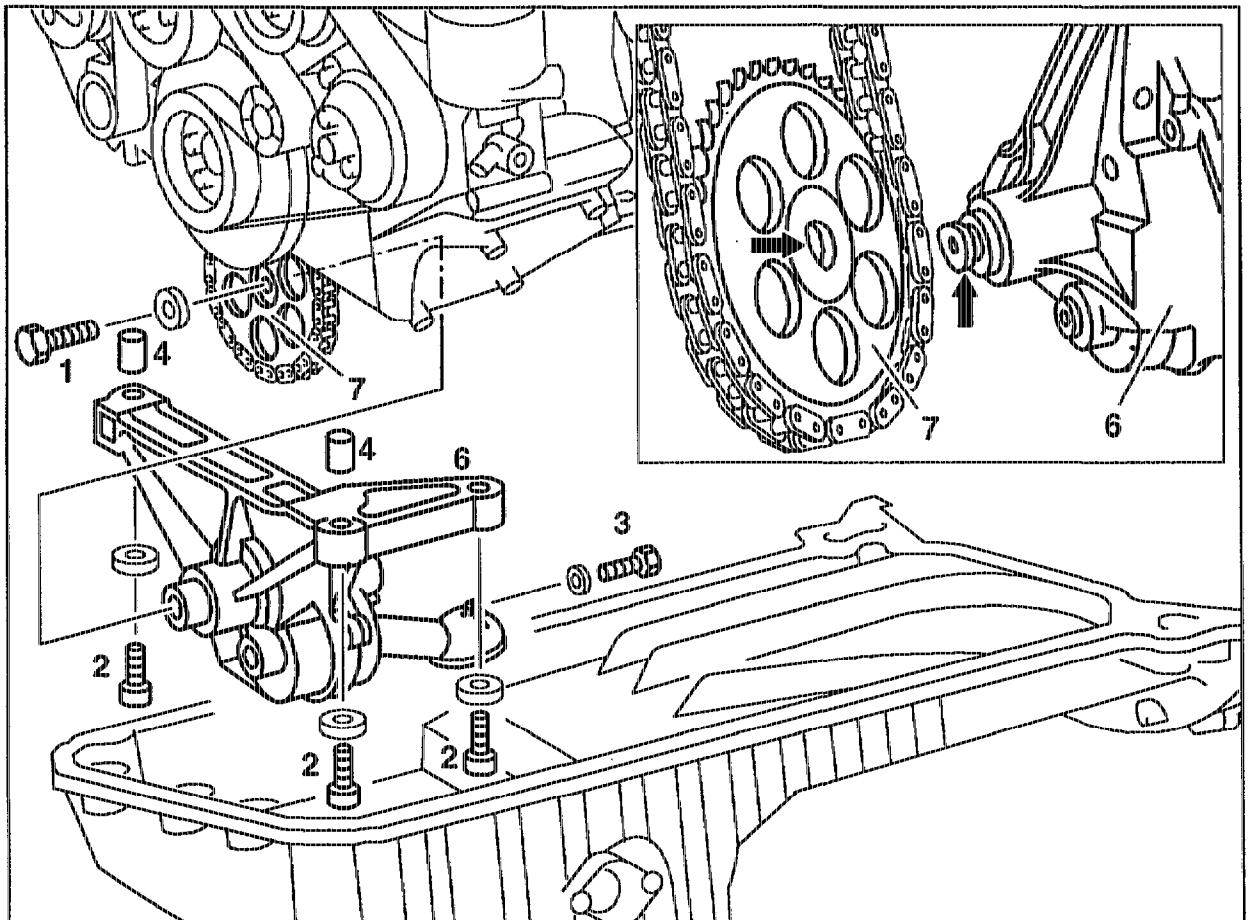

P18-5260-57

|   |  |   |                       |
|---|--|---|-----------------------|
| 1 | M8 × 20 bolt                           | 3 | M6 × 25 bolt + washer |
| 2 | M8 × 35 bolt + washer (hexagon socket) | 4 | Dowel sleeve          |

Bolt (1) of oil pump gear (6) ..... unscrew, screw on (32 Nm).  
Oil pump drive gear (7) at oil pump (6) ..... pull off, fit on.

### Note

Install oil pump-drive gear (7) with convex face pointing toward oil pump (6) (arrows). Pay attention to position of tensioning bar relative to oil pump chain.

Bolts + washer (2) and (3) ..... unscrew, screw on (M6 9 Nm; M8 21 Nm).

Oil pump (6) ..... remove to the front, install.

**Note**

Fill oil pump with engine oil before installing.  
clean.

Strainer in oil pump .....

**Tightening torques in Nm**

|   |    |
|---|----|
| Oil pump drive gear to oil pump         | 32 |
| Oil pump to crankcase                   | 25 |
| Bolt of oil pump to oil deflector plate | 10 |
| Bolts to oil pump cover (M6)            | 10 |

**Special tool**

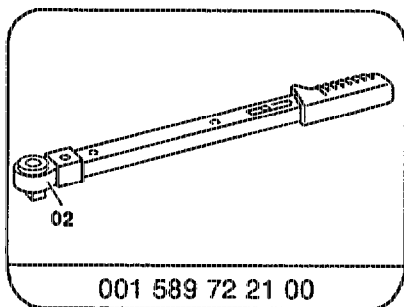

**Note**

Oil pump with hollow gear shaft to prevent oil buzz after cold start up to about 2000 rpm.

As of engine number (November 1995)

- 104.941 10 006 361
- 104.941 12 068 532
- 104.942 10 006 914
- 104.942 12 062 914
- 104.943 10 001 343
- 104.943 12 005 453
- 104.945 10 000 014
- 104.945 12 000 024
- 104.991 12 017 802
- 104.992 10 005 537
- 104.995 12 100 782
- 104.995 12 010 421