

18-1100 Removing and installing oil filter

Preceding work:
Air cleaner removed (09-0015)
Starter removed (15-700)

Operation no. of operation texts and work units or standard texts
and flat rates:
18-3090-3800

A. Model 124 with engine 104.980 Models 129, 140 on engines with air-to-oil cooling

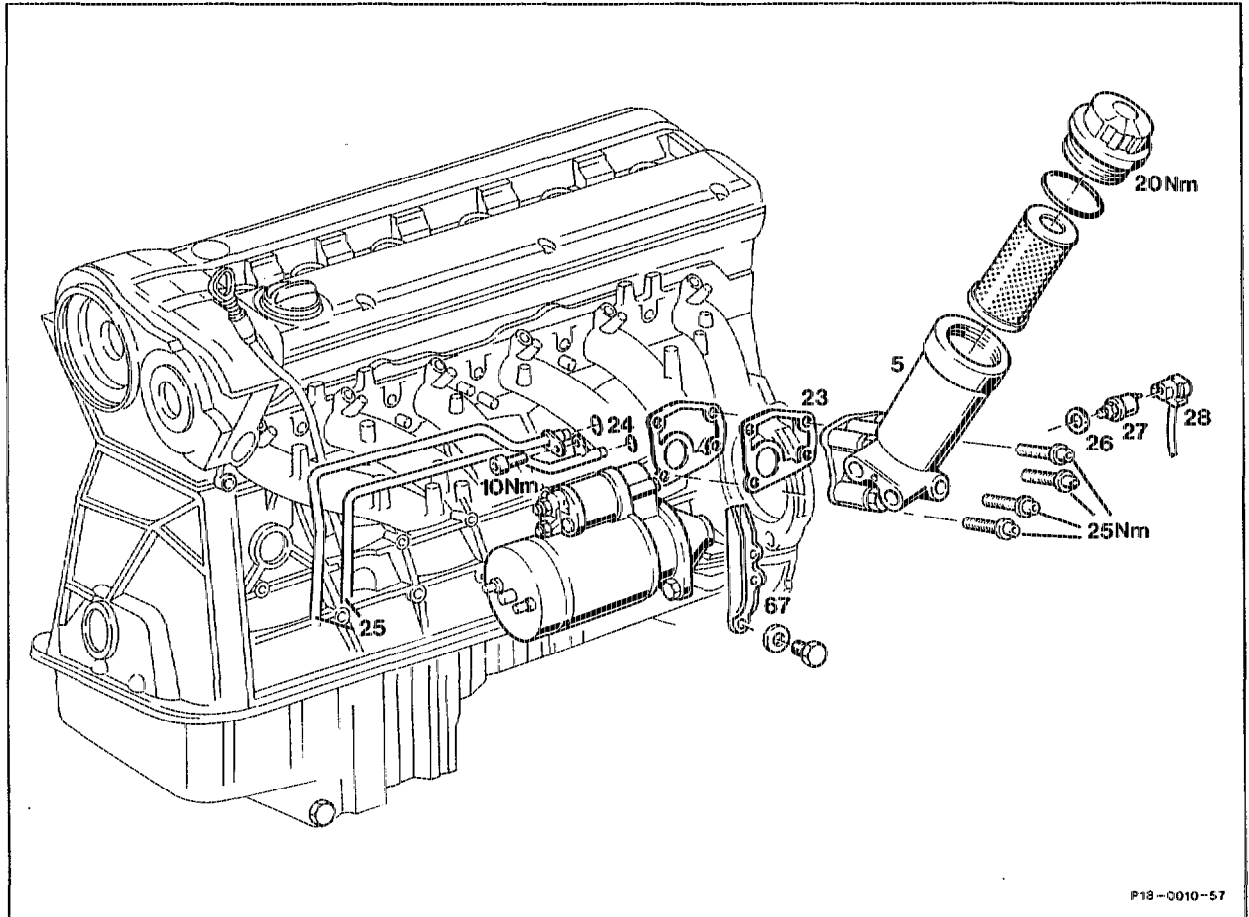

Connector (28)	unplug, plug in.
Oil pressure switch (27) at oil filter (5)	unscrew, screw on (step 2).
Intake manifold bracket at rear (67)	unbolt, bolt on (step 3).
Models 124, 129: if cruise control fitted	remove actuator of electronic accelerator with linkage, install (cable remains connected).
Engine oil cooler pipes (25) at fixtures	detach, screw on (step 5).
Engine oil cooler pipes (25) at oil filter (5)	unscrew, screw on, replace seals (24).

Oil filter (5)	remove, install.
Sealing surfaces	clean.
Gasket (23)	replace.
Oil level in engine	check (18-0020).
Leaktightness	perform check.

Tightening torques in Nm

Oil filter to crankcase	25
Screw cover	20
Oil pressure sensor in oil filter housing	20

Special tools

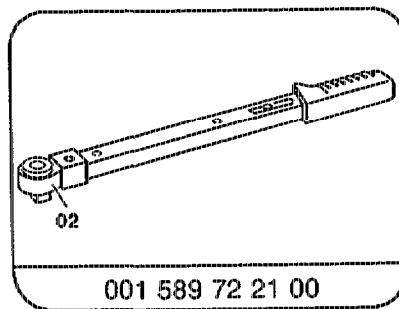
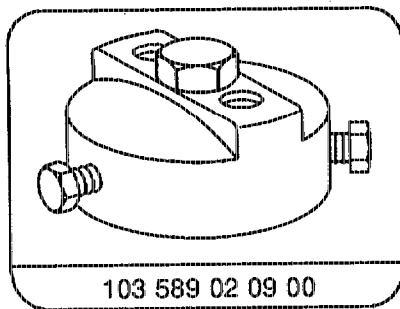

Removing, installing

- 1 Unplug connector from oil pressure sensor (4).
- 2 Unscrew oil pressure sensor from oil filter.
- 3 Unbolt rear intake manifold bracket (arrows).

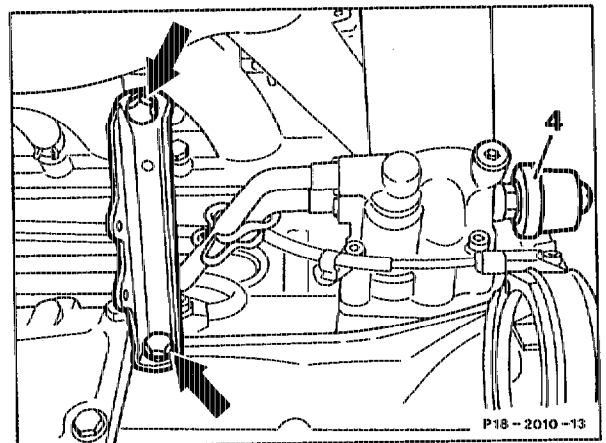

4 Models 124, 129: if cruise control fitted, remove actuator of electronic accelerator with linkage; cable remains connected.

5 Detach engine oil cooler pipes from fixtures (arrows).

6 Unscrew engine oil cooler pipes from oil filter.

Installation note

Replace seals (7).

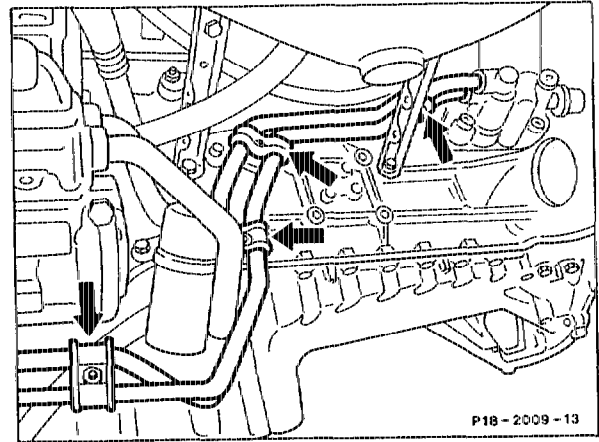

7 Unscrew bolts and take off oil filter.

Installation note

Clean sealing surfaces and replace gasket.

8 Install in reverse order.

9 Check oil level in engine.

10 Perform check for leaks.

B. Engines with oil-coolant heat exchanger

Preceding work:
Top part of resonance intake manifold removed
(AR09.20-1310D).

Operation no. of operation texts and work units or standard texts
and flat rates
18-3090-3800

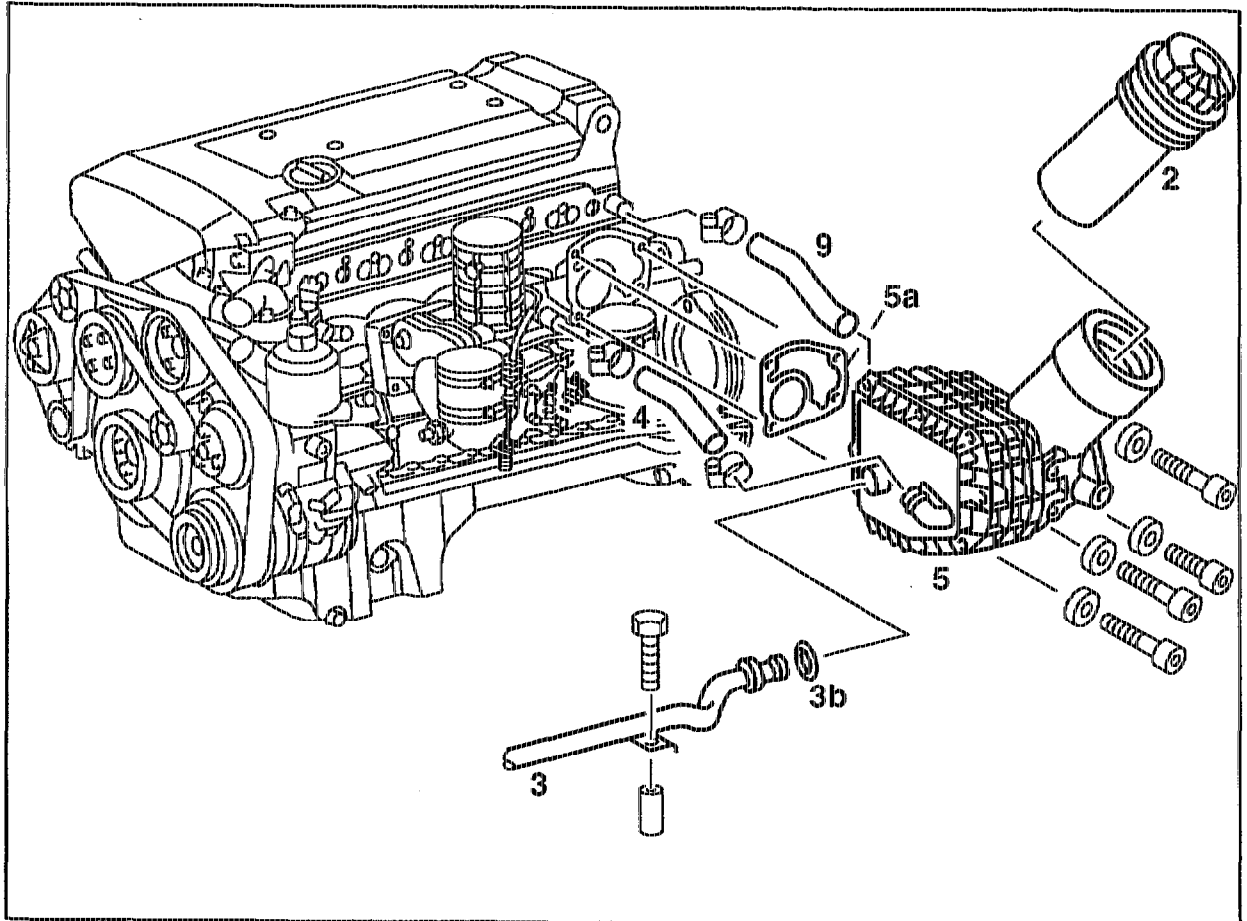

P18-5259-57

Screw cover (2) at oil filter (5)	unscrew, screw on so that the engine oil in the oil filter flows into the sump (18-0020).
Coolant at crankcase	drain (20-0100).
Coolant hose (9) at rear of cylinder head	take off, fit on.
Coolant pipe (3) at bottom part of resonance intake manifold	unbolt, bolt on.

Note

Replace O-ring (3b) at heat exchanger.

Coolant hose (4) from crankcase to
heat exchanger

take off, fit on.



Installation models 124 and 129:

It is essential to maintain clearance of the hose clips to the solenoid switch of the starter! Install bottom single-ear hose clip only when oil filter removed. Pay attention to position of top and bottom hose clips so that accelerator control linkage does not get jammed.

Oil filter (5) at crankcase

unbolt, bolt on (21 Nm).

Sealing surfaces

clean.

Gasket (5a)

replace.

Coolant

pour in (20-0100).

Cooling system

check for leaks (20-0170).

Oil level of engine

check, adjust to correct level (18-0020).

Engine

run, check for leaks.

Tightening torque in Nm

Oil filter at crankcase

21

Special tools

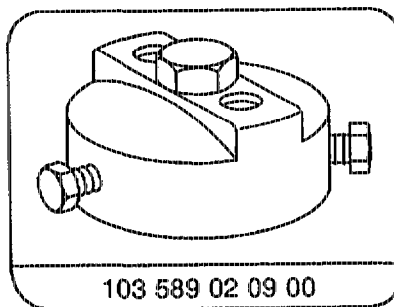
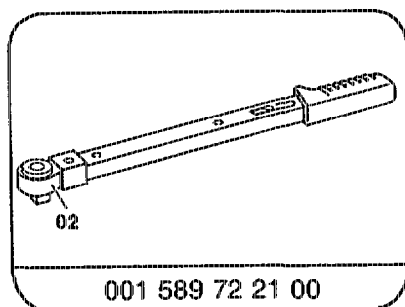

Commercially available tool

7 mm wrench socket hexagon on flexible
shaft for hose clip with worm drive

e. g. Hazet
42853 Remscheid
Order no. 426-7