

01-3100 Removing and installing oil sump

Preceding work:
Warning instructions when hood open (01-0085)

Operation no. of operation texts and work units or standard texts
and flat rates:
01-7500

A. Models 124, 129

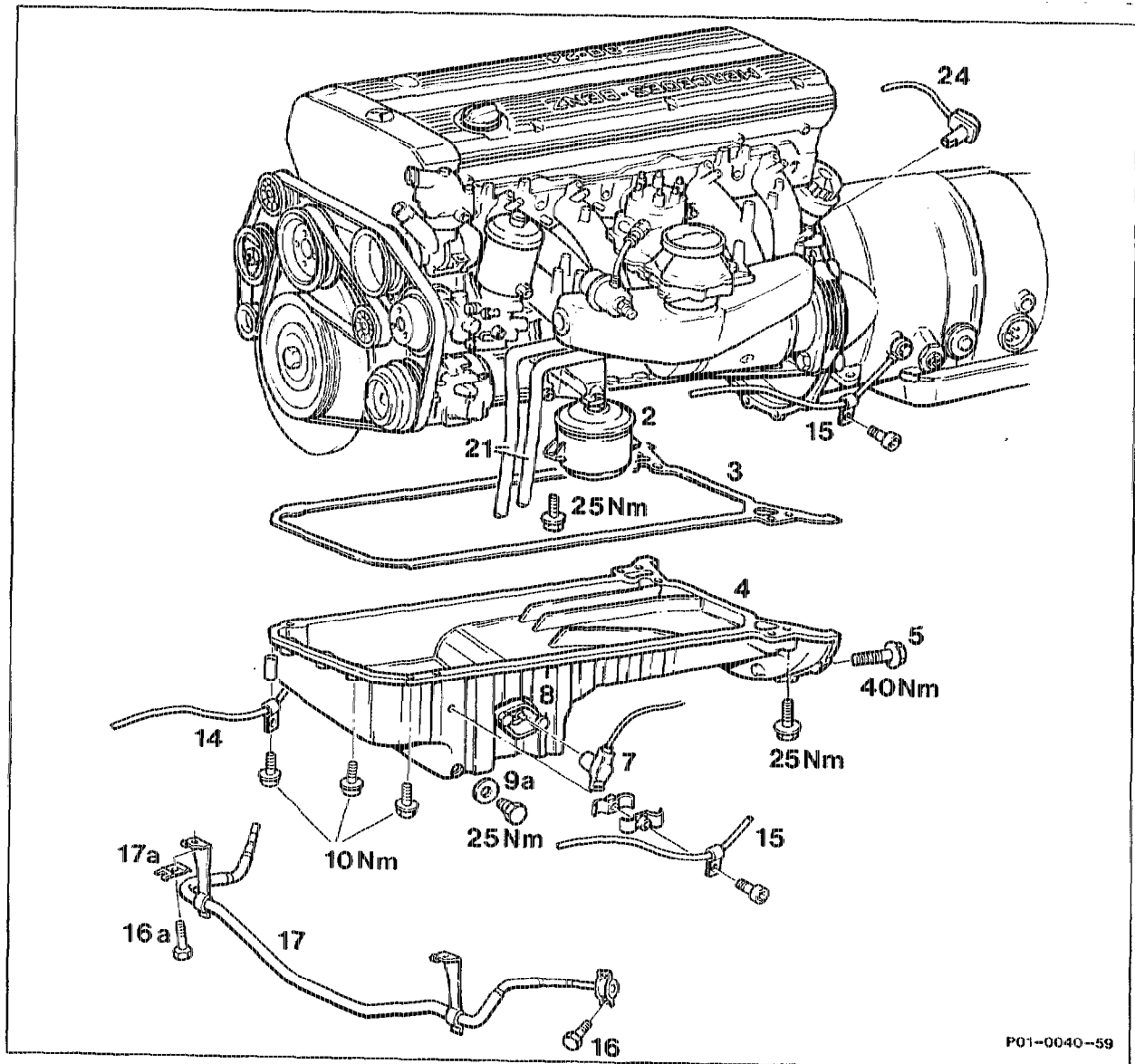

P01-0040-59

B. Model 140

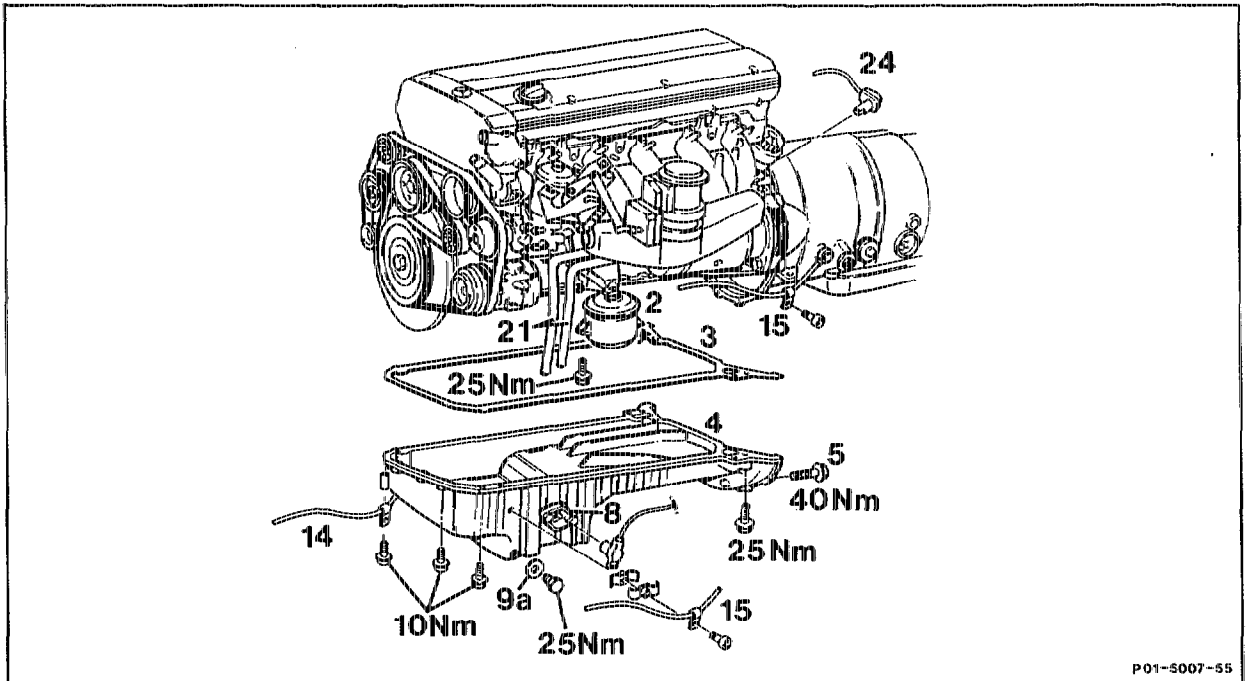

P01-5007-55

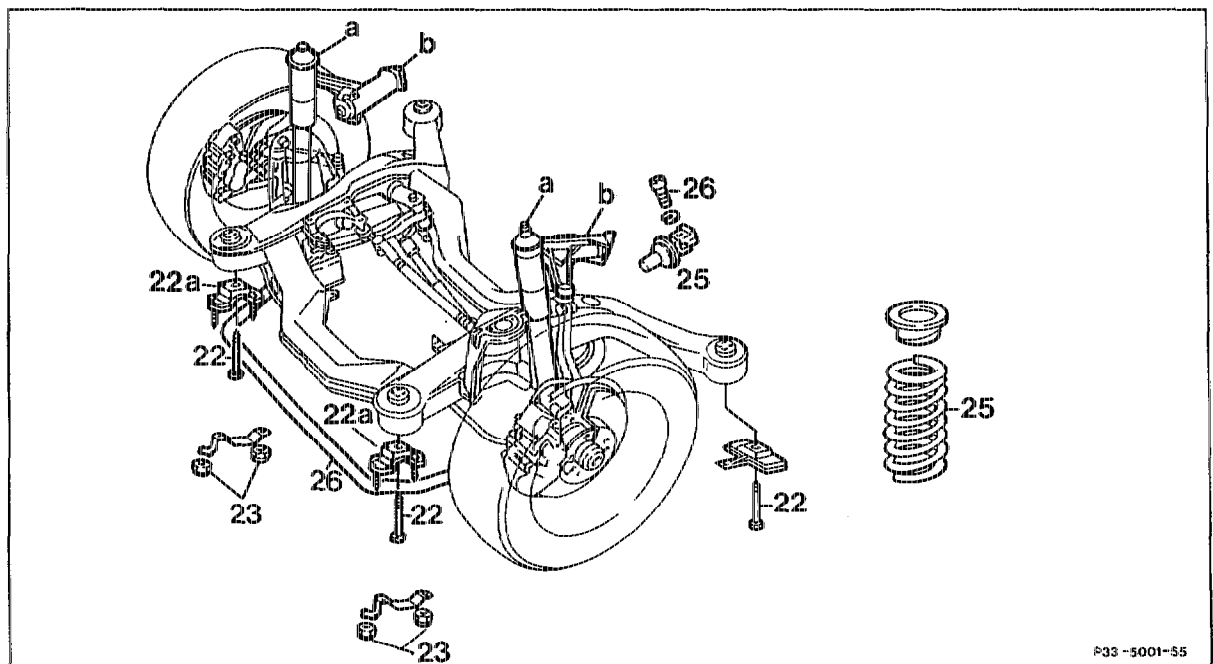

P33-5001-55

- | | |
|---------------------------------------|--|
| Ground cable at battery | disconnect, connect, encode radio, model 140 |
| Intake air scoop | normalize power windows. |
| Fan cover ring | remove, install. |
| Bottom engine compartment panel | detach, attach (steps 3 + 4). |
| | remove, install. |

Engine oil	drain, pour in, oil drain plug 25 Nm (18-0020).
Both front engine mounts	unbolt from below, bolt on, 25 Nm (22-2110).
Connector (7) of oil level switch	unplug at oil sump.
Connector (24), oil pressure	unplug, plug in (step 9).
Automatic transmission:	unbolt oil pipes (14, 15) at oil sump, bolt on.
Oil cooler pipes (21) at oil sump	unbolt, bolt on.
Model 124, 129:	remove torsion bar (17), install.
	Model 124 (32-300)
	Model 129 (AR32.20-0300B)
Model 140:	unbolt front torsion bar (17), lower and bolt on. (AR32.20-0300B).
	raise, lower (step 13).
Engine	raise with engine supporting bar, lower (step 16). (AR33.10-0100-01A).
Model 140: Engine	remove, install (32-200).
Model 140: Springs of front axle	unscrew, screw on (step 18).
Model 140: Bolt of steering coupling	support with vehicle jack adaptor (step 19).
Model 140: Front axle	unscrew, screw on (steps 20 + 21).
Model 140: Securing bolt of front axle	lower, partially remove, raise.
Model 140: Front axle	unbolt, take out (steps 22 + 23), bolt on.
Model 140: Oil sump	
Models 124, 129: Left drag link with steering damper	unbolt, detach, attach and bolt on (46-550).
Models 124, 129: Drag link	turn to rear right.
Models 124, 129: Oil sump (4)	unbolt at crankcase, bolt on (step 17). M6: 10 Nm, M8: 22 Nm.
Models 124, 129: Oil sump	take out forward and down, install.
Self-locking bolts and nuts	replace.
Gasket (3)	replace.
Engine	run, check for leaks.

Tightening torques in Nm

Oil drain plug to oil sump	25
Oil sump to crankcase	
M6 hexagon bolts	10
M8 hexagon bolts	25
M10 hexagon bolts	40
Oil lines to oil sump	10

Tightening torques of front axle see 33-100

Special tools

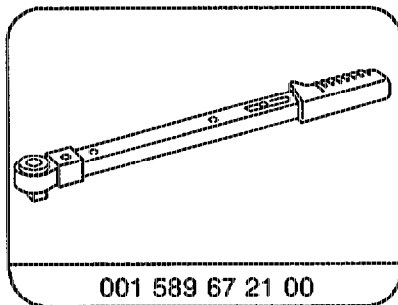
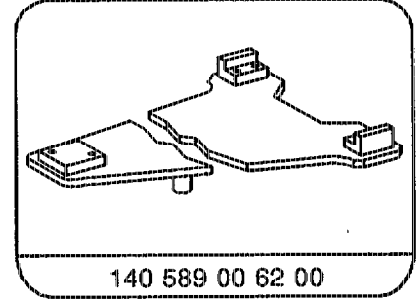
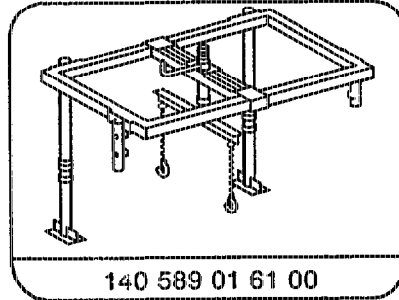
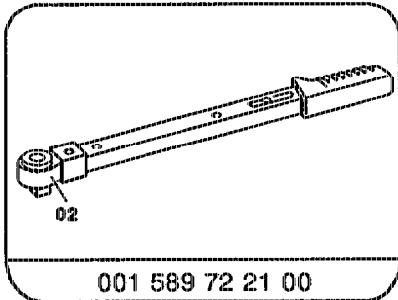

Commercially available tool

Wrench socket set 21 mm 6-sided, 1/2 " drive	e. g.	Hazet Werk 42853 Remscheid 1 Order no. 900-21
--	-------	---

Removing, installing

- 1 Disconnect ground cable at battery.

Installation note

Encode radio, model 140 normalize power windows.

- 2 Remove intake air scoop.

Models 124, 129

3 Remove fan cover ring by withdrawing locking pin and turning ring to the left. Place ring on the fan.

Installation note

Ensure that the four engaging points are correctly located.

4 Remove fan cowl.

5 Remove bottom engine compartment panel.

6 Drain engine oil (approx. 7.0 l). Replace gasket. Install oil drain plug.

7 Unscrew bolts on left and right engine mounts (a) from below. Unscrew nuts (b) of the torsion bar, lower torsion bar. (Model 140)
Replace self-locking nuts.

Model 140

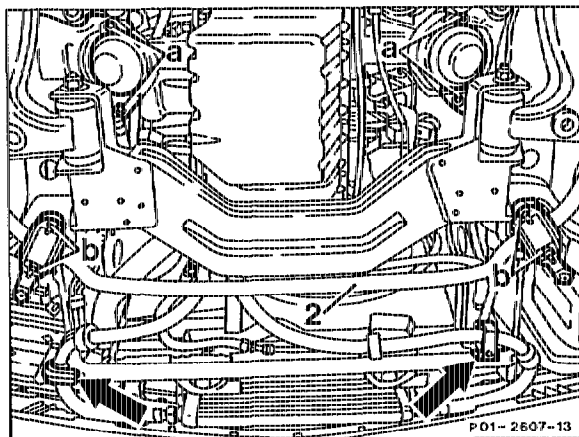

8 Detach connector of oil level switch on left of oil sump.

9 Detach oil pressure connector so that it is not damaged when raising the engine.

10 If automatic transmission fitted, unscrew oil pipes from oil sump.

11 Unscrew oil cooler pipes from oil sump.

12 Remove torsion bar.

Model 124: (32-300)

Model 129: (AR32.20-0300B)

Model 140: Unbolt torsion bar, lower.

13 Models 124, 129: Attach engine hoist to front lifting lug.

14 Models 124, 129: Unscrew drag link on left and steering damper on right, detach (46-550).

15 Models 124, 129: Turn drag link to the rear right.

16 Model 140: Raise engine with engine supporting bar (AR33.10-0100-01A).

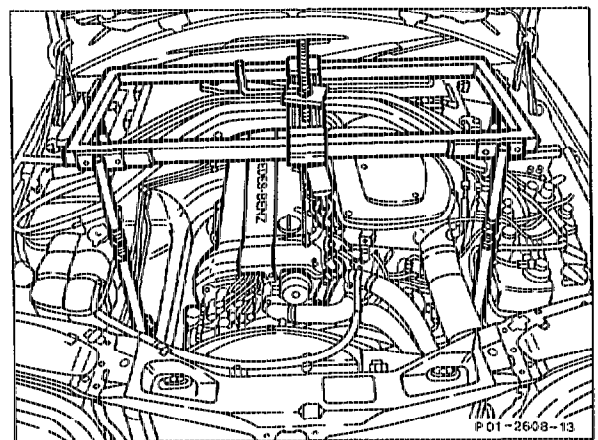

Model 140



Raise engine only far enough for cylinder head to be resting against component compartment wall.

17 Model 140: Remove springs of front axle, install (op. no. 32-200).

18 Model 140: Unscrew bolt (1) of steering coupling, push steering spindle up (arrow).

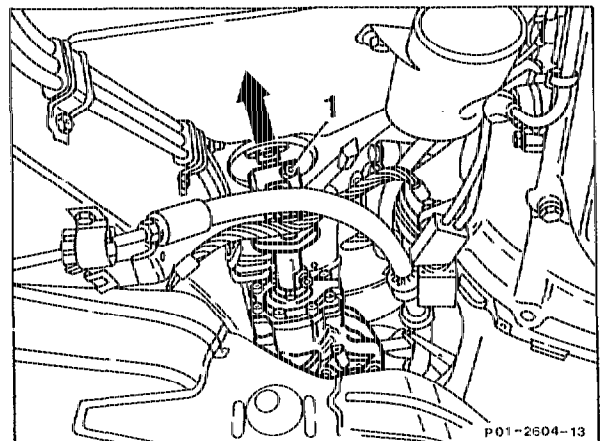

Model 140



19 Model 140: Support front axle with vehicle jack adaptor (1), unscrew plastic covers over the two rear mounting points of the front axle.

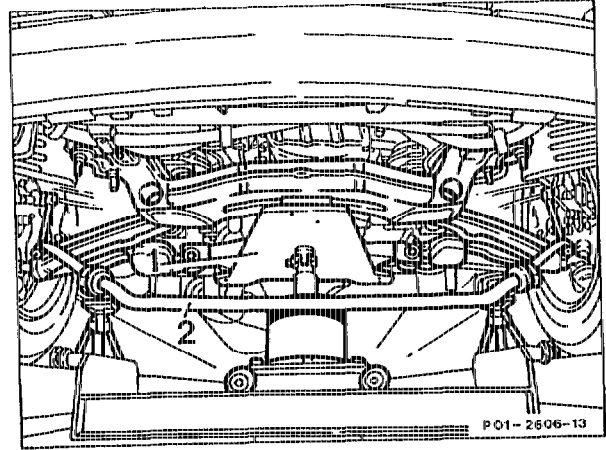

Model 140

20 Model 140: Unscrew 4 bolts of the main mounting points at the front axle (22) with 6-sided socket, waf 21 mm. Clean securing thread in the body with M14 × 1.5 tap to remove locking varnish of microencapsulated bolt threads. Use new bolts.

21 Model 140: Lower front axle until it is hanging clear at the shock absorbers and at the top control arms.



When lowering the front axle, pay attention to the routing of hoses and piping to avoid damaging them.

22 Model 140: Unbolt oil sump at crankcase.

23 Model 140: Pull front axle forward and down and remove oil sump to the front.



Do not damage dipstick guide tube (1) and strainer of oil pump (2).

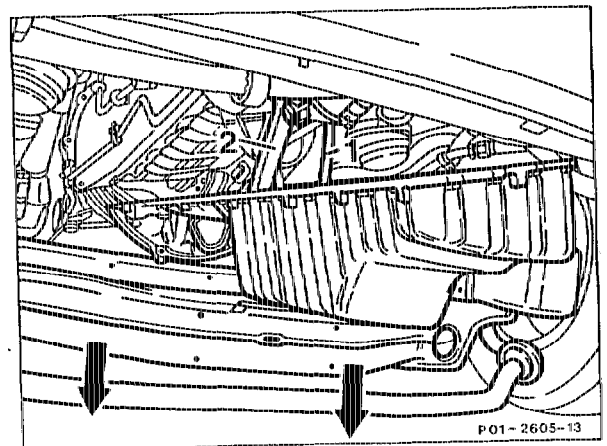

Model 140

24 Models 124, 129: Unbolt oil sump at crankcase.

25 Models 124, 129: Take out oil sump forward and down.

26 Replace gasket, replace self-locking nut.

27 Install in reverse order.

Installation note

Before bolting oil sump tight, align the contact surface to the transmission otherwise problems may result from noises and vibrations.

28 Run engine and check for leaks.

C. Model 202

Preceding work:
Bottom engine compartment panel removed
(Maintenance Manual).

Operation no. of operation texts and work units or standard texts
and flat rates:
01-7500

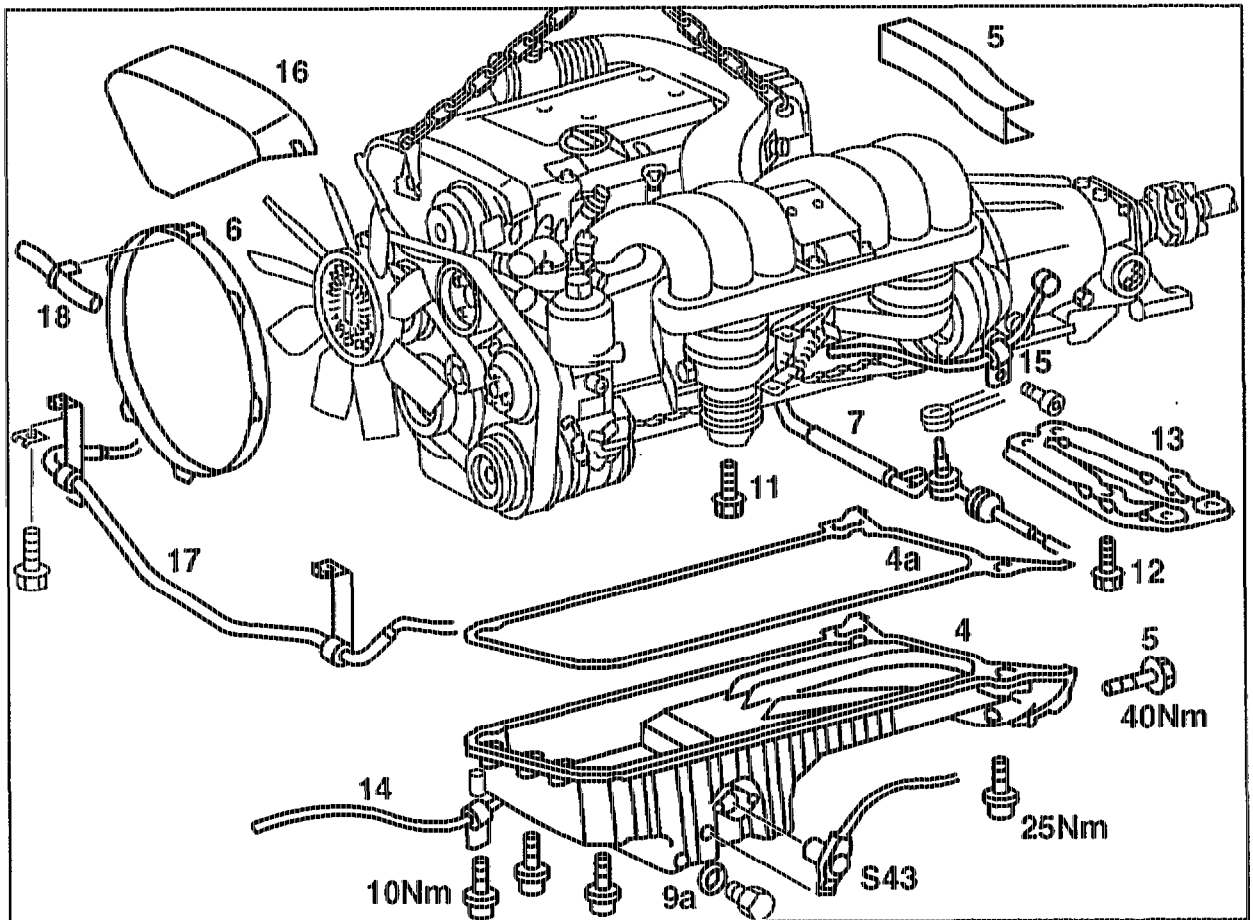

P01-5857-57

Engine oil	drain, pour in (18-0020).
Fan shroud ring (6) at fan shroud	take off, place over fan, fit on (20-3400).
Cover (5) of engine harness at component partition	take off, fit on.
Exhaust at exhaust manifold	take off, fit on.
Carrier for exhaust bracket at transmission	take off, fit on.
Coupling of oil level sensor (S43)	unplug, plug in.
If automatic transmission fitted:	unbolt oil pipes (14) and (15) at oil suj ^p (4), bolt on.
Drag link (7)	take off, fit on (AR46.40-0100C).
Front torsion bar (17)	remove, install (AR32.20-0300C).

Front engine mount bolts (11) at bottom	unscrew, screw on (22-2110).
Rear engine mount bolts (12) at engine carrier (13)	unscrew, screw on (22-2120).
Cover (16) at front	remove, install.
Engine hoist to front and rear engine	attach to front and rear engine lifting lugs.
Engine hoist	adjust so that engine is raised evenly at front and rear.
Engine	raise.
Oil sump bolts	unscrew, screw on.
Oil sump (4)	remove to the front.
Sealing surfaces	clean.
Gasket (4a)	replace.
Oil sump (4)	install; align to rear contact surface on transmission when performing this step.
	
	If the oil sump (4) is not aligned to the transmission, this may result in noises and vibration problems.
Engine	run and check for leaks.

Tightening torques in Nm

Oil sump to crankcase

M6 bolts	9
M8 bolts	21
M10 bolts	40

Special tools

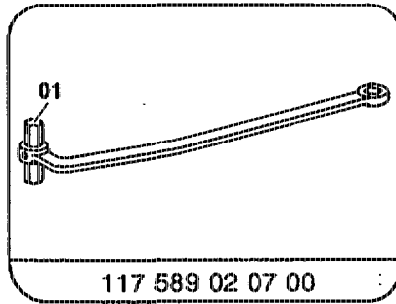
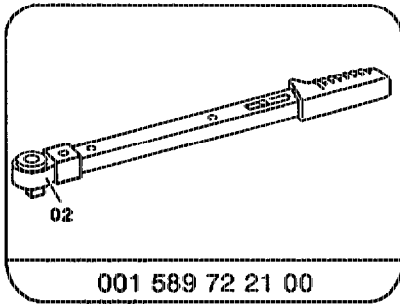

Commercially available tool

Removing device components model 3188
(lifting capacity 500 kg)

e. g. Wilbär GmbH
und Co KG
42853 Remscheid

D. Model 210

Preceding work:
Bottom engine compartment panel removed
(Maintenance Manual).

Operation no. of operation texts and work units or standard texts
and flat rates:
01-7500

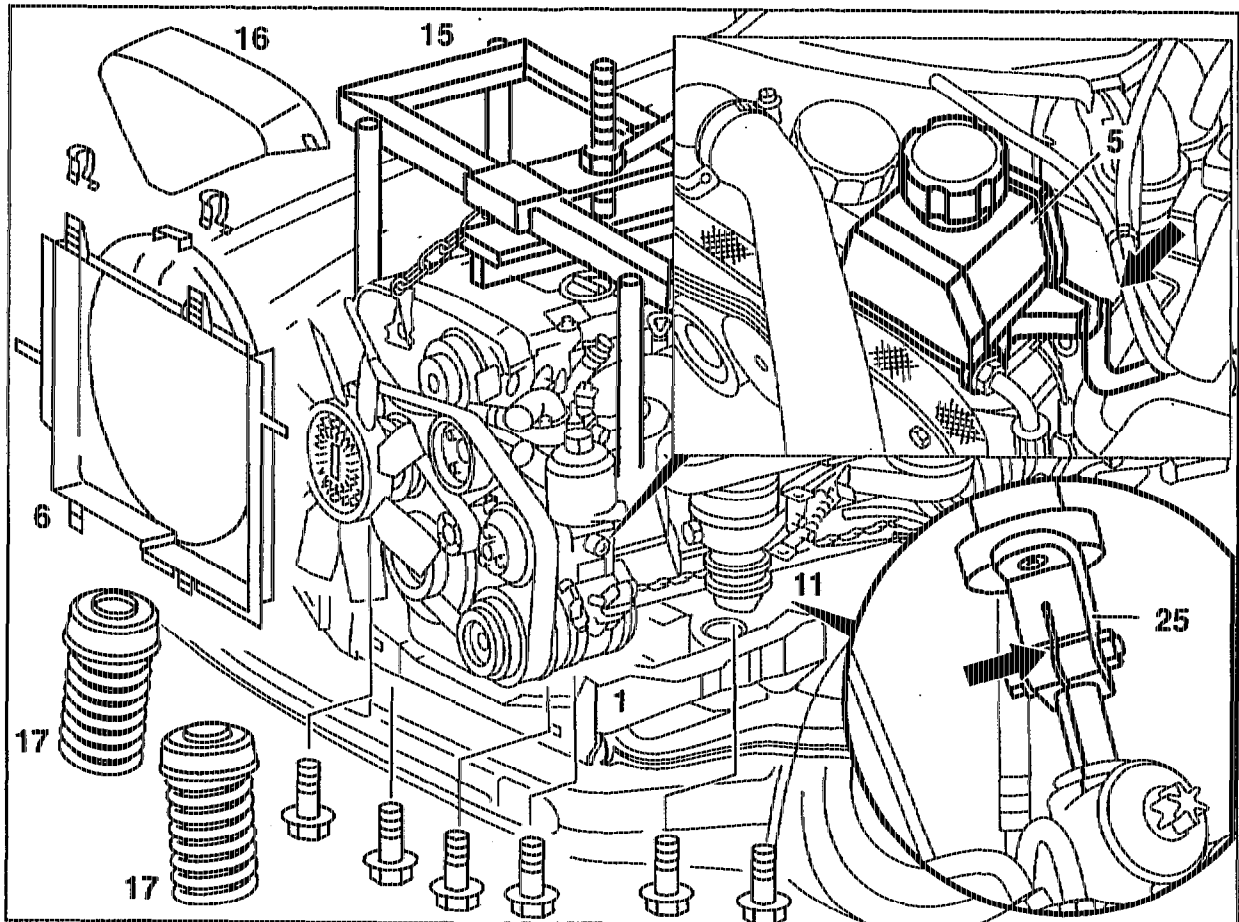

P01.45-0217-57

Ground cable at battery	disconnect, connect.
Engine oil	Installation note Encode radio.
Fan shroud (6)	drain, pour in (18-0020).
Fluid	take off, place over fan, fit on (20-3400).
Suction pipe (arrow) at power steering pump (5) .	extract from reservoir of power steering pump (5), pour in, bleed power steering pump (AR46.30-0010B).
Cover (16)	unbolt, bolt on.
Front springs (17)	pull off, fit on.
Bottom engine mount (11)	remove (AR32.20-0200C).
	unbolt, bolt on (22-2210).

Engine supporting bar (15)	fit on, take off (AR 33.10-0100-01A).
Engine	raise, lower.
Steering coupling (25)	unbolt, bolt on (25 Nm).
Front suspension support (1)	support with inspection pit or assembly lift (AR33.10-0100-03A).
Front suspension carrier (1)	unbolt, bolt on (120 Nm).
Front suspension carrier (1)	lower, raise.

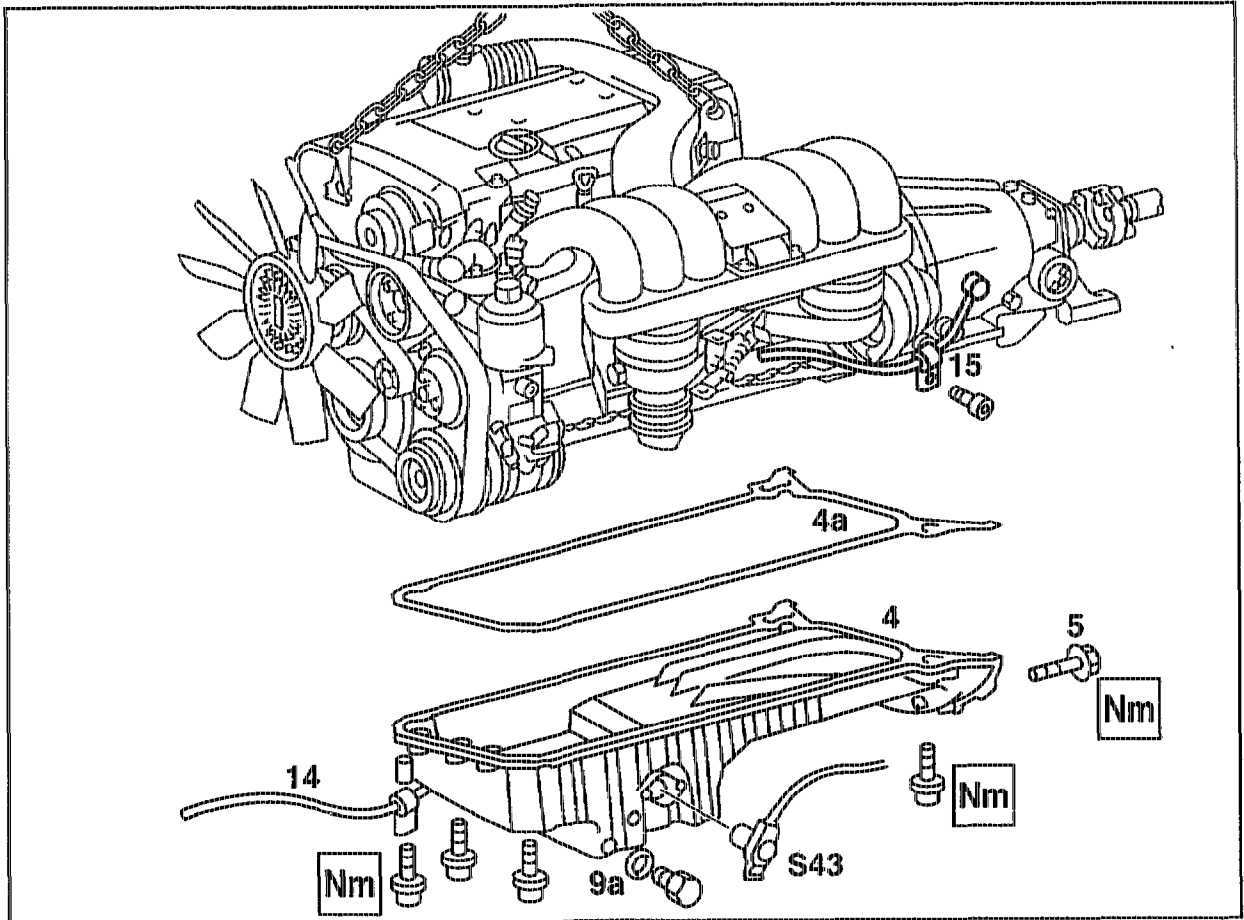

P01.45-0218-57

If automatic transmission fitted:	unbolt oil pipes (14 and 15), bolt on.
Connector (S43) of oil level indicator	unplug, plug in.
Oil sump (4)	unbolt, bolt on.
Oil sump (4)	remove to the front.
Sealing surfaces	clean.
Gasket (4a)	replace.

Oil sump (4) install and align to rear contact surface at transmission.



If oil sump (4) is not aligned to the transmission, this can cause problems with noises and vibrations.

Leaks check with engine running.

Tightening torque in Nm

Oil sump to crankcase

M6 bolts	9
M8 bolts	21
M10 bolts	40

Special tools

