

## 01-2220 Removing and installing end cover

Preceding work:

Manual transmission: two-mass flywheel removed (03-4620)

Automatic transmission: driven plate removed (03-4100)

Operation no. of operation texts and work units or standard texts  
and flat rates:

01-8913

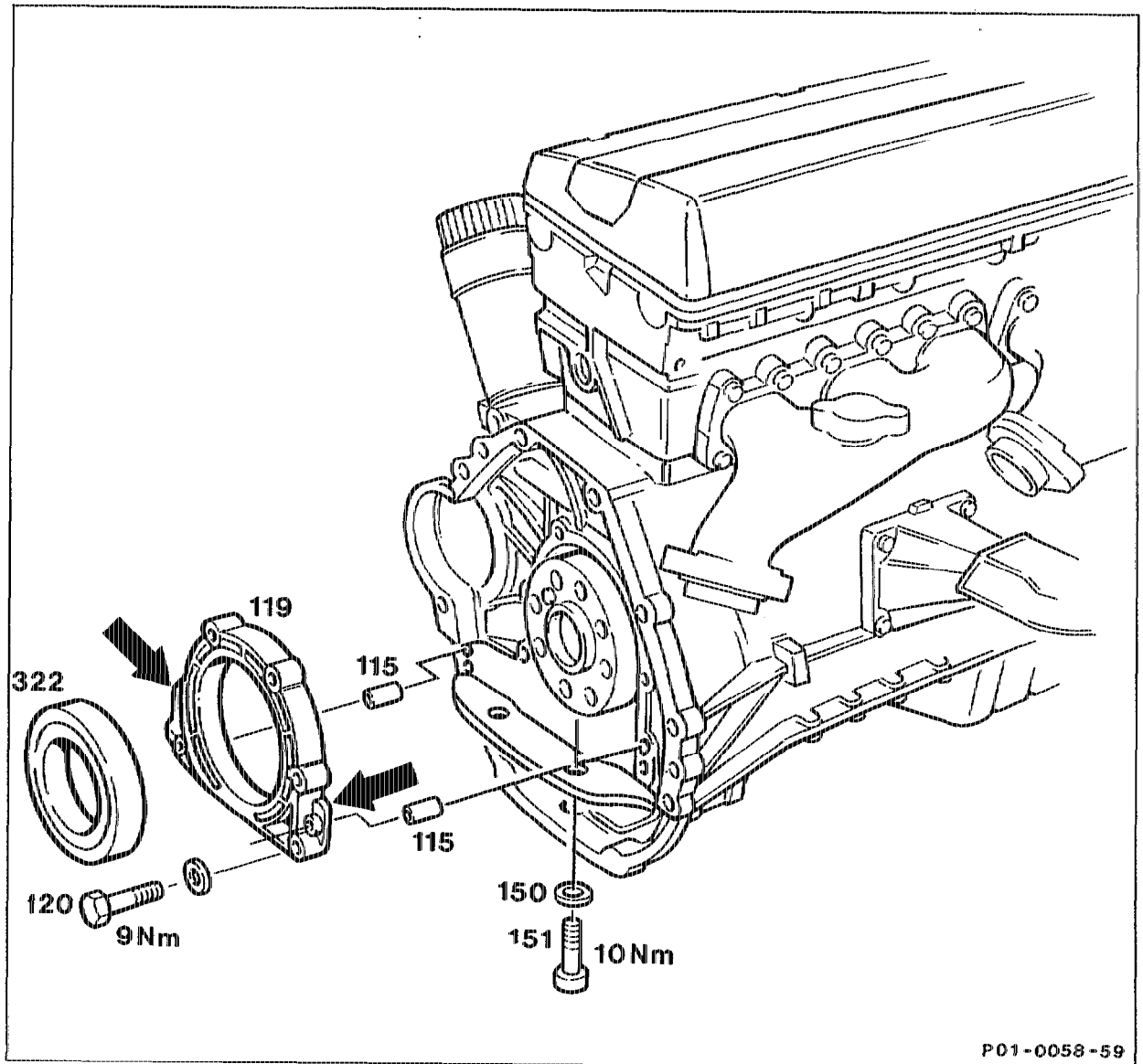

P01-0058-59

End cover (119) together with radial shaft

seal (322) .....

unbolt.

End cover .....

press off at plates (arrows), pay attention to oil  
sump gasket!

Sealing surfaces .....

clean.

Contact surface of radial shaft seal at crankshaft	examine. If contact surface has grooves, remove radial seal (03-3270) and install repair size radial seal with sealing lip offset to the inside.
End cover	coat sealing surface with sealant 001 989 45 20 10.
Sealing lip of radial shaft seal	coat with engine oil.
<b>⚠ Do not use grease. Grease prevents the return flow swirl on the sealing lip transporting back the engine oil.</b>	
End cover (119)	press on over insertion tool together with radial seal (320).
Bolts (120)	tighten first of all, 9 Nm.
Bolts (151)	tighten, 10 Nm.
Rear of engine	check for leaks (01-2240).

**Tightening torques in Nm**

End cover to rear of crankcase	9
Securing bolts to oil sump	10

**Special tools**

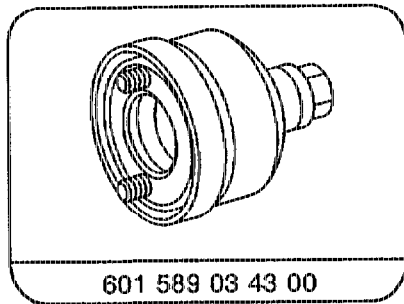
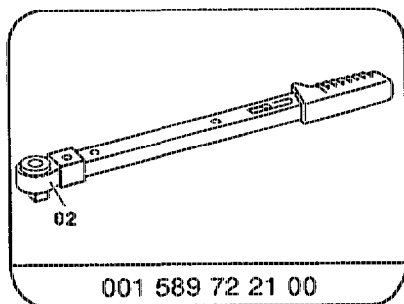

**Note**

The end cover is sealed with sealing compound at the crankcase and centred with 2 dowel pins. In addition, it is bolted to the oil sump and sealed at the bottom by the oil sump gasket.

There must not be any scoring or unevennesses in the sealing surface of the end cover and of the crankcase.

End covers with integrated radial shaft seal (version B) should be replaced by the end cover with press-fitted radial shaft seal (version A) when performing repairs.

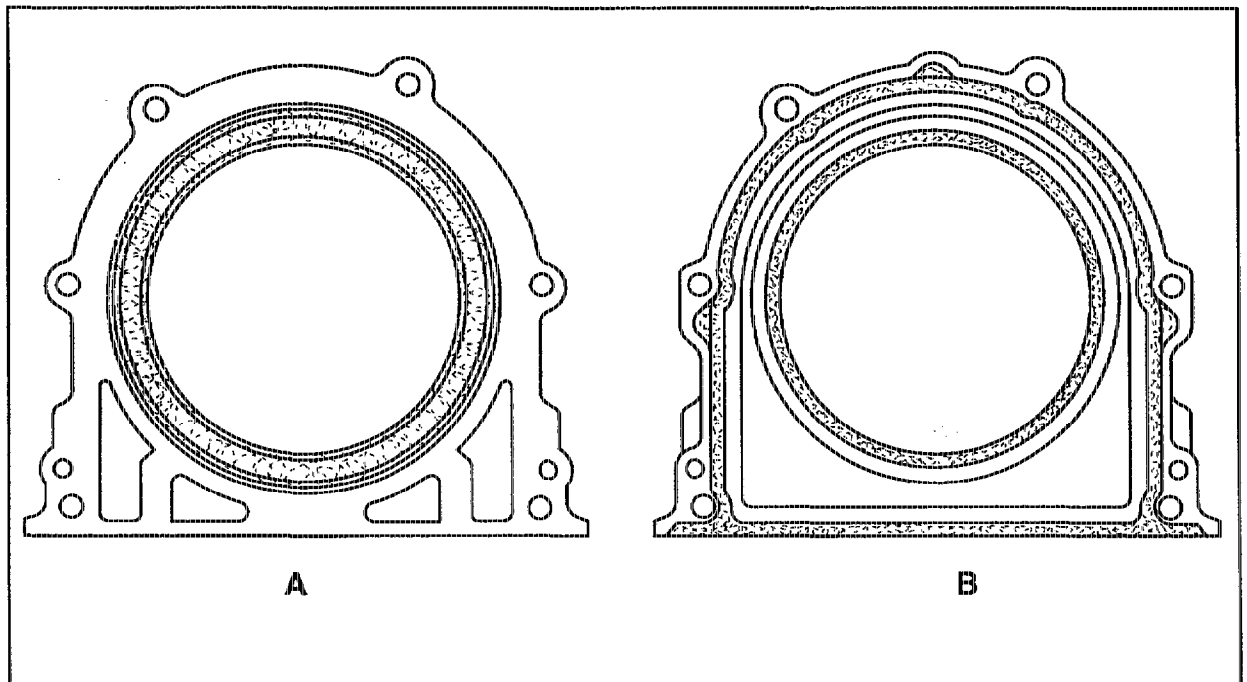

P01.40-0238-55

- A End cover with press-fitted radial shaft seal
- B End cover with integrated radial shaft seal and vulcanized-on sealing lip