

01-0500 Removing and installing cylinder head cover

Preceding work:
Air cleaner removed (09-0015).

Operation no. of operation texts and work units or standard texts
and flat rates:
01-5070

A. Engines with CFI (continuous fuel injection system, electronic)

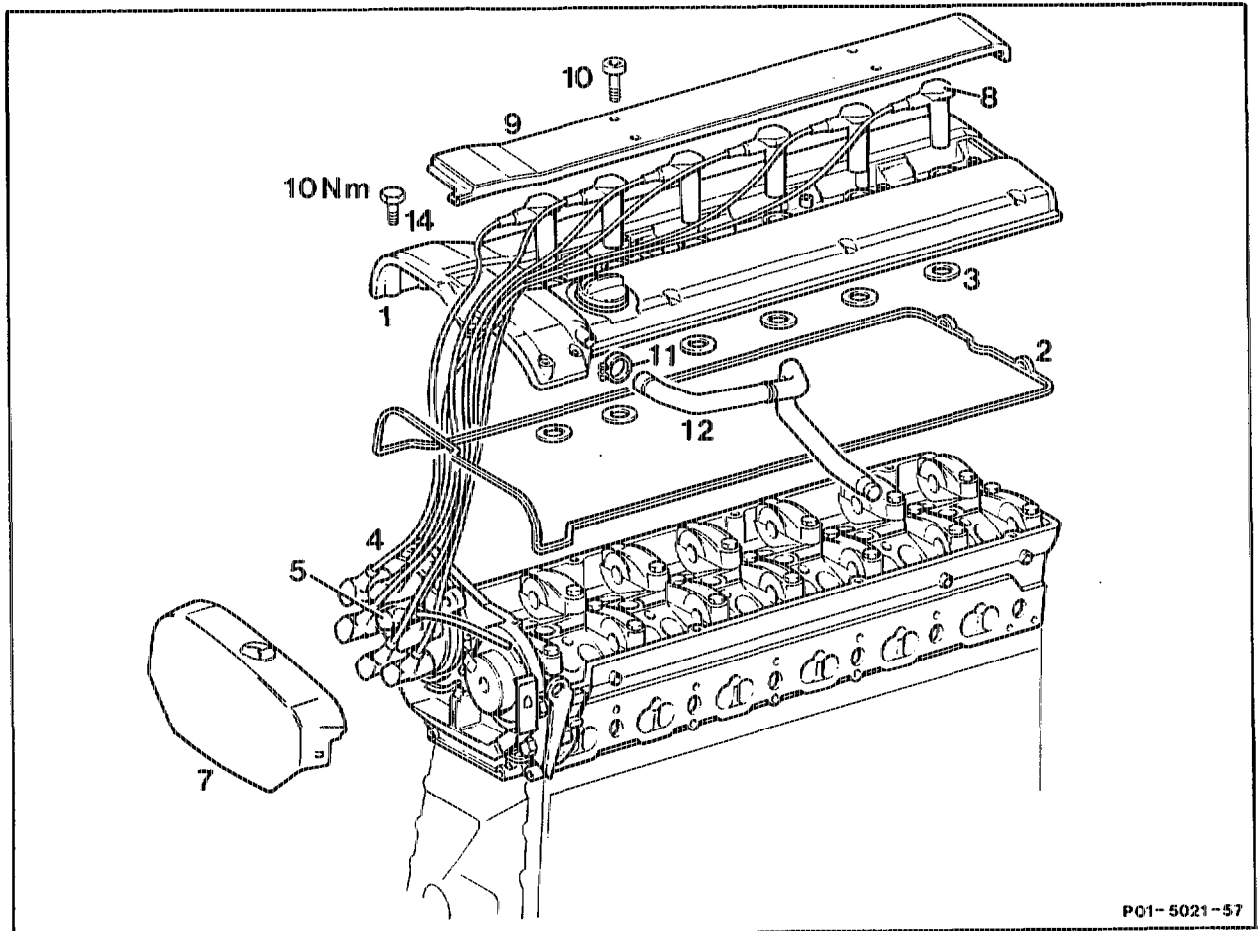

PO1-5021-57

Model 124:	take off cover of engine wiring harness at component compartment partition, fit on.
Engine vent hose (12) at cylinder head cover ...	detach, fit on.
Covers (7 + 9) over spark plug cables	take off, install.
Spark plug connector (8)	disconnect, plug in.
Arrangement of spark plug connectors on cylinder head cover	observe as indicated in the diagram.
Bolts (14) of cylinder head cover	unscrew, screw on (10 Nm).
Cylinder head cover with gasket (2) and shaft seals (3)	take off, fit on, replace only together.
Engine	run.
Leaktightness	check, particularly at rear.

Special tool

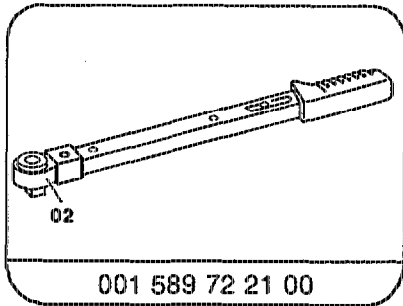

Ensure that lap joints of valve cover seal at rear (arrows) are installed correctly.

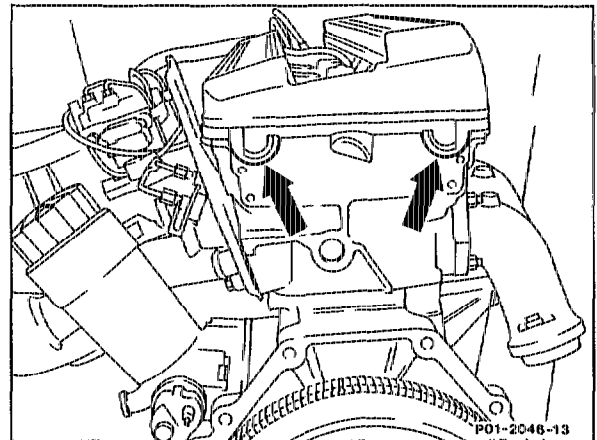

Use version B only together with front cover with cast part no. 104 016 07 06.

Production breakpoint of version B as of 02/1990.

Engine 104 980 10 001 729
12 007 925
104 981 10 000 340
12 002 895

Engine 104.98
A First version
B Second version

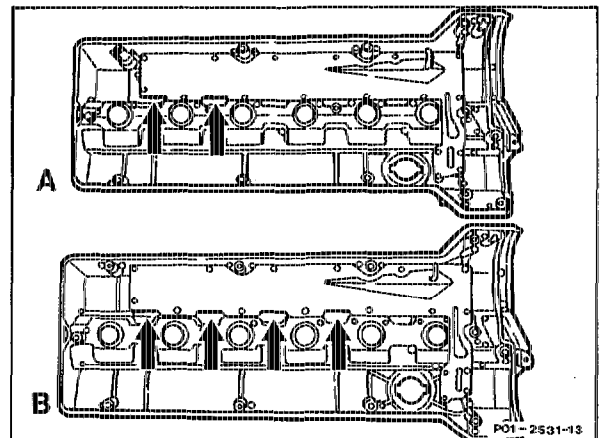

B. Engines with LH-SFI (LH sequential multiport fuel injection system)

Preceding work:
Ignition coils removed (AR15.12-2003G)

Operation no. of operation texts and work units or standard texts
and flat rates:
01-5014

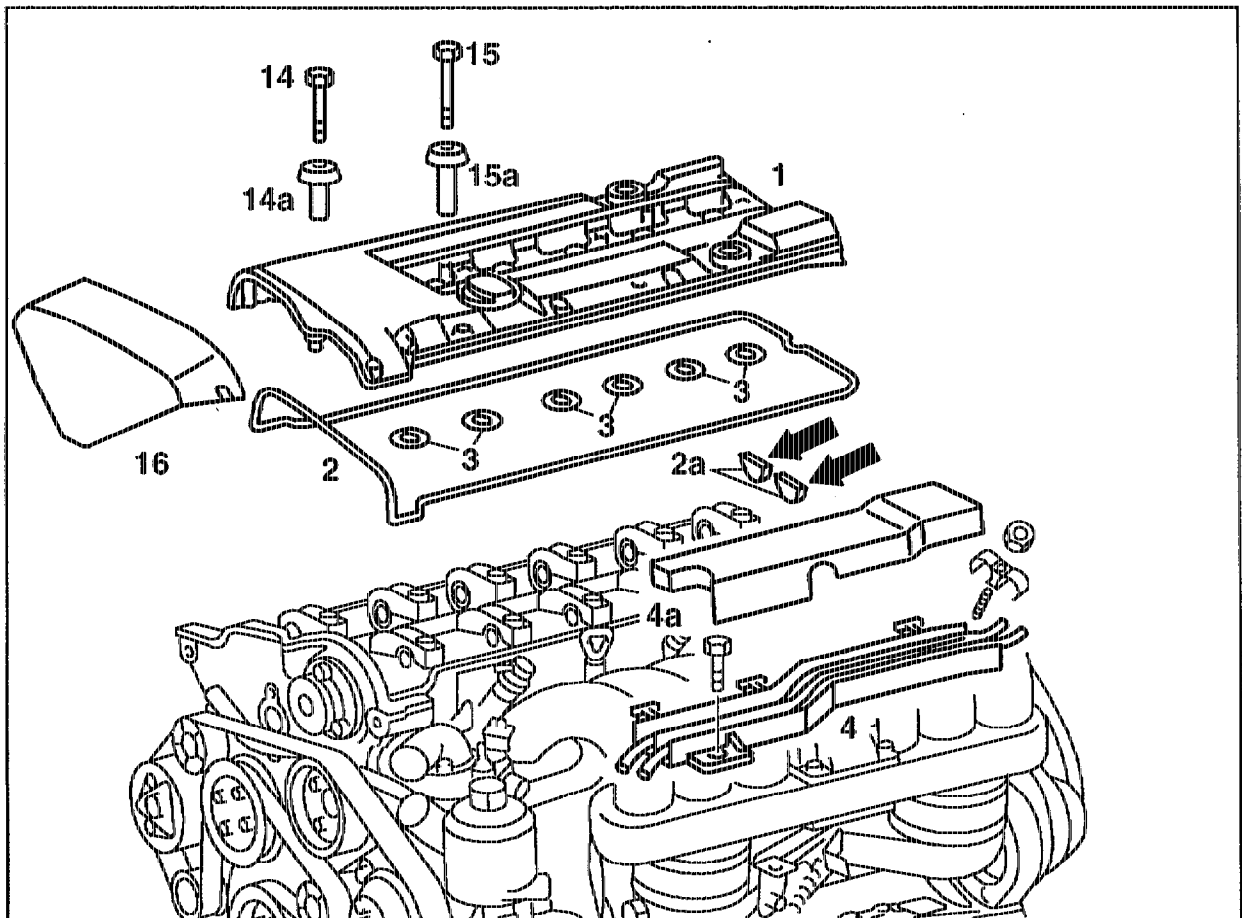

P01-5848-57

Cover (16)	remove, install.
Cable duct (4)	unscrew, place to the side, install.
Bolts (14) and (15) with spacer sleeves (14a) and (15a)	unscrew, screw on; see bolt diagram (10 Nm).
Cylinder head cover (1) with gaskets (2) and (2a) and shaft seals (3)	take off, fit on; replace only together.

Note

Remove grease from sealing groove and existing re-usable gasket (2) so that the gasket (2) adheres better to the cylinder head cover (1). (Do not grease new gasket!).

Engine	run.
Leaktightness	check, particularly at rear (arrows) at the gaskets (2a) and in the spark plug recesses.

Special tool

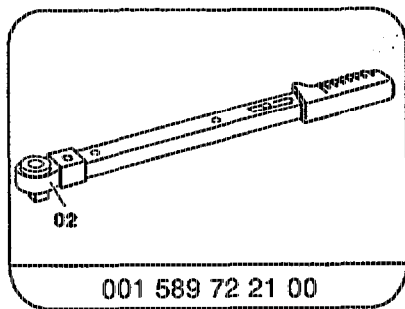

Bolt diagram

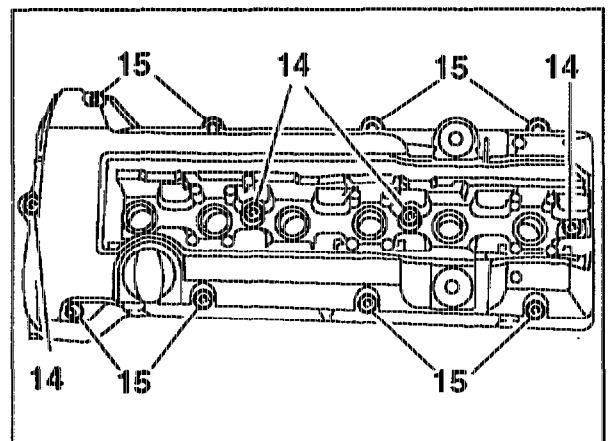

- 14 M6 × 50 bolt + washer
- 15 M6 × 65 bolt + washer

P01-5849-13

C. Engines with HFM-SFI (HFM sequential multiport fuel injection/ ignition system)

Preceding work:
Ignition coils removed (AR15.12-2003G)

Operation no. of operation texts and work units or standard texts
and flat rates:
01-5014

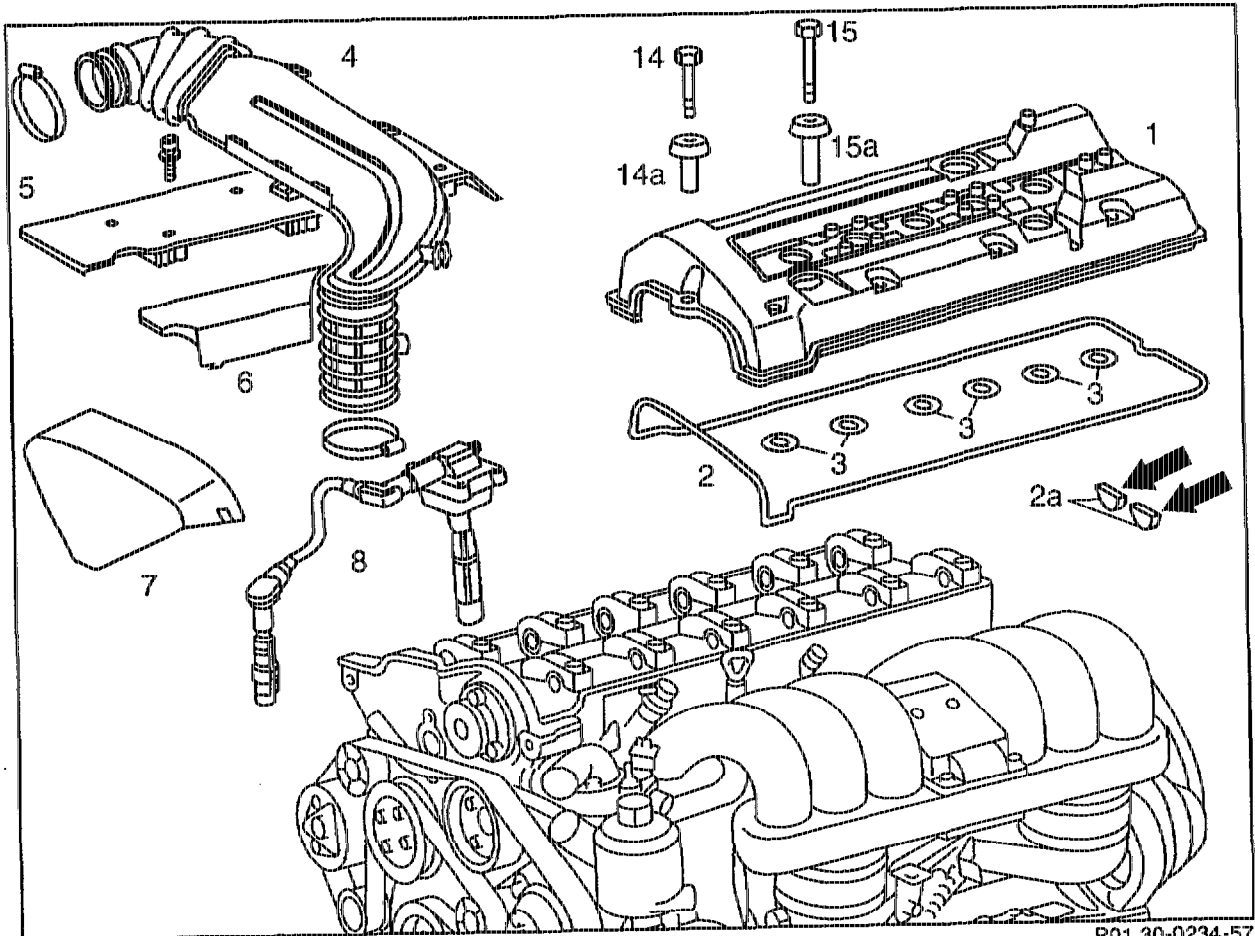

P01.30-0234-57

Cover (7) and (6)	remove, install.
Bolts (14) and (15) with spacer sleeves (14a) and (15a)	unscrew, screw on; see bolt diagram (10 Nm).
Cylinder head cover (1) with gaskets (2) and (2a) and shaft seals (3)	take off, fit on; replace only together.

Note

Remove grease from sealing groove and existing re-usable gasket (2) so that the gasket (2) adheres better to the cylinder head cover (1). (Do not grease new gasket!).

Engine	run.
Leaktightness	check, particularly at rear (arrows) at the gaskets (2a) and in the spark plug recesses.