

01-0420 Removing and Installing engine air admission housing (combination support)

Operation no. of operation texts and work units or standard texts and flat rates

A Model 129

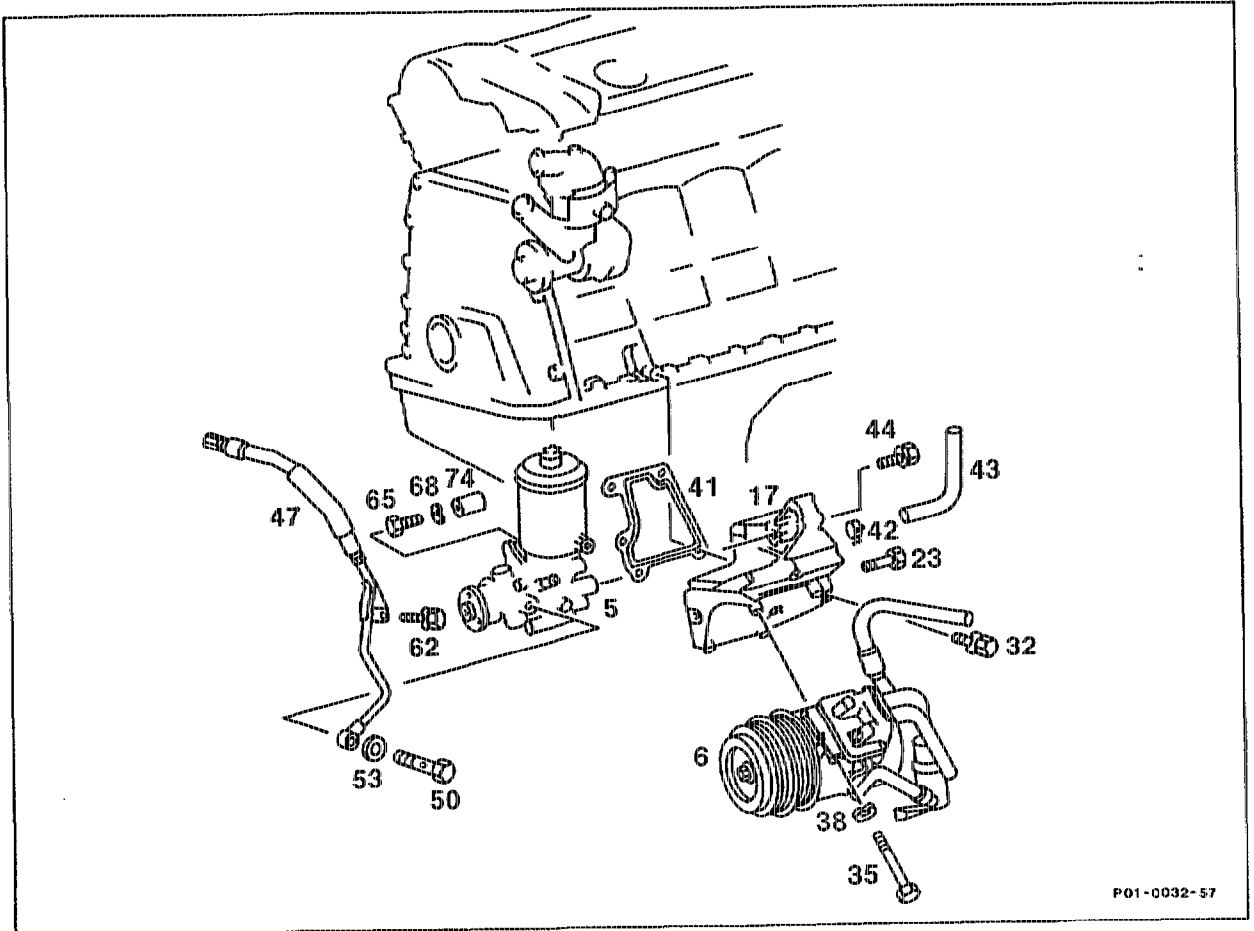

P01-0032-57

Engine compartment panel, bottom and side left	unbolt, bolt on.
Poly V-belt tensioning device	remove, install (13-3200).
Pressure pipe of power steering pump (47)	disconnect, connect.
Power steering pump (5)	unbolt, place to the side, bolt on.
AC compressor (6) with piping/wiring connected ..	unbolt, place to the side, bolt on (step 5).
Air admission hose (43) of combination supports ..	take off, fit on (step 6).
Engine air admission housing (17)	remove, clean, install (step 7).
Gasket (41)	replace.
Engine	run.
Leaktightness	check.

Removing, installing

- 1 Unscrew engine compartment panel at bottom and at right side.
- 2 Remove V-belt tensioning device (13-3200).
- 3 Unbolt delivery pipe from power steering pump.
- 4 Unbolt power steering pump from bracket and place to the side.
- 5 Remove AC compressor with piping/wiring connected; unscrew bolts (35) for this step.
- 6 Detach air admission hose (43) from combination support (17).

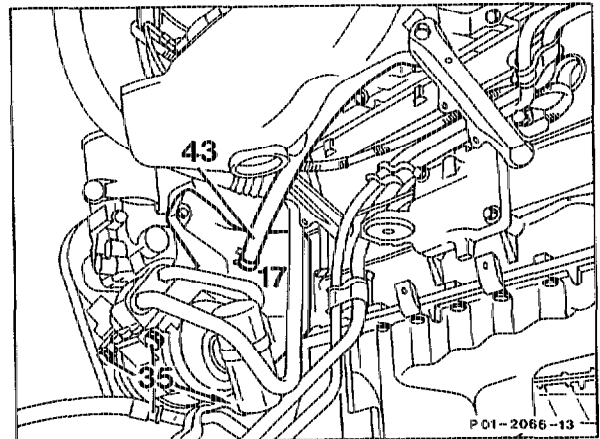

- 7 Remove engine air admission housing by unscrewing bolts (32).
- 8 Clean engine air admission housing and sealing surface of engine block.
- 9 Replace gasket.

Note

As of 7/95 the gasket has been modified. As a result of the modified gasket, the dowel sleeves for fixing the engine air admission housing in place have been discontinued. On engines with dowel sleeves, remove dowel sleeves and install new gasket without dowel sleeves.

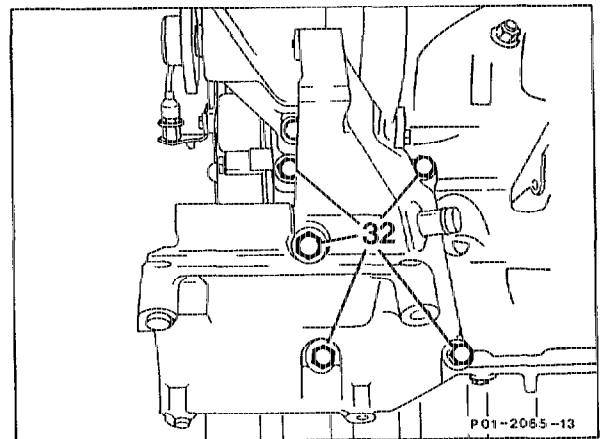

- 10 Assemble in the reverse order.
- 11 Run engine, check for leaks.

B. Models 202, 210

Preceding work:
 Model 202: Radiator removed (20-4200).
 Tensioning device removed (13-3200).

Operation no. of operation texts and work units or standard texts
 and flat rates:

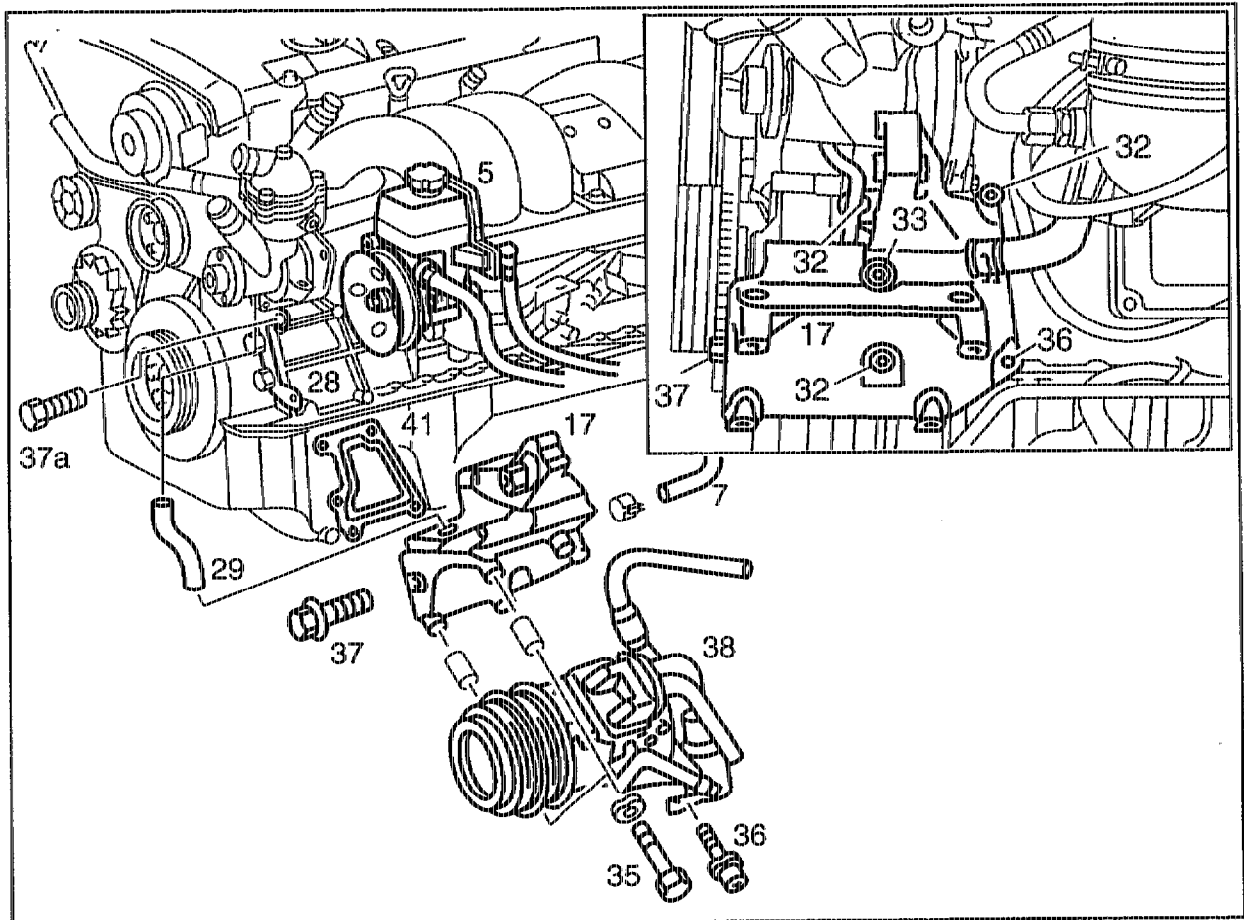

P01.20-0206-57

32	M8 x 40 hexagon socket bolt + washer	37	M8 x 40 hexagon bolt + washer
33	M8 x 95 hexagon socket bolt + washer	37a	M8 x 20 hexagon bolt + washer
35	M8 x 95 hexagon bolt + washer		
36	M8 x 45 hexagon socket bolt + washer (together with AC compressor piping)		

Power steering pump (5) with piping/wiring connected	unbolt, swivel to the side, bolt on.
Bracket (28) at combination support (17)	unscrew, screw on (21 Nm).
If AC fitted:	unbolt AC compressor (38) with piping connected, swivel to the side, install.
Vent pipe (7) at combination support	detach, fit on.
Coolant drain pipe (29)	remove, install.

Combination support (17)	unscrew, clean, screw on (21 Nm).
Gasket (41)	replace.
	Note
	As of 7/95 the gasket has been modified.
	As a result of the modified gasket, the dowel sleeves for fixing the engine air admission housing in place have been discontinued.
	On engines with dowel sleeves, remove dowel sleeves and install new gasket without dowel sleeves.
Leaktightness	check with engine running.

Tightening torques in Nm

Engine air admission housing to crankcase	21
---	----
