

18-2120 Replacing and riveting oil pump chain

Preceding work:

Oil sump removed (01-3100).

Spark plugs removed (15-1031).

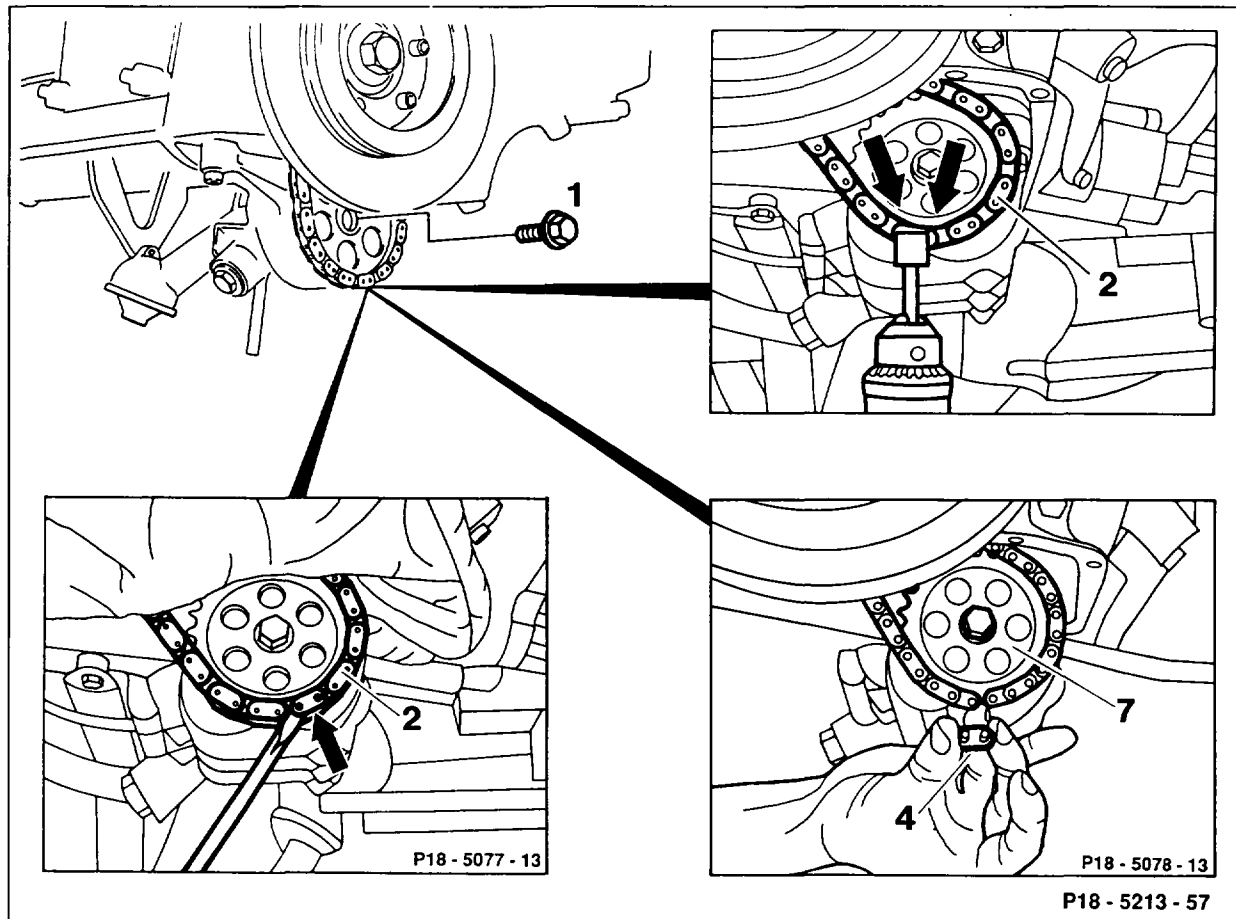

Bolt (1) of oil pump gear (7)	slacken
Chain pins of oil pump chain (2)	grind open (arrows)
Plate of oil pump chain (2)	lever off with a screwdriver
New separated oil pump chain	connect to old pump chain with a riveted link (4) part no. 000 997 14 98
Crankshaft in direction of rotation of engine	rotate with wrench socket; draw in new oil pump chain
New oil pump chain	connect to riveted link (4)
Oil pump gear (7)	unbolt, remove



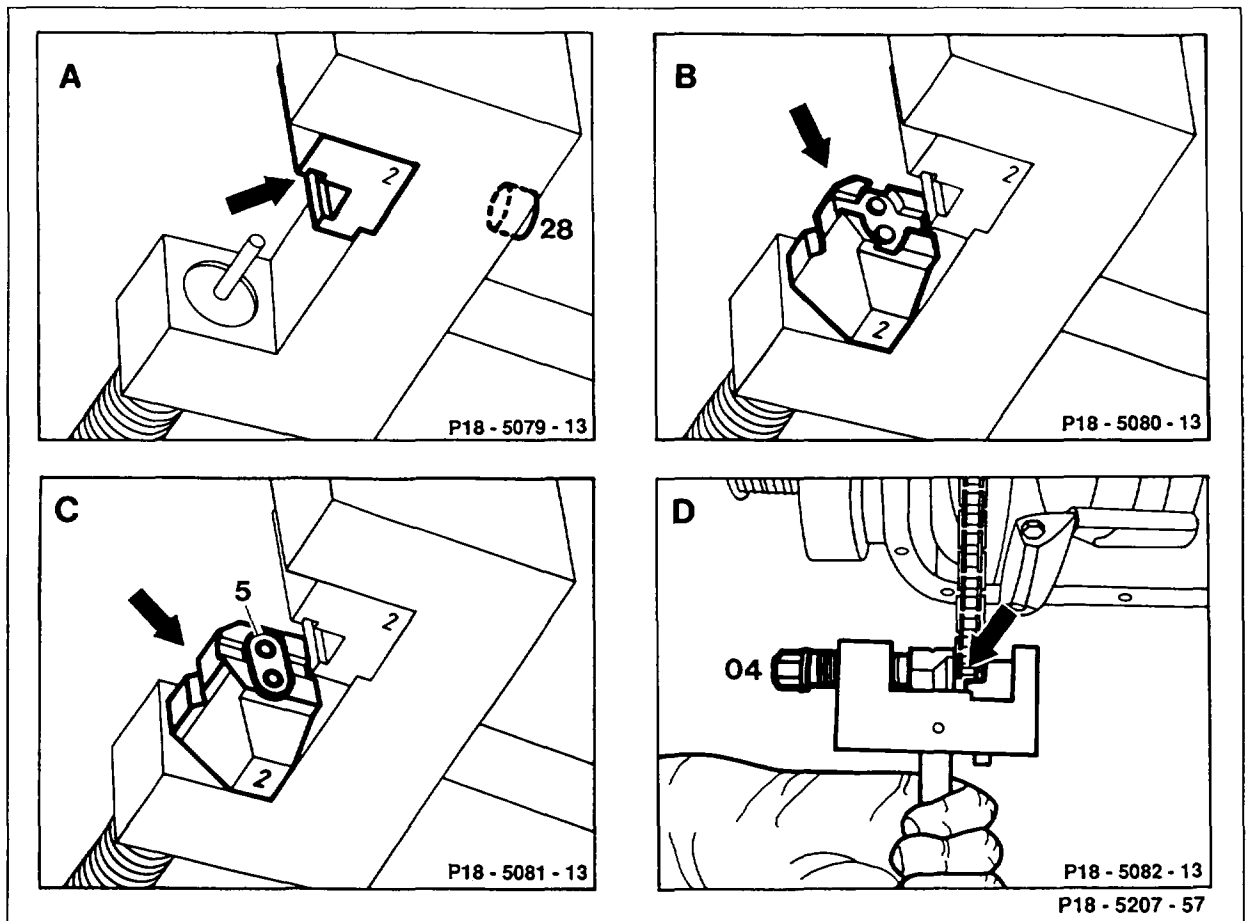

Jaws with the figure 2	insert into fitting tool 000 589 58 43 00 and screw on with screw (28) (fig. A)
Moving thrust piece with the figure 2	insert into fitting tool (fig. B)
Outer plate (5)	insert into moving thrust piece (fig. C)
Web (arrow)	fit onto both rollers of riveted link (fig. D)
Spindle (04)	screw in until tight resistance felt (fig. D)
Fitting tool	remove

Note
 When screwing in spindle, ensure that the pins of the riveted link (4) are guided into the holes of the plate (5) (arrow) (fig. D)

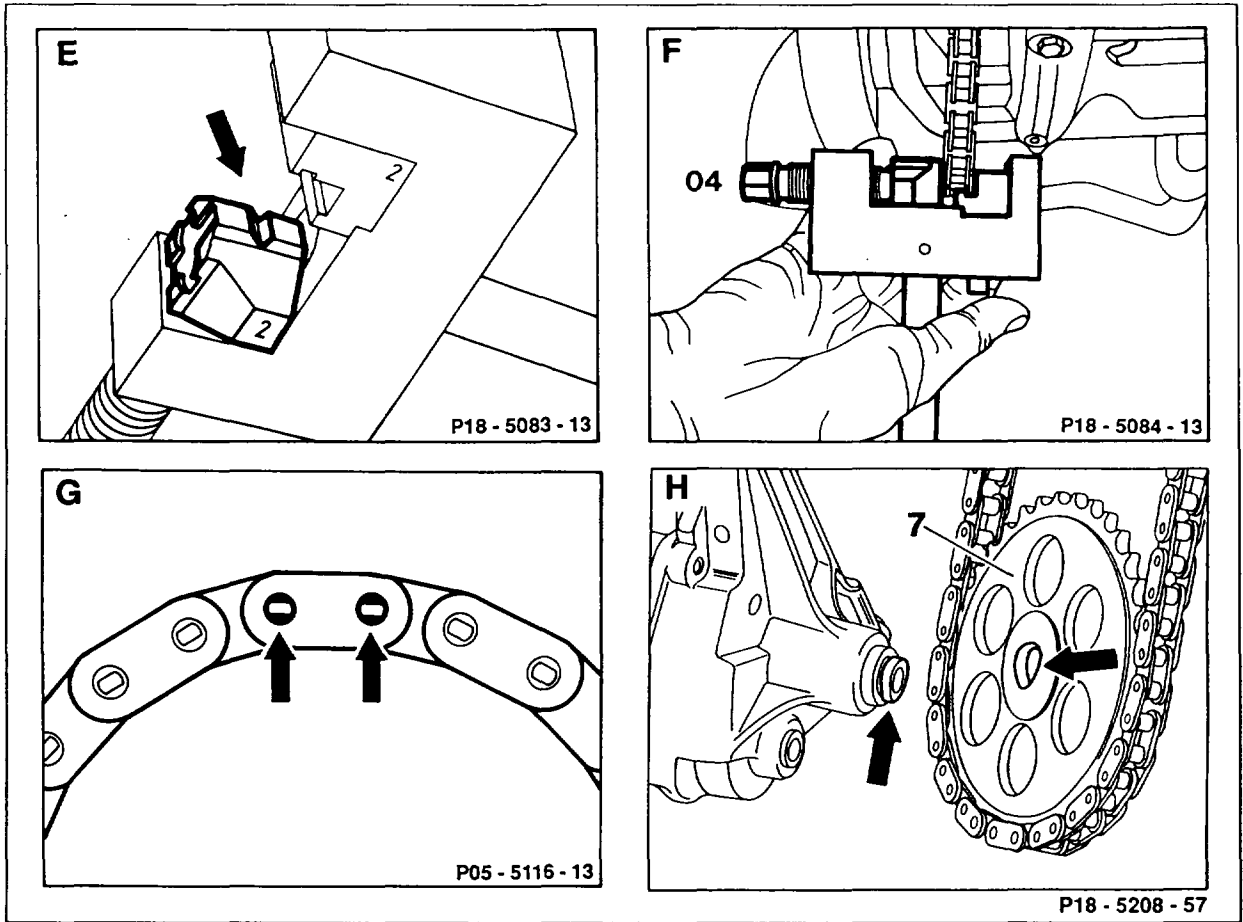

Moving thrust piece	turn over to riveting profile (arrow) (fig. E)
Fitting tool	position exactly over center of pin (fig. F)
Spindle (04)	tighten to 30 Nm (fig. F)
Pins of riveted link	rivet individually
Riveting	examine (arrows); re-rivet if necessary (fig. G)
Oil pump gear (7) with oil pump chain fitted	install with convex face toward oil pump (arrows), bolt on. Tightening torque 28 Nm (fig. H)

Special tools

