

## 05-2240 Adjusting basic position of camshaft

Preceding work:

Front cover removed (01-2120).

Basic position of camshaft checked (05-2230).

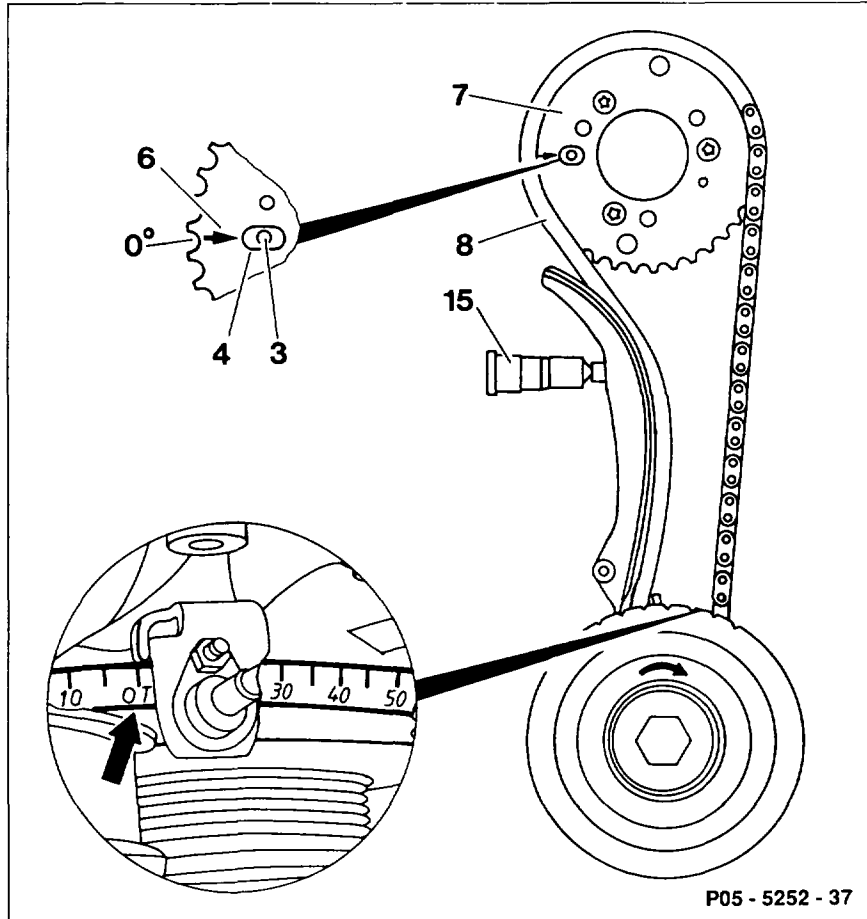

- |                            |   |
|----------------------------|---|
| Crankshaft .....           | rotate until TDC marking on vibration damper is aligned with TDC pointer (arrow).           |
| Crankshaft .....           | rotate to TDC of cylinder 1 with hexagon socket size 27 and torque wrench 000 589 10 99 01. |
| Chain tensioner (15) ..... | remove (05-3100).   |
| Timing chain (8) .....     | lift off camshaft sprocket (7).   |

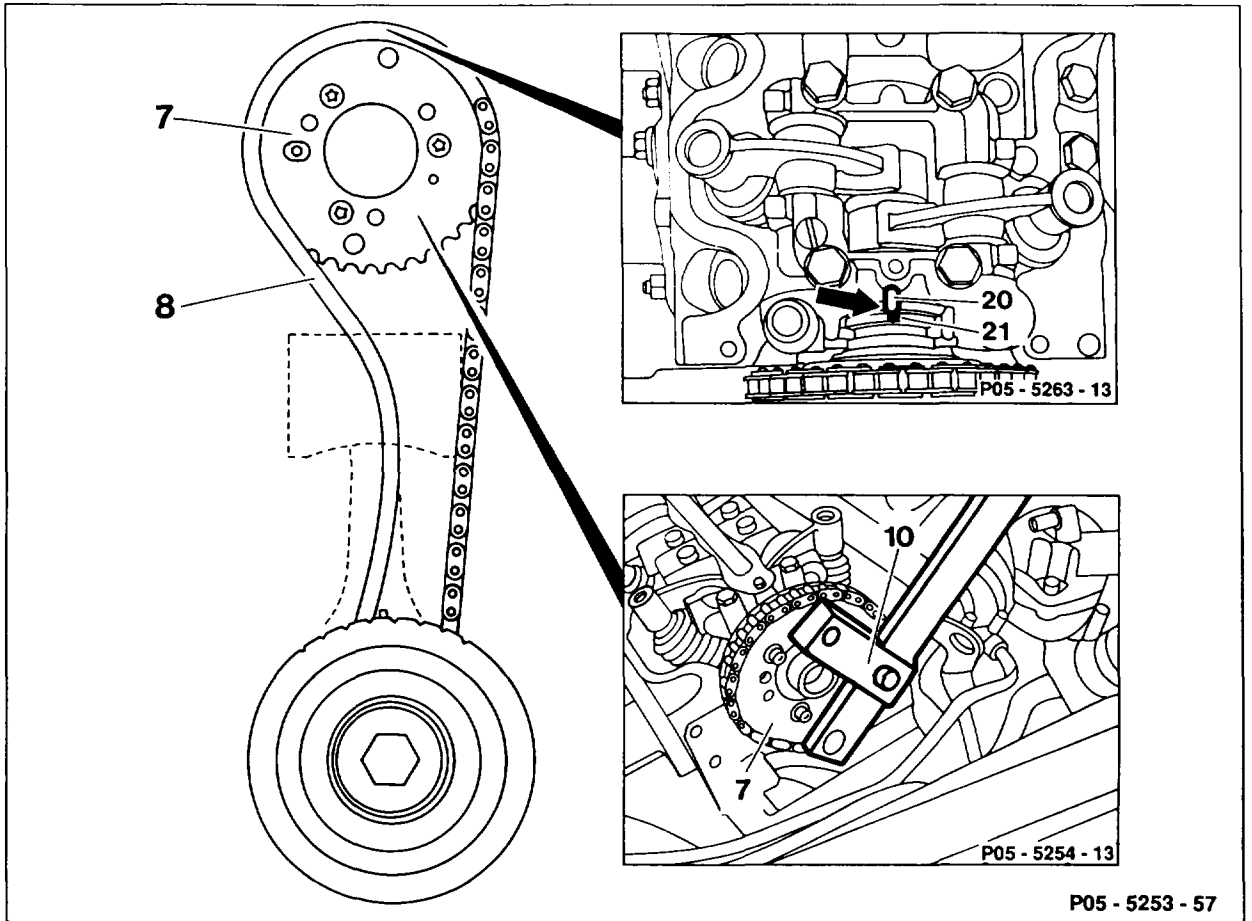

P05 - 5253 - 57

Camshaft sprocket (7) ..... rotate with wrench (10) 116 589 10 07 00 until setting hole (21) in the camshaft is matched with the cast marking (20) on first camshaft bearing bracket.



Ensure that the valves do not strike the piston crown when rotating the camshaft. Pay attention to note.

Chain tensioner ..... install (05-3100).

Crankshaft ..... rotate two revolutions in direction of rotation of engine. Check basic position of camshaft (05-2230).

## Special tools

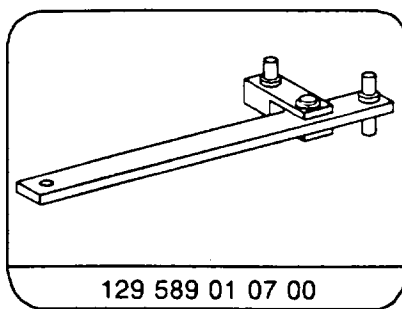
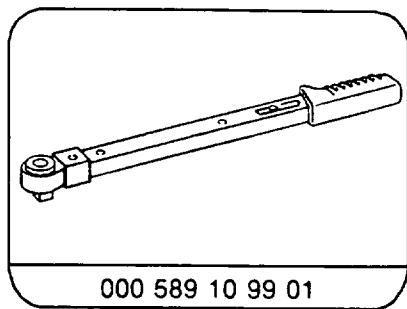

### Note

In crankshaft position 30° before TDC at cylinder 1, the camshaft can be rotated without the valves coming into contact with the piston.

