

W1	Main ground (behind instrument cluster)	B.3/3	12
W2	Ground (at right headlamp unit)	B.3/2	6
W3	Ground (left front wheelhousing at ignition coil)	B.3/2	9
W4	Ground (front dome lamp)	B.3/2	7
W6	Ground (left wheelhousing in trunk)		
	Sedan/ Coupé/ Cabriolet	B.3/1	5
	Station wagon	B.3/4	15
W7	Ground (right wheelhousing in trunk)		
	Sedan/ Coupé/ Cabriolet	B.3/1	2
	Station wagon	B.3/4	13
W8	Ground (tailgate terminal block)	B.3/4	14
W9	Ground (at left headlamp unit)	B.3/2	8
W10	Ground (battery)	B.3/1	1
W10/1	Ground (electronics)	B.3/3	13
W11	Ground (engine - connection point for ground wires)	B.3/1	3
W12	Ground (center console)	B.3/3	10
W13	Ground (rear window defroster)	B.3/3	11
W14	Ground (ABS hydraulic unit bracket)	B.3/1	4
W26	Ground (SRS control module)	B.3/2	10

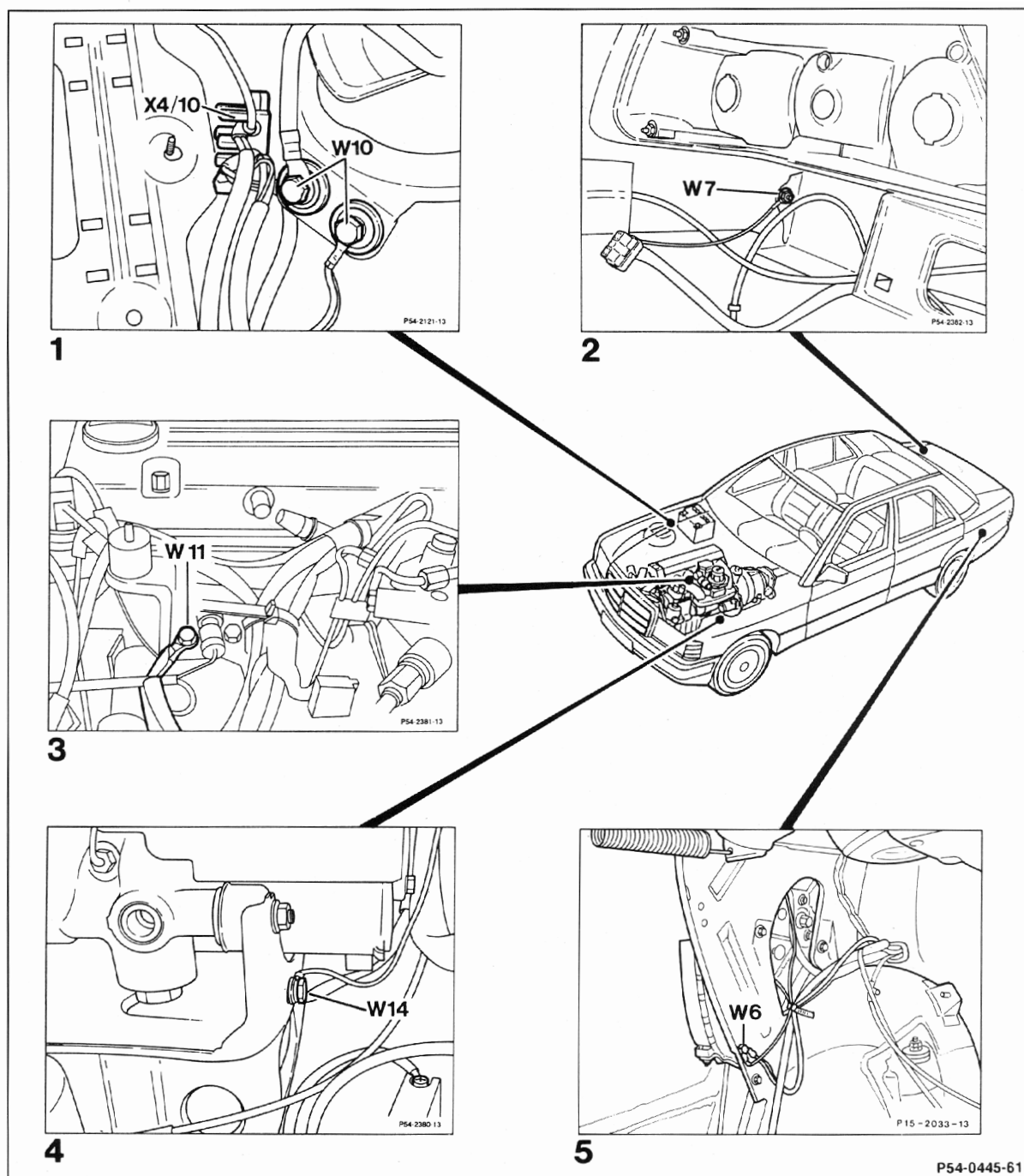

W6 Ground (left wheelhousing in trunk)
W7 Ground (right wheelhousing in trunk)
W10 Ground (battery)

W11 Ground (engine - connection point for ground wires)
W14 Ground (ABS hydraulic unit bracket)

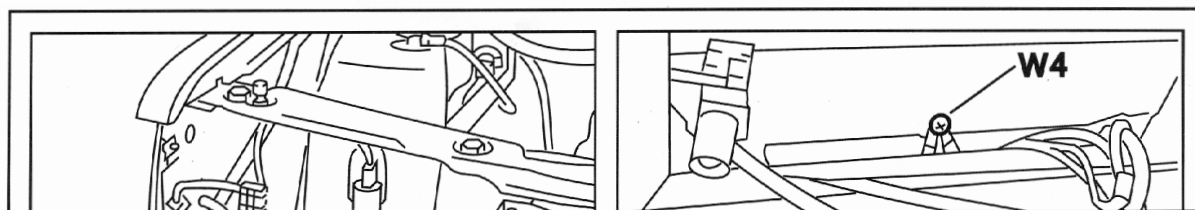

W2 Ground (at right headlamp unit)
W3 Ground (left front wheelhousing at
ignition coil)
W4 Ground (front dome lamp)

W9 Ground (at left headlamp unit)
W26 Ground (SRS control module)

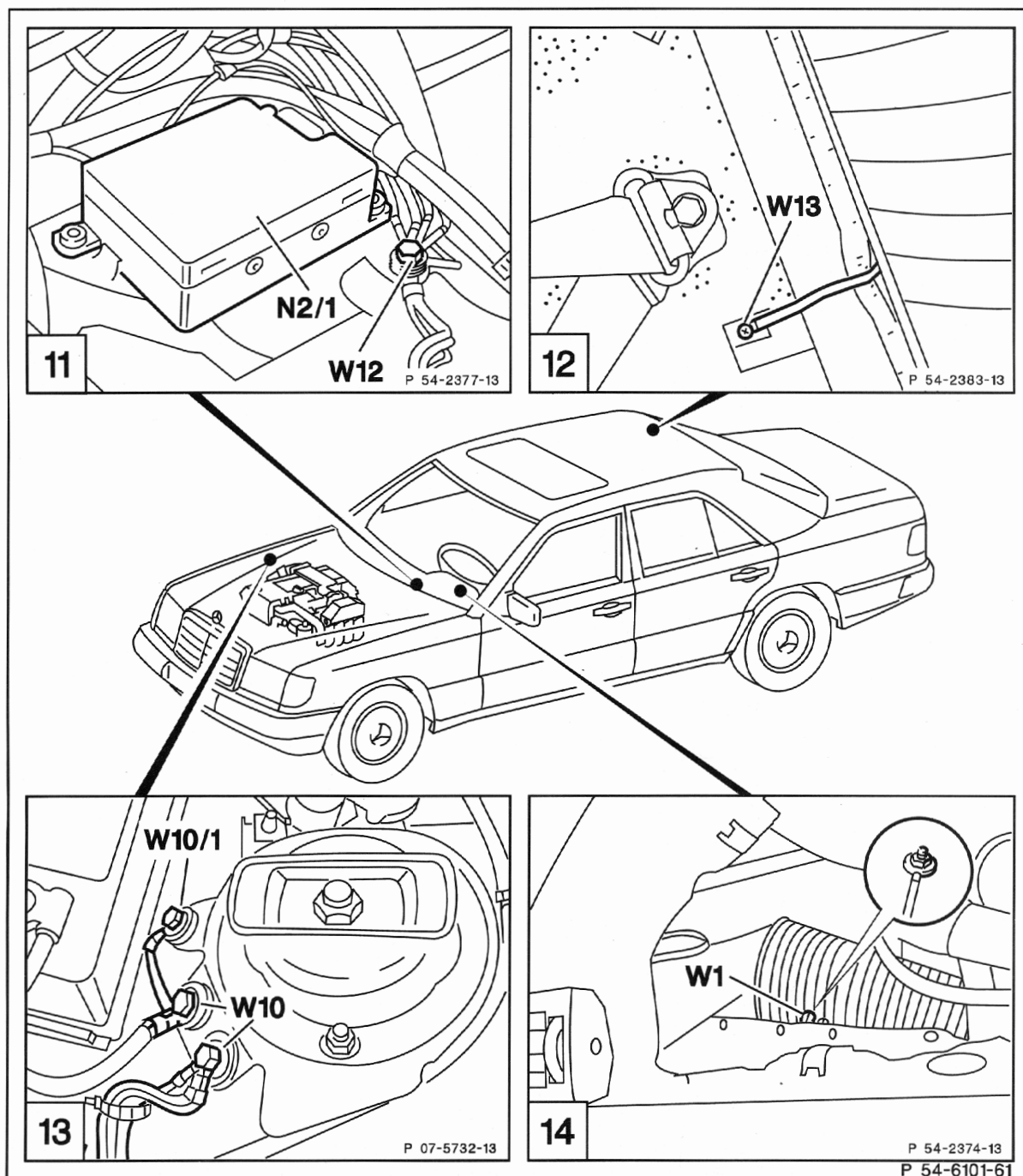

W1 Main ground (behind instrument cluster)
W10 Ground (battery)
W10/1 Ground (electronics)

W12 Ground (center console)
W13 Ground (rear window defroster)

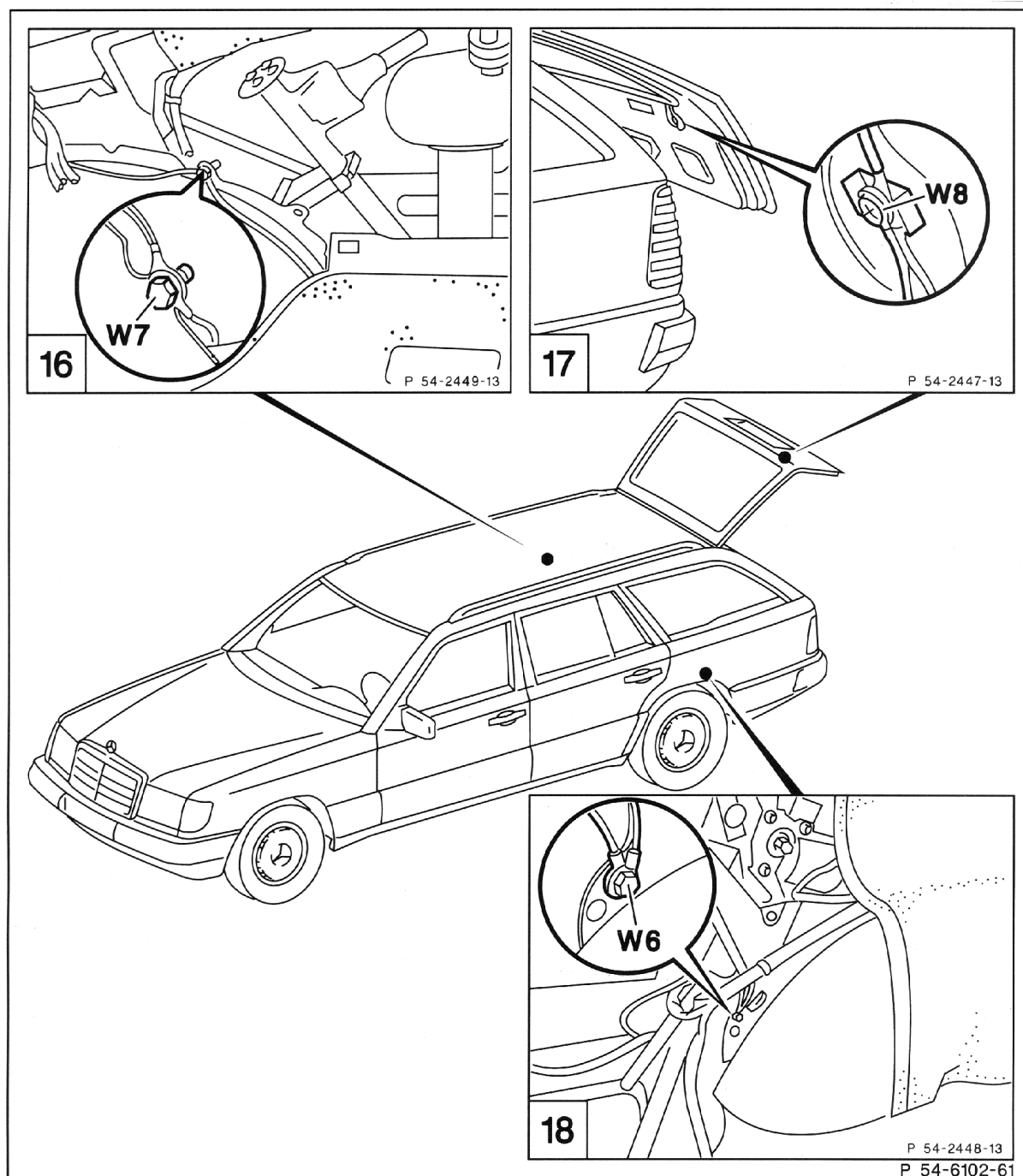

- W7 Ground (right wheelhousing in trunk)
- W6 Ground (left wheelhousing in trunk)
- W8 Ground (tailgate terminal block)